

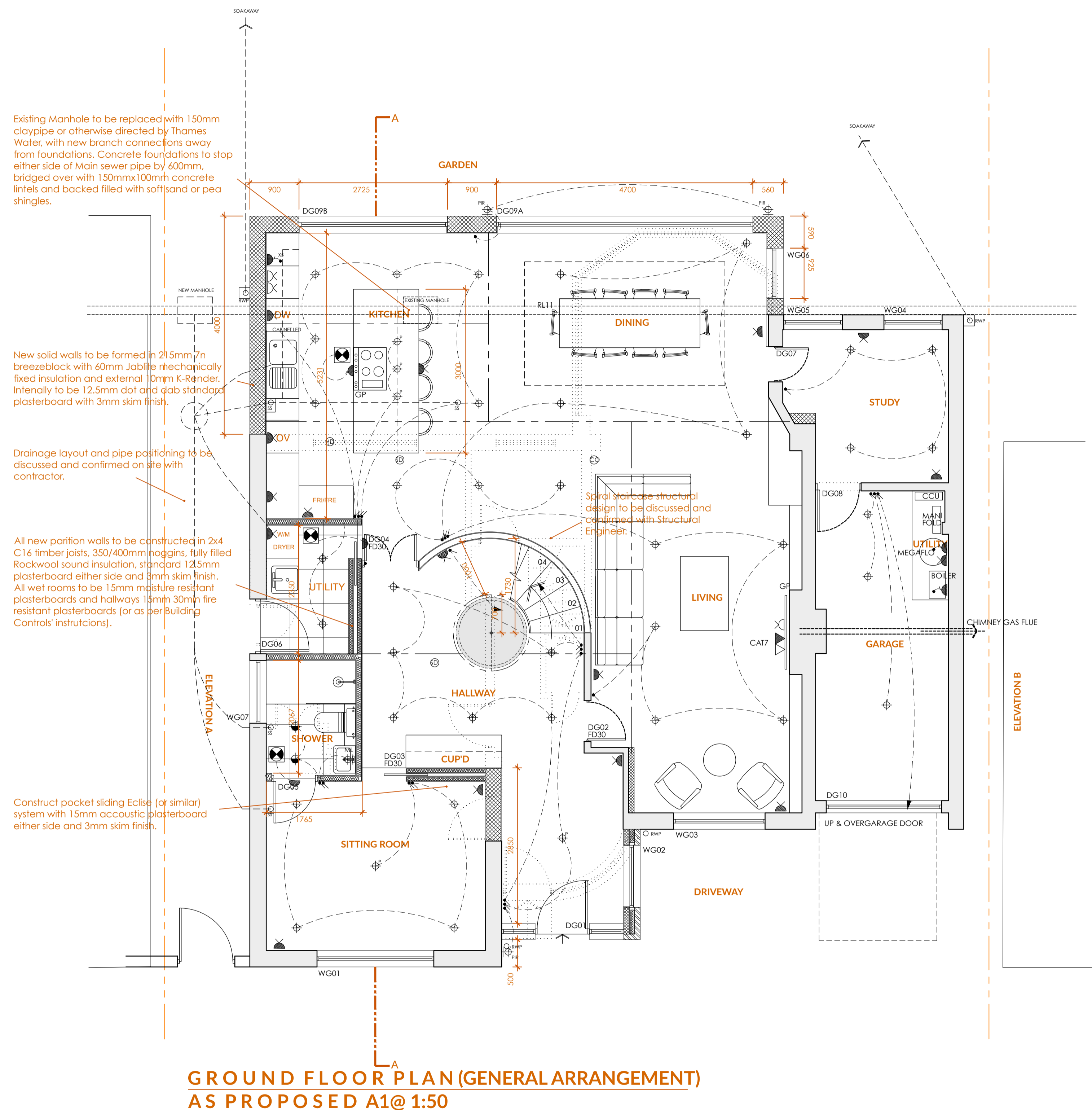

PROJECT: 240319
30 THE CHASE | PINNER
| HA5 1SN
CLIENT:
Frederic Cegla
PHASE:
WORKING
DATE:
APR 2024
SCALE:
A1@1:50

WDA1-01D
WINE CELLAR + GROUND FLOOR PLANS
(GENERAL ARRANGEMENT) AS PROPOSED

COMMENTS:
REVA_240424: Revised to suit client comments.
REVB_240425: Revised to suit clients comments
REVC_240424: New walls to be constructed as solid blockwork and insulated render externally
REVD_240510: Updated to suit clients comments.



<h3>ELECTRICAL LEGEND</h3>		<h3>ELECTRICAL LEGEND</h3>		<h3>ELECTRICAL LEGEND</h3>		<h3>ELECTRICAL LEGEND</h3>		<h3>ELECTRICAL LEGEND</h3>		<h3>ELECTRICAL LEGEND</h3>		<h3>ELECTRICAL LEGEND</h3>		<h3>ELECTRICAL LEGEND</h3>	
	DOUBLE SOCKET OUTLET		IMMERSION HEATER		COMBINED DATA + BT SOCKET		FIRE RESISTING LED RECESSED DOWNLIGHTER		HUMIDISTAT CONTROLLED EXTRACT FAN (15 L/SEC BATHROOM) (60 L/SEC KITCHEN)		RADIATOR		RADIATOR (WITHIN CASING)		ELECTRIC RADIATOR
	DOUBLE SOCKET OUTLET AT HIGH LEVEL		BOILER PROGRAMMER		SINGLE GANG LIGHT SWITCH		LOW VOLTAGE RECESSED DOWNLIGHTER IN F.R. SOCK		MAINS OPERATED AUTOMATIC SMOKE DETECTOR PERMANENTLY WIRED (MINIMUM 300MM AWAY FROM LIGHT FITTINGS & 1000MM AWAY FROM ANY PERIMETER WALL).		HEATED TOWEL RAIL (ELECTRIC)		GAS METER		WATER TAP
	DOUBLE SOCKET FLOOR BOX		THERMOSTAT CONTROL		DOUBLE GANG LIGHT SWITCH		MOISTURE RESISTANT LED VOLTAGE RECESSED DOWNLIGHTER		MAINS OPERATED AUTOMATIC HEAT DETECTOR PERMANENTLY WIRED (MINIMUM 300MM AWAY FROM LIGHT FITTINGS & 1000MM AWAY FROM ANY PERIMETER WALL).		STOP COCK		SOIL VENT PIPE		RAIN WATER PIPE
	5 AMP SOCKET OUTLET		BURGLAR ALARM KEY PAD		DIMMER LIGHT SWITCH		LOW VOLTAGE TRACK		COLD WATER BOOSTED MAINS SPRINKLER HEAD (SUGGESTED POSITION)		FRESH AIR INLET		COOKER PANEL		CUSTOMER CONSUMER UNIT
	5 AMP SOCKET FLOOR BOX		BURGLAR ALARM CONTROL PANEL		PULL CORD SWITCH		FLUORESCENT BATTEN LIGHT	NB: ALL LOW LEVEL SOCKETS TO BE POSITIONED 35MM ABOVE SKIRTINGS. ALL LIGHT SWITCH PLATES ARE TO BE AT (TBA) ABOVE FFL.							
	5 AMP SOCKET OUTLET AT HIGH LEVEL		BURGLAR ALARM SOUNDER		CHANDILLER LIGHT		DIRECTIONAL DOWNLIGHT IN JOINERY								
	DUAL VOLTAGE SHAVER SOCKET		PASSIVE INFRA-RED DETECTOR		PENDANT LIGHT		STRIP LIGHT LED IN JOINERY								
	SINGLE SOCKET OUTLET		PERSONAL ATTACK BUTTON		PENDANT LIGHT ON TIMER SWITCH		READING LIGHT								
	WATERPROOF EXTERNAL SOCKET		INTRUDER ALARM DOOR CONTACT		EXTERNAL WALL LIGHT (MOVEMENT DETECTOR)		RECESSED WALL LIGHT								
	SWITCHED FUSED SPUR AT HIGH LEVEL		SPEAKER POINT AT CEILING		MIRROR LIGHT		RECESSED FLOOR LIGHT								
	SWITCHED FUSED SPUR AT LOW LEVEL		HIGH LEVEL SPEAKER POSITION		WALL LIGHT		KITCHEN CUPBOARD LIGHTING								
	DOOR BELL PUSH		CABLE TV/FM AERIAL SOCKET		FLOOR LIGHT		EXTERNAL FLOOR LIGHTING								
	BELL SOUNDER		TWIN VERSATILE NETWORK POINT		DIRECTIONAL RECESSED DOWNLIGHTER		COOKER PANEL								
	ENTRY PHONE		TELEPHONE JACK SOCKET (MAIN)				CUSTOMER CONSUMER UNIT								
			TELEPHONE JACK SOCKET (EXTENSION)												

