

<b>Nigel Fallon, B.Sc. (Hons)MBEng. 07768-408525</b> Planning & Development Consultant, Building Engineer.		ADDRESS: 18, EVERSLEY CRESCENT, RUISLIP, HA4 6DD.	
349, Chartridge Lane, Chesham, HP5 2SH.	DRAWING TITLE: EXISTING FLOOR PLANS	NO. - 01	REV:
	SCALE - 1:100	DATE: 27/07/2021	DRG. PAPER SIZE: A3

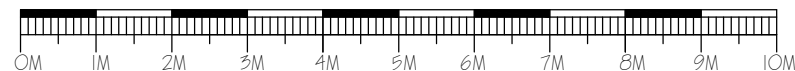

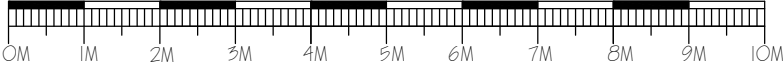

<b>Nigel Fallon, B.Sc. (Hons)MEng. 07768-408525</b> <i>Planning &amp; Development Consultant, Building Engineer.</i> <b>349, Chartridge Lane,</b> <b>Chesham, HP5 2SH.</b>		ADDRESS: 18, EVERSLEY CRESCENT, RUISLIP, HA4 6DD.	
		DRAWING TITLE: EXISTING/ PROPOSED ELEVATIONS	NO. - 02
SCALE - 1:100		DATE: 27 / 07 / 2021	REV:
		DRG. PAPER SIZE: A3	





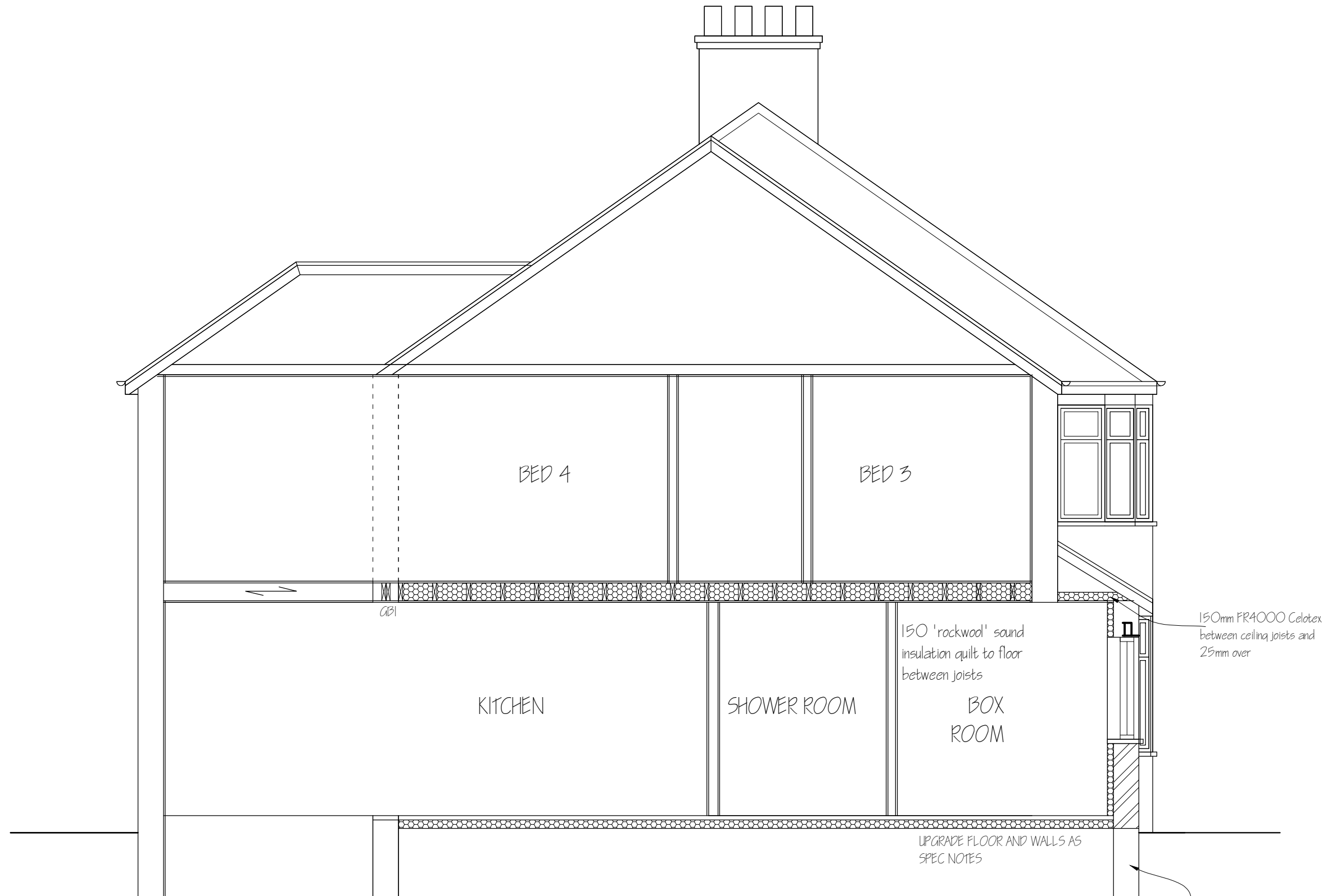

<b>Nigel Fallon, B.Sc. (Hons)MBEng. 07768-408525</b> <i>Planning &amp; Development Consultant, Building Engineer.</i> 349, Chartridge Lane, Chesham, HP5 2SH.		ADDRESS: 18, EVERSOLEY CRESCENT, RUISLIP, HA4 6DD.	
		NO. - 04	REV:
DRAWING TITLE: PROPOSED SECTION		DATE: 27/07/2021	
SCALE - 1: 50		ORG. PAPER SIZE: A3	

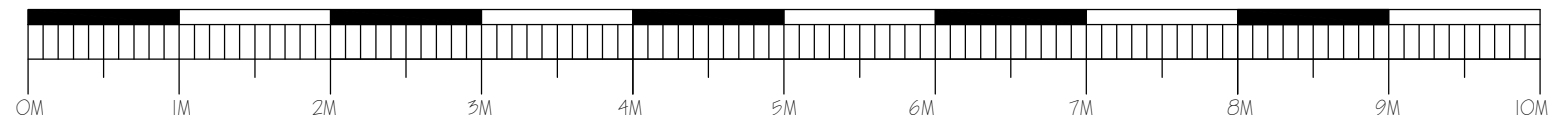

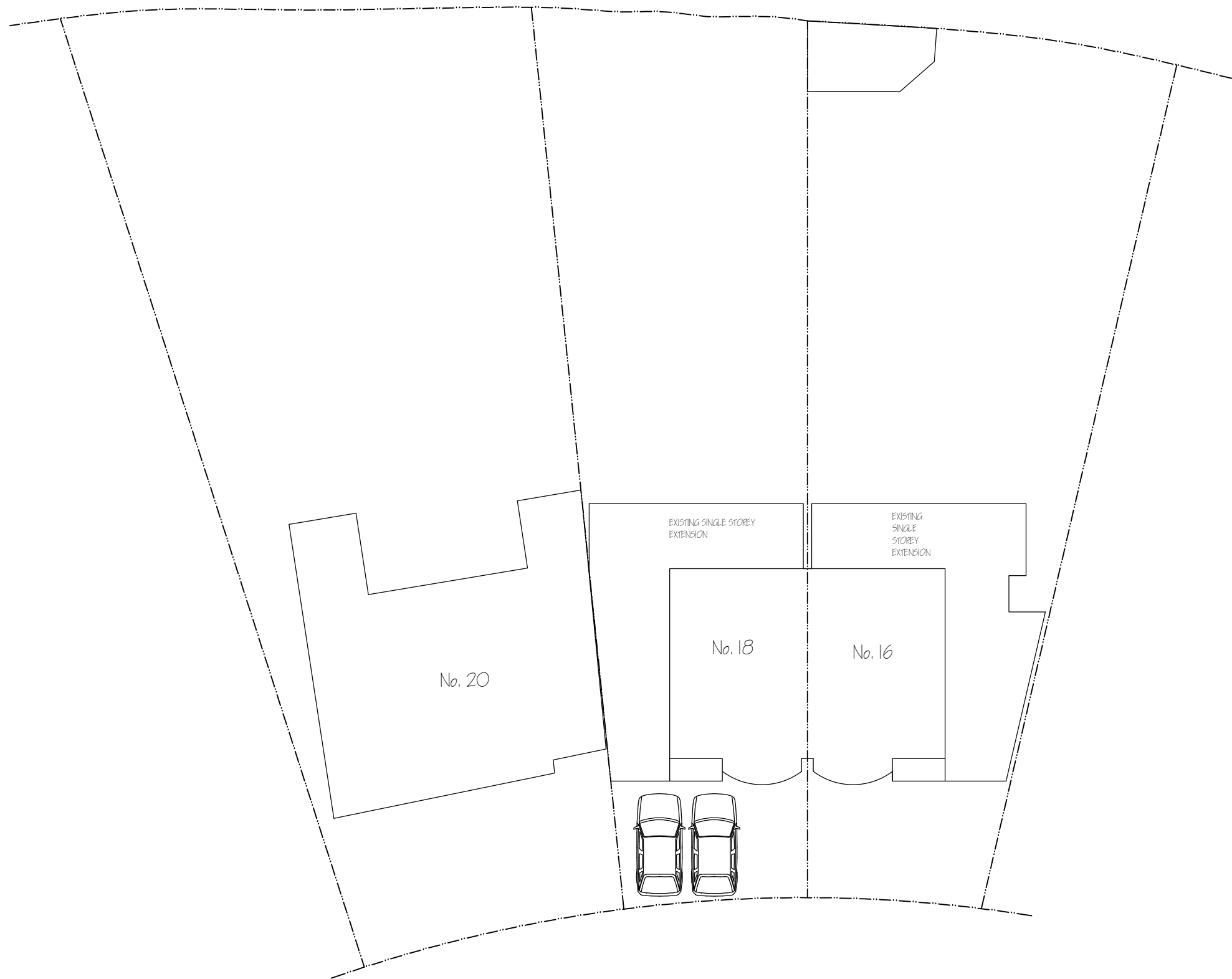

***Nigel Fallon, B.Sc. (Hons)MBEng. 07768-408525***

***Planning & Development Consultant, Building Engineer.***

***349, Chartridge Lane,  
Chesham, HP5 2SH.***

DRAWING TITLE: PROPOSED BLOCK PLAN

SCALE - 1: 200

DATE: 27 / 07 / 2021

ADDRESS:  
18, EVERLEY CRESCENT,  
RUISLIP, HA4 6DD.

NO. - 05

REV:

DRG. PAPER SIZE: A3

