

NOTES

ALL WORKS TO BE CARRIED OUT IN ACCORDANCE WITH CURRENT BUILDING REGULATIONS.

ALL DIMENSIONS / LEVELS TO BE CHECKED AND VERIFIED ON SITE BEFORE COMMENCING ANY WORK AND ANY DISCREPANCIES TO BE REPORTED TO THE OFFICE IMMEDIATELY.

THIS DRAWING TO BE READ IN CONJUNCTION WITH CONTRACT DOCUMENTS, PROJECT WORKING DRAWINGS, SPECIFICATION, ALL CONSULTANTS / SPECIALIST DRAWINGS, DETAILS AND SPECIFICATION.

ALL MATERIALS TO BE USED IN THE CONSTRUCTION OF THE EXTERNAL SURFACES OF THE NEW WORKS SHALL MATCH THOSE IN THE EXISTING BUILDING.

DO NOT SCALE FROM THIS DRAWING, ONLY FIGURED DIMENSIONS TO BE TAKEN EXCEPT FOR PLANNING PURPOSE

THIS DRAWING WHICH IS THE PROPERTY OF STAR DESIGN SOLUTIONS LTD IS THE SUBJECT OF INTELLECTUAL PROPERTY RIGHTS INCLUDING COPYRIGHT AND DESIGN RIGHT AND SHALL NOT BE REPRODUCED, COPIED, LOANED OR SUBMITTED TO ANY OTHER PARTY WITHOUT THE WRITTEN CONSENT OF STAR DESIGN SOLUTIONS LTD.

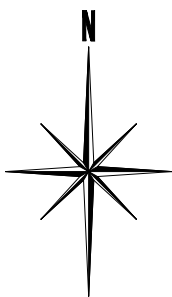

WE CANNOT GUARANTEE THE ACCURACY OF THIRD PARTY MAPPING AND OS EXTRACT DATA. USE IT FOR IDENTIFICATION AND PLANNING PURPOSES ONLY.

KEY

BOUNDARY

EXISTING

PROPOSED ROOF ALTERATION AREA

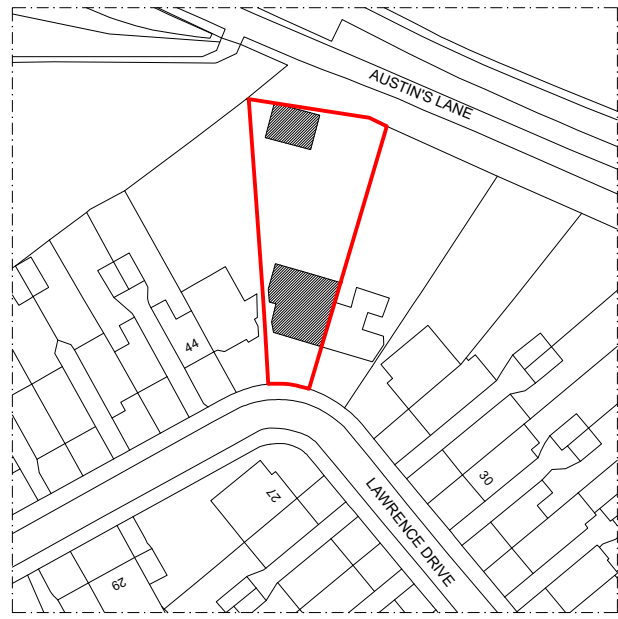

EXISTING LOCATION PLAN @ 1:1250

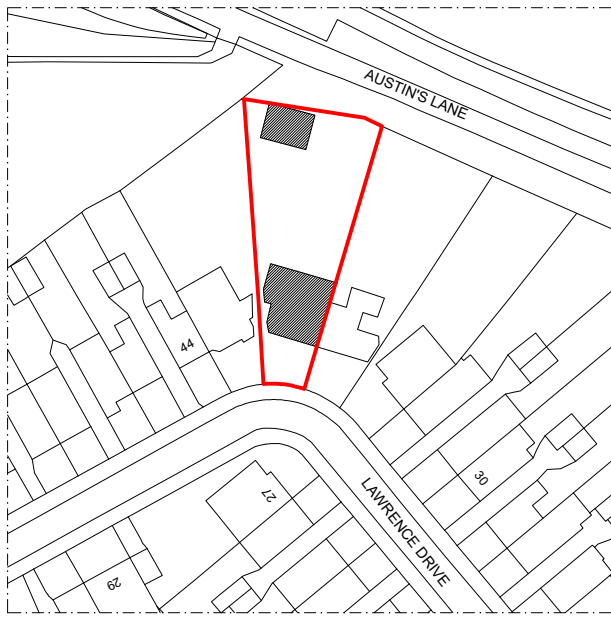

PROPOSED LOCATION PLAN @ 1:1250

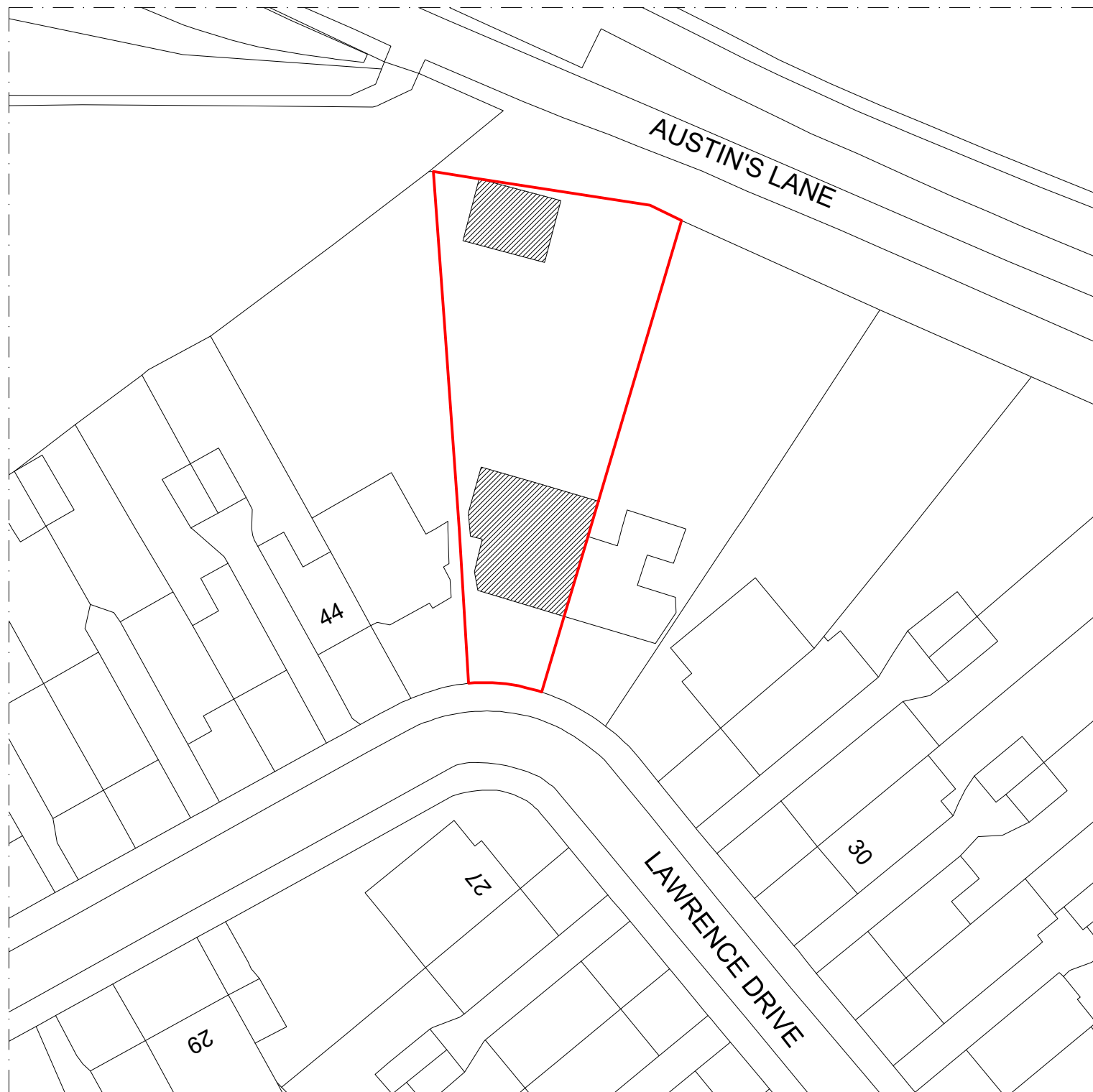

EXISTING BLOCK PLAN @ 1:500

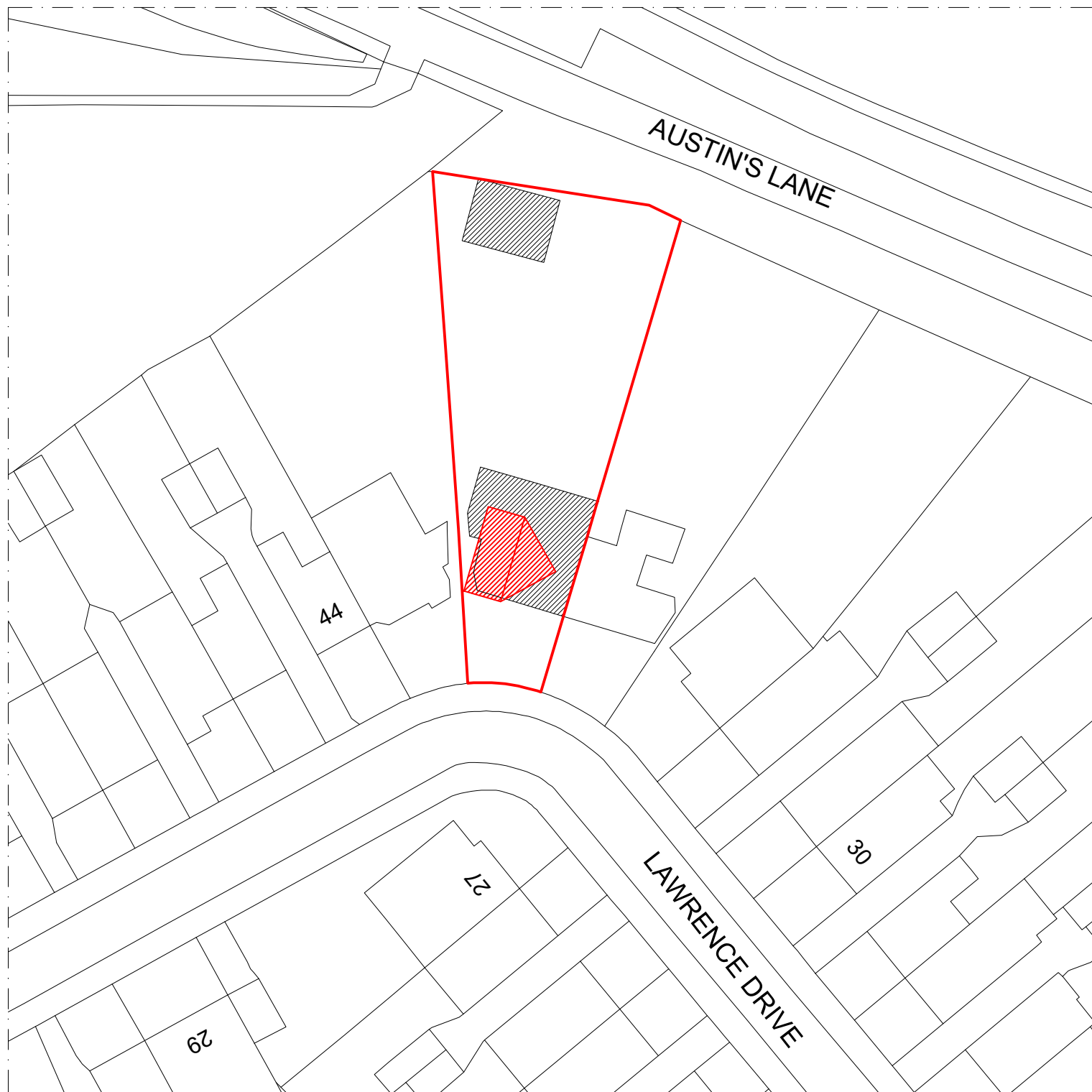

PROPOSED BLOCK PLAN @ 1:500

1:50  
@ A1

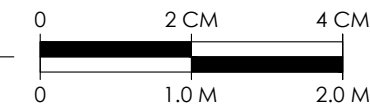

1:100  
@ A1

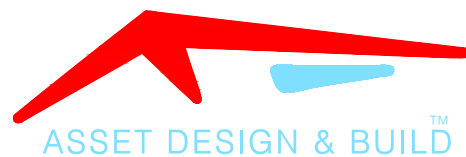
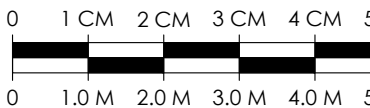

30 HIGH ST, HAREFIELD, UB9 6BU  
info@assetdesignandbuild.co.uk  
01753 825860

CLIENT: STEVEN DUNGEY

SITE: 40 LAWRENCE DRIVE, ICKENHAM, UB10 8RW

JOB TITLE: ROOF ALTERATION TO INSTALL SOLAR PANELS

DRAWING TITLE: LOCATION PLANS

SCALE: VARIOUS DATE: AUGUST 2024

JOB NUMBER:

DRAWING NUMBER: 01/01 DRAUGHTSMAN: SDS REV: B

COPYRIGHT RESERVED