

OUTSIDE ELEVATIONS - DO NOT SCALE

FIXING PROCEDURE FOR W20 WINDOWS:

- WINDOW FRAMES SHOULD BE REMOVED FROM THEIR CRATES AND CHECKED OFF AGAINST THE PACKING OR PARTS LIST BEFORE THEY ARE CAREFULLY STACKED ON WOODEN BATONS WITH PACKING SUCH AS CARDBOARD BETWEEN FRAMES. IF THE FRAMES ARE NOT TO BE STORED UNDER COVER THEY SHOULD BE COVERED WITH WATERPROOF SHEETING.
- SOME ANCILLARY COMPONENTS, SUCH AS DOOR HANDLES AND FIXINGS ETC ARE PACKED IN POLYTHENE BAGS OR CARDBOARD BOXES. CRATES SHOULD BE CHECKED TO ENSURE EVERYTHING HAS BEEN REMOVED BEFORE DISPOSAL.
- BEFORE COMMENCING INSTALLATION, OPENINGS SHOULD BE CHECKED TO ENSURE THEY ARE THE CORRECT SIZE. ANY COUPLED ASSEMBLIES SHOULD BE SET OUT, CHECKED FOR SQUARENESS OPERATION AND THAT THE FITTINGS OPERATE CORRECTLY.
- WHERE PRESSED METAL ITEMS ARE SPECIFIED, THESE MUST BE CENTRALISED IN THE OPENING AND CHECKED FOR LINE AND LEVEL BEFORE FIXING.
- WHEN FIXING COUPLED ASSEMBLIES, MULLION BAR POSITIONS MUST BE SET OUT PRIOR TO THE INSTALLATION OF THE WINDOW FRAMES. THIS ENSURES ANY VARIATION BETWEEN WINDOW UNIT SIZE AND THE OPENING SIZE IS EQUALIZED. POSITION MULLIONS ENSURING THEY ARE PLUMB IN BOTH PLANES.
- APPLY UNIVERSAL BEDDING COMPOUND TO THE PERIMETER OF FRAMES AND TO THE COUPLING BARS-ALTERNATIVELY, IF NO BEDDING COMPOUND IS SPECIFIED ENSURE ALL PERIMETER HOLES IN THE FRAME ARE SEALED WITH SILICONE, WITH PARTICULAR REGARD TO FIXED LIGHTS & THE HEAD BARS OF SASH FRAMES. NYLON WASHERS ARE USED AT THE SILL FIXINGS OF OPENING VENTS. ALSO ENSURE GLAZING BARS ARE SEALED AT FENESTRA JOINTS AND AT THEIR JUNCTION WITH THE FRAME PERIMETER. SEE DETAILS FOR SPECIFIC REQUIREMENTS. INSERT WINDOWS BETWEEN STRUCTURE AND MULLIONS, ENSURING HOLES IN THE WINDOW FRAME ALIGN WITH THOSE IN THE MULLION (WHERE APPLICABLE). SHIM TIGHT. CHECK FRAMES ARE POSITIONED FOR LINE LEVEL & PLUMB BEFORE BOLTING FRAMES AND MULLIONS LOOSELY TOGETHER. SECURE FRAMES TO STRUCTURE - BEFORE FULLY TIGHTENING SCREWS, MAKE FINAL CHECK FOR LINE LEVEL & PLUMB.
- 'HOLE IN THE WALL' WINDOWS SHOULD BE CENTRALISED IN THE OPENING. SHIM AS REQUIRED TO ENSURE WINDOW IS PLUM, LEVEL AND SQUARE AND SECURED TO THE STRUCTURE. EMBEDMENT OF SCREWS MUST BE A MINIMUM OF 25mm. DIFFERENT FIXINGS ARE USED FOR DIFFERING STRUCTURAL MATERIALS - WOODSCREWS INTO TIMBER, PLUGS AND WOODSCREWS INTO MASONRY/BRICKWORK, SELF TAPPING SCREWS INTO PRESSINGS AND MACHINE SCREWS INTO SOLID METAL. REFER TO INDIVIDUAL FIXING DETAILS FOR PRECISE SCREW REQUIREMENTS. TO ENSURE THE PRODUCT CONFORMS TO THE STRUCTURAL REQUIREMENTS OF THE SPECIFICATION, SHIM THICKNESS SHOULD NOT EXCEED 15 x FIXING DIAMETER. WHERE GAPS ARE IN EXCESS OF THIS, SOLID BLOCKING MUST BE USED.
- WHERE GLAZING BARS OCCUR IN ADJACENT FRAMES IT IS ESSENTIAL THAT THESE ARE CHECKED TO ENSURE THEY LINE THROUGH.
- PRIOR TO GLAZING, MAKE SURE THAT THE GLASS IS SQUARE AND FITS PROPERLY. ENSURE ALL SWarf AND DIRT IS REMOVED FROM THE GLAZING AREA BY WIPING WITH A CLEAN RAG. NOTE THAT GLAZING BEADS ARE ATTACHED TO THEIR PARTICULAR PANE AND ARE NOT INTERCHANGEABLE.
- REFER TO GLAZING DETAIL. APPLY GLAZING TAPE TO HEAD AND SILL FIRST, TAPE AT JAMBS SHOULD BUTT BETWEEN SEAL JOINT WITH COMPATIBLE SEALANT. ALL GLASS SHOULD BE BLOCKED IN ACCORDANCE WITH BS6262- SEE ILLUSTRATION. POSITION GLASS CENTRALLY IN FRAME AND PRESS FIRMLY ONTO THE GLAZING TAPE. IT IS ESSENTIAL TO 'TOE AND HEEL' ALL SIDE HINGED WINDOWS AND DOORS. APPLY STUDS FOR SNAP-ON BEADS.
- APPLY HEAD AND SILL BEADS, ENSURING THEY ARE CENTRALISED IN THE REBATE. APPLY JAMB BEADS, CENTRALISING BETWEEN HORIZONTALS. ANY GAPS AT THE CORNERS SHOULD BE EQUALISED AROUND THE FRAME, WITH THE MAXIMUM ALLOWABLE GAP SPECIFIED IN BS 6510:2005 OF 3mm.
- APPLY SILICONE CAPPING, AS SHOWN ON THE GLAZING DETAIL.
- PERIMETER AND COUPLING POINTING CAN NOW BE CARRIED OUT. CLEAN AREAS TO BE SEALED FIRST AND APPLY PRIMER WHERE NECESSARY - CONSULT SEALANT MANUFACTURER.
- LOOSE FITTINGS, IE DOOR HANDLES, WEATHER BARS ETC. CAN NOW BE FITTED.
- REMOVE LABELS FROM GLASS AND CLEAN DOWN.

IMPORTANT:

THESE DRAWINGS COVER ONLY THE WORK IN CRITTALL WINDOWS LIMITED CONTRACT. WE DO NOT ASSUME OR ACCEPT ANY RESPONSIBILITY FOR MEASUREMENTS AFFECTING THE WORK OF OTHER CONTRACTORS. DETAILS OF MASONRY, STRUCTURAL STEEL AND OTHER MATERIALS RELATED TO OUR WORK BUT NOT FURNISHED BY CRITTALL WINDOWS LIMITED HAVE BEEN INDICATED ON OUR SHOP DRAWINGS TO THE BEST OF OUR ABILITY AND REFLECT OUR INTERPRETATION OF THE ARCHITECTURAL DRAWINGS AND OUR CONTRACT REQUIREMENTS. TO ENSURE PROPER FITTING AND COORDINATION OF OUR WORK WITH OTHER TRADES, THESE DRAWINGS MUST BE CHECKED BY THE CONTRACTOR AND/OR ARCHITECT AGAINST INFORMATION PROVIDED BY SUPPLIERS OF OTHER MATERIALS THAT RELATE TO OUR WORK, BUT WHICH ARE NOT FURNISHED BY CRITTALL WINDOWS LIMITED.

RECOMMENDED POSITIONS OF SETTING & LOCATION BLOCKS FOR THE SITE GLAZING OF SOME TYPES OF SURROUNDS

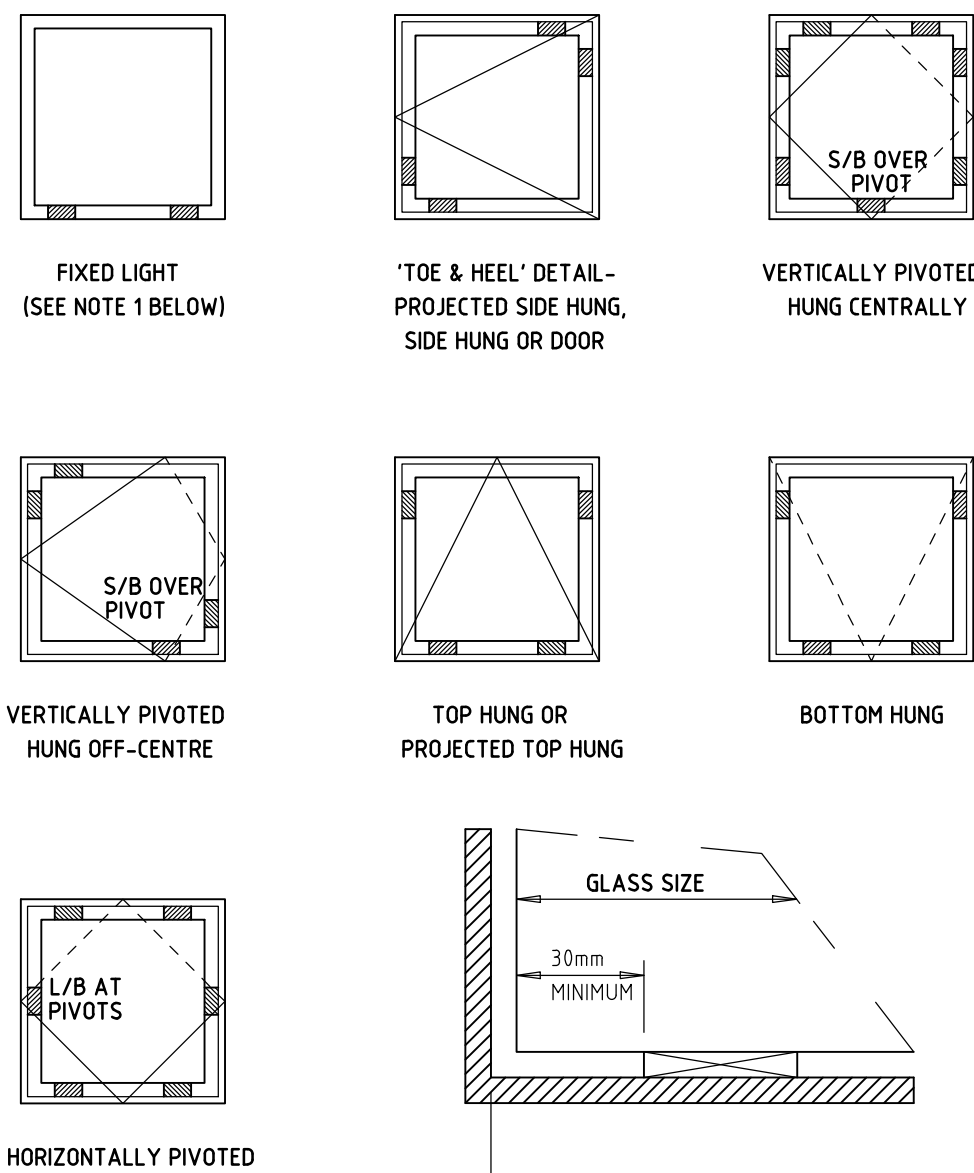

NOTE 1. SETTING BLOCKS FOR FIXED LIGHTS SHOULD PREFERABLY BE AT THE QUARTER POINTS, BUT CAN BE POSITIONED AS SHOWN ABOVE IF NECESSARY.

NOTE 2. FOR DESIGNS WHERE THE ACTUAL POSITIONS ARE CRITICAL, BLOCK POSITIONS WILL BE STATED ON THE RELEVANT DRAWINGS.

W20 14mm EXTERNAL GLAZED SECTION (C.O.P.) GLAZING DETAIL (2:1 SCALE)

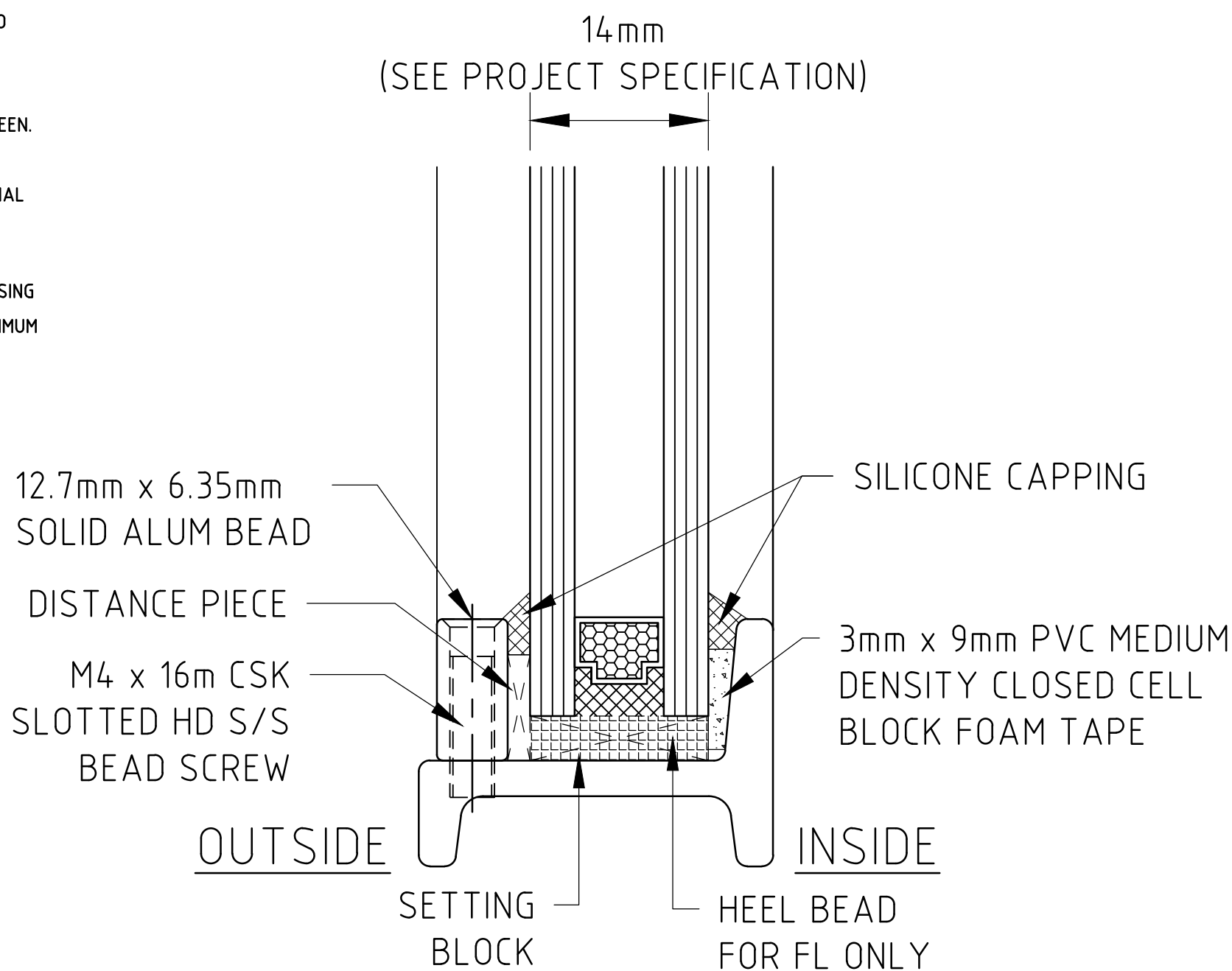

- ARRANGE SETTING BLOCKS IN ACCORDANCE WITH BS 6262
- APPLY FOAM TAPE TO THE GLAZING NIB AS PER STANDARD GLAZING INSTRUCTIONS
- POSITION THE GLASS UNIT ONTO THE SETTING BLOCKS AND PRESS FIRMLY ONTO THE GLAZING TAPE
- ARRANGE LOCATION BLOCKS IN ACCORDANCE WITH BS 6262
- RUN 2 OR 3 LINES OF SILICONE UNDER THE GLASS, AROUND THE SETTING BLOCKS AND UP THE FACE OF THE GLASS AROUND 9mm AS SHOWN. ENSURING THAT THE GLAZING POCKET IS WELL PACKED WITH SILICONE
- SNAP THE BEAD OVER THE STUDS AND SILICONE CAP INSIDE AND OUT IN THE USUAL WAY. TIGHT BEADS ARE TO BE FILED TO FIT ON SITE. USE SPACERS AT BEAD JUNCTIONS TO ENSURE BEAD CORNERS ARE FLUSH

SPECIFICATION:

SECTION- - HOT ROLLED STEEL W20 SECTION FIXED LIGHTS CURVED-ON-PLAN (C.O.P.) ITEMS ALL AS SHOWN AS GLAZE OUT SECTION FEATURING GENUINE STEEL GLAZING BARS
PRESSED METAL - N/A

FINISH - RAL COLOUR BS08B29 VAN DYKE BROWN (TBC) IN MATT FINISH (30% +/- 5%)

GLASS/GLAZING- - GLAZING BY CWL TO BE 14mm DGU WITH SOLID ALUM BEAD FOR C.O.P. COMPRISING:

GL4 - 14mm CLEAR TOUGHENED (CURVE ON PLAN EST. ITEM 15)
4mm TOUGHENED PK HARDCOAT OUTER
6mm KRYPTON FILLED CAVITY WITH BLACK SPACER
4mm TOUGHENED CLEAR INNER

NOTE: GLAZING TO BE HEEL BEADED ALL ROUND FRAME

DOUBLE GLAZED UNITS TO HAVE A MAXIMUM CENTRE PANE "U" VALUE OF 12 W/m²/K COMPLIANT WITH APPROVED DOCUMENT PART L.

FITTINGS- - N/A (C.O.P. FIXED FRAMES)

FIXINGS- - BY CRITTALL WINDOWS LIMITED

WIND LOAD- - 1200 N/m²

POINTING (& COLOUR)- - ARBOSIL 1096 BY CRITTALL WINDOWS LIMITED - OR
- ARBOSIL XL1099 WITH 2650 PRIMER TO STONEWORK
COLOUR TO BE CONFIRMED BY CLIENT

CRITTALL WINDOWS Ltd TO:
SURVEY, MANUFACTURE, DELIVER, FIX & GLAZE
REMOVE EXISTING WINDOWS & DOORS
(DISPOSAL & SKIPS BY OTHERS)

W20 16mm INTERNAL GLAZED BULLSEYE GLAZING DETAIL (2:1 SCALE)

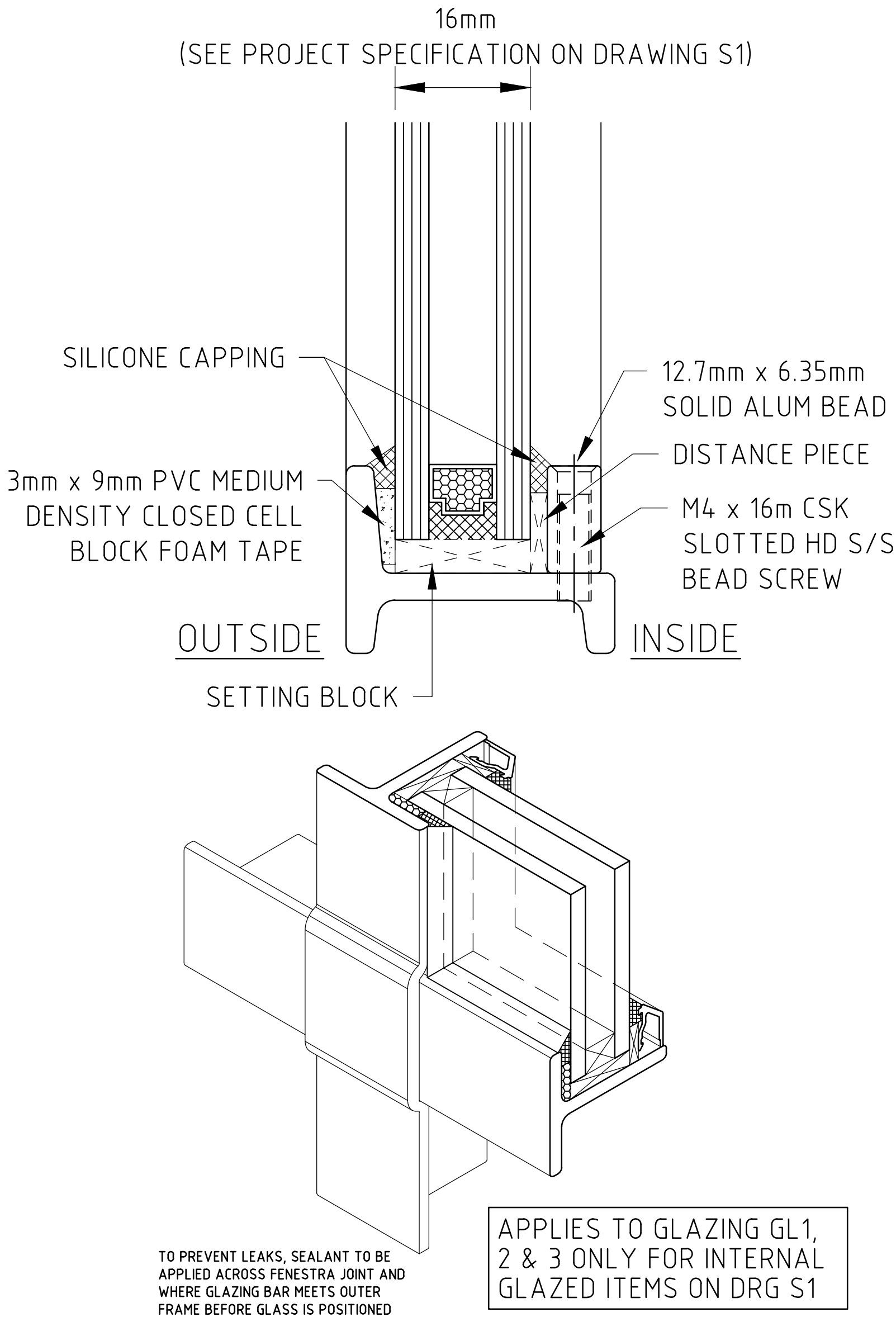







TYPICAL ISOMETRIC OF FENESTRA JOINT
VIEWED FROM FENESTRA SIDE

APPLIES TO GLAZING GL1,
2 & 3 ONLY FOR INTERNAL
GLAZED ITEMS ON DRG S1

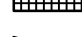
SPECIFICATION (FOR INTERNAL USE ONLY):

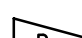
ISSUED FOR APPROVAL

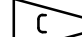
* DETAILER'S SIGNATURE AUTHORISES RELEASE FOR PRODUCTION/INSTALLATION

LEGEND:		EXTERNAL POINTING BY CRITTALL/OTHERS
		— — — PLUGS BY CRITTALL HOLES BY GENERAL CONTRACTOR/CRITTALL
		POLYURETHANE FOAM INFILL BY CRITTALL
		POLYURETHANE FOAM/WATERPROOF INFILL NOT WITHIN CRITTALL SCOPE OF WORKS
		BRICKWORK ETC TO BE FLUSH-POINTED 12mm FORWARD OF EXTERNAL FACE OF WINDOWS
		DETAIL NUMBER
		DRAWING NUMBER

TOLERANCES: OUR PRICES ARE BASED UPON OPENINGS FOR WINDOWS BEING SUFFICIENTLY ACCURATE IN SIZE, POSITION, SQUARENESS AND STRAIGHTNESS TO ENABLE WINDOWS TO BE FIXED WITH A NOMINAL AND CONSISTENT CLEARANCE BETWEEN WINDOWS, FIXING BRACKETS AND STRUCTURE. THIS CLEARANCE DIMENSION MAY VARY, DEPENDING UPON SEALANT JOINT STRUCTURE.

BI-METALLIC CORROSION: THE CONTENT OF THESE DRAWINGS HAVE TAKEN INTO CONSIDERATION BI-METALLIC CORROSION (GALVANIC ACTION) EFFECTS FOR THE MATERIALS USED THEREIN, BY FOLLOWING THE ADVICE GIVEN IN PD 6484:1979, PUBLISHED BY BSI

VARIATIONS TO CONTRACT: FINAL APPROVAL OF THIS DRAWING BY THE SPECIFIER WILL BE DEEMED AS ACCEPTANCE OF PAYMENT LIABILITY FOR ANY TIME AND/OR COST VARIATION TO THE CONTRACT

THIS DRAWING IS THE PROPERTY OF CRITTALL WINDOWS LIMITED. IT IS A CONFIDENTIAL DOCUMENT AND MUST NOT BE COPIED, USED OR ITS CONTENTS DIVULGED WITHOUT PRIOR WRITTEN CONSENT

© CRITTALL WINDOWS LTD.

REVISION	REVISION TO ESTIMATE	BY	DATE
P01	1ST ISSUE FOR APPROVAL	HS	08.12.23
REVISION	REVISION TO DRAWING	BY	DATE

CRITTALL® IS A REGISTERED TRADE MARK OF CRITTALL WINDOWS LTD			
TITLE MIDDLESEX SUITE, LONDON BOROUGH OF HILLINGDON, CIVIC CENTRE, HIGH STREET, UXBRIDGE, UB8 1UW			
CONTRACTOR GREYLINE, UNIT 2-3, 29 FOURTH WAY, WEMBLEY, HA9 0LH			
ARCHITECT ALLEN CONSTRUCTION CONSULTANCY, 6TH FLOOR EQUIPOINT, 1506-1508 COVENTRY ROAD, SWAN YARDLEY, BIRMINGHAM, B25 8AD			
DRAWN	HSIMPSON	DATE	NOVEMBER 2023
		SCALE AT A1 NTS	
DRAWING NUMBER		SHEET NUMBER	
9823G2B		S2	
REVISION NUMBER			
DDO ISSUE NUMBER			
DETAILED BY		DATE	DIST
FINISH			