

Plan form reduced by 3.0 in length following advice from the Local Planning Authority
(Dashed line denotes refused applications 14387/APP/2020/2775 & 2776)

- Late C18th Fabric
- Various Construction Phases to Late C20th
- Proposed New Dining Hall/Barn

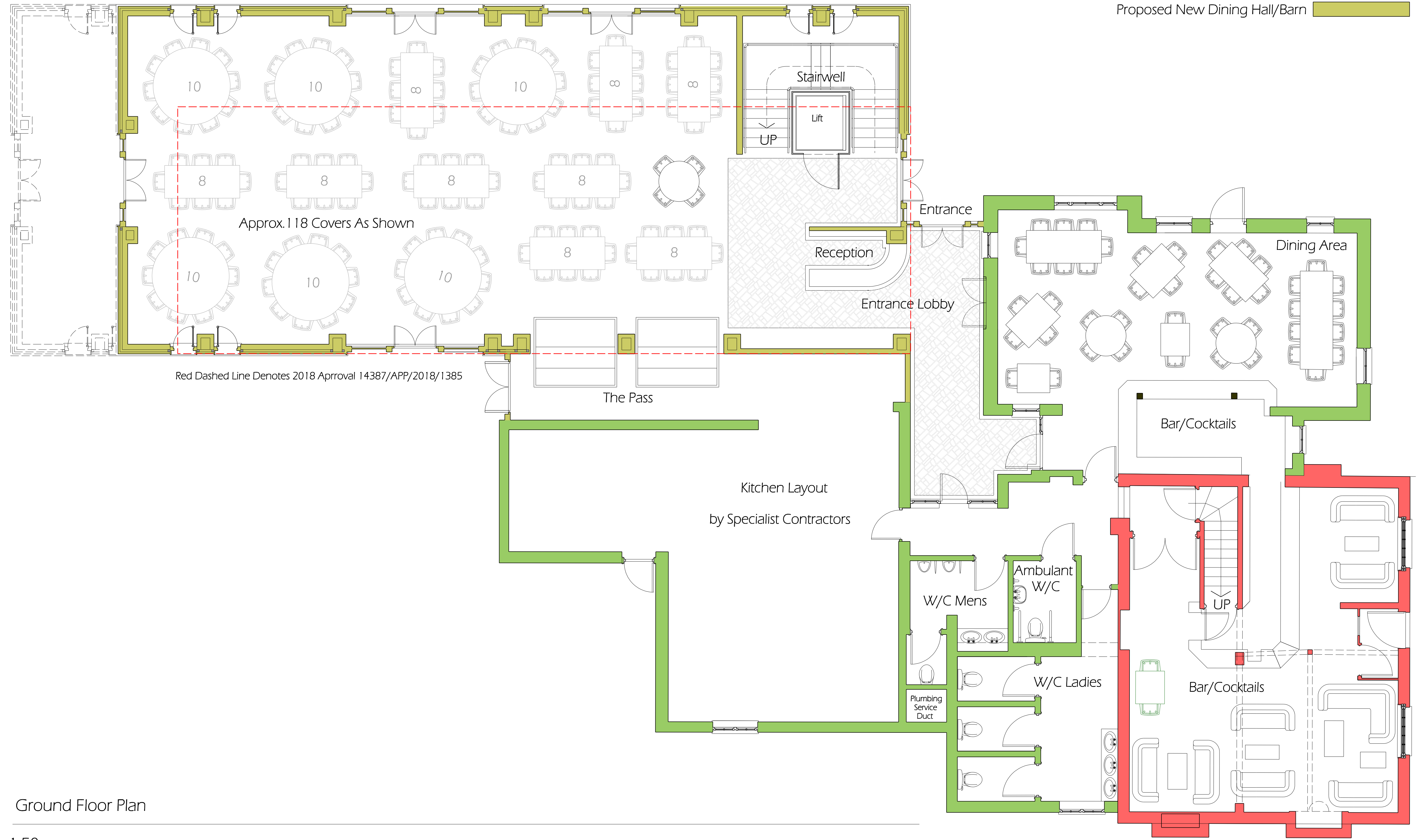

Ground Floor Plan

1:50

Rev.: G	Description: Dwg re-issued as Rev G to identify new planning submission date. Dwg is identical to Dwg submitted for App 14387/APP/2020 4126 & 4128	Date: 30/08/2023	Drawing Title: Ground Floor Plans	Project: Duck Hill Road	As Proposed Restaurant Extension	Do not rely upon dimensions scaled from this drawing for construction purposes Any discrepancies must be reported to the Architect as soon as possible The contents of this drawing remain the copyright of Vernon Smith and Associates Tel: 01234 708630	VERNONSMITH Associates Croot's Barn 103 High Street Riseley Bedfordshire MK44 1DF
			Project Ref.: VSA18/04	Scale: 1:50 @ A1	Drawing No. VSA20/11 - 007G		
			Date: 27/02/2018	Drawn: MVS			