

Plan form reduced by 3.0 in length following advice from the Local Planning Authority
(Dashed line denotes refused applications 14387/APP/2020/2775 & 2776)

- Late C18th Fabric
- Various Construction Phases to Late C20th
- Proposed New Dining Hall/Barn

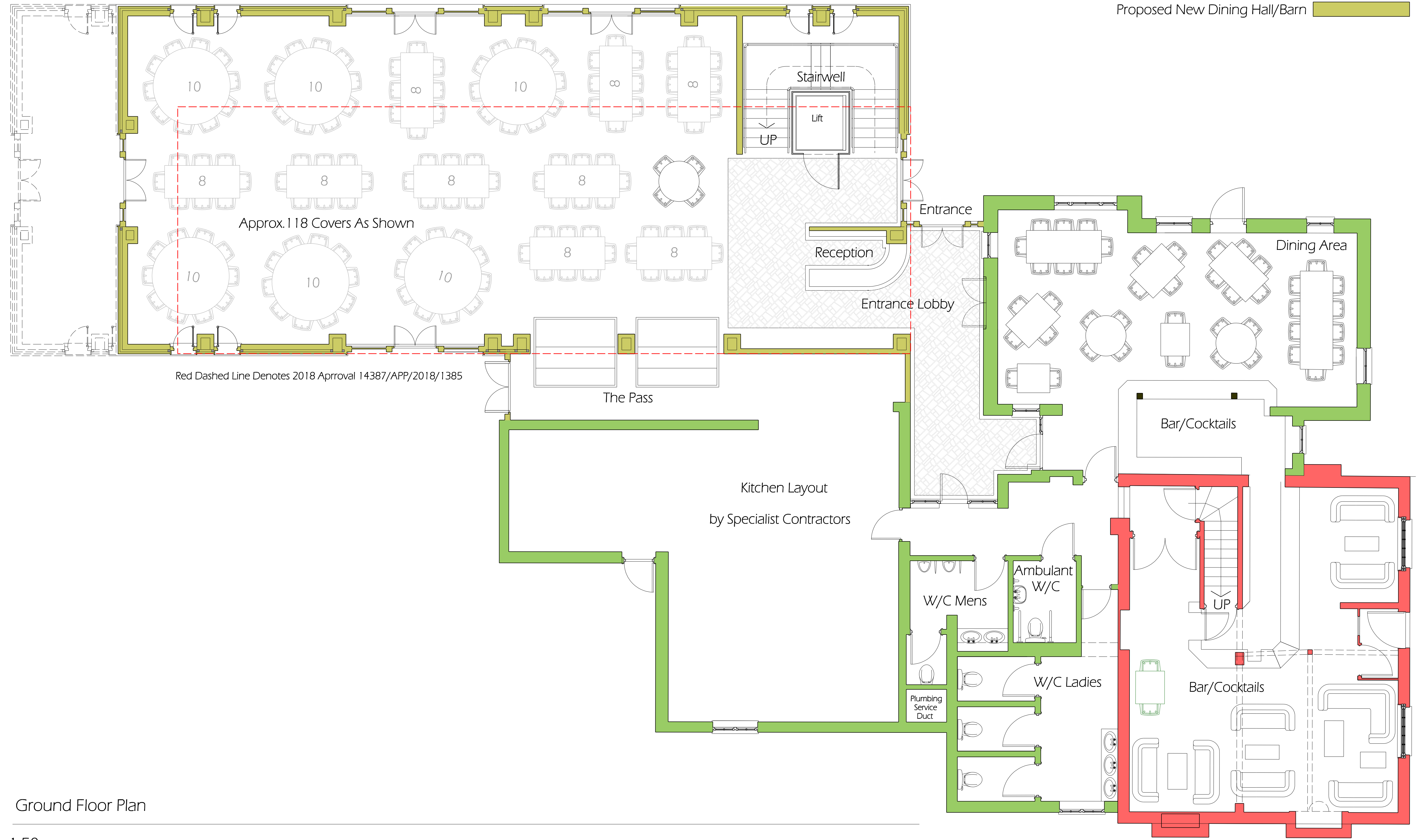

Ground Floor Plan

1:50

Rev.:	Description:	Date:	Drawing Title:	Ground Floor Plans	As Proposed	Do not rely upon dimensions scaled from this drawing for construction purposes	VERNONSMITH Associates
			Project:	Duck Hill Road	Restaurant Extension	Any discrepancies must be reported to the Architect as soon as possible	Croot's Barn
			Project Ref.:	VSA18/04		The contents of this drawing remain the copyright of Vernon Smith and Associates	103 High Street
			Scale:	1:50 @ A1			Riseley
			Date:	27/02/2018	Drawn: MVS	Tel: 01234 708630	Bedfordshire MK44 1DF
					Drawing No.: VSA20/11 - 007		