

- Existing concrete facade
- Aluminium window (L10/325)
- PPC metal sill (L10/325)
- Existing spandrel panel
- Render finish to match retained facade (C42/305)

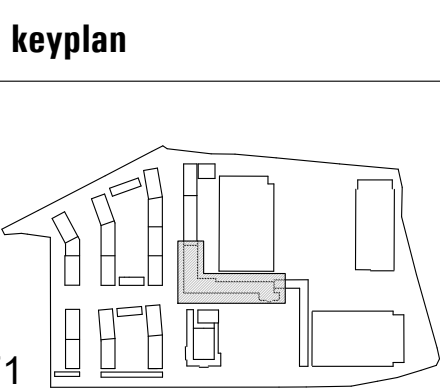

DMFK Architects Ltd take no responsibility for dimensions obtained by scaling from this drawing. If no dimension is shown the recipient must ascertain the dimension specifically from the architect or by site measurement and may not rely on the drawing. Supply of the drawing in digital form is solely for convenience and no reliance may be placed on any data in digital form. All data must be checked against hard copy. This drawing is issued for design intent only and should not be used for construction unless stated.

copyright
This drawing is the property of dMFK Architects Ltd. No disclosure or copy of it may be made without the written permission of dMFK Architects Ltd.

scale at A0	scale at A2	project	project no.	client	drawing title	revision
1 : 20	1 : 20	Former Nestlé Factory	2126	Barratt London	Bay Study 05 - East elevation (adjoining façade with segro)	D
drawn by LK	checked by JW				drawing no. 2126-A-F1-dMFK-DR- 21-504	

date	rev	revisions
30.08.23	D	S96 Addendum

dMFK
DE METZ FORBES KNIGHT ARCHITECTS

the old library 119 cholmley gardens london nw6 1aa t 020 7435 1144 f 020 7435 0884 mail info@dmmk.co.uk