

Proposals subject to site survey and investigation, detailed design, statutory requirements and local authority approvals.

Drawing originally based upon HD Surveying drawing 02178\_\_001\_\_T\_0 dated 14.02.23, and Promap data.

Key:

+ 30.000

Existing Levels

+ 30.000

Proposed Levels

WL 29.488

Water Level

Coffer Dam

Frame zone 3m (boats excluded)

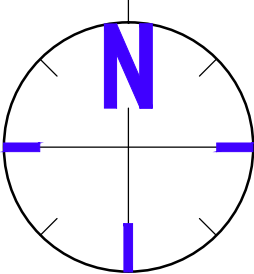
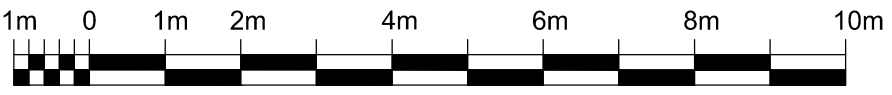

1. Proposed sequence of operations (see Rothen Group RAMS for detailed sequence of operations).
- Dredging to facilitate access to bank works
  - Break out existing concrete from behind wall & remove off site
  - Dig slot trench
  - Drive front face piles (not Cantilever)
  - Drive anchor piles with back ties
  - Take down existing wall to facilitate attaching water/channel
  - Attach water/channel to front of pile
  - Continue to remove existing wall to 1.2m before water level
  - Install outfalls
  - Install Capping tray
  - Coper install
  - Mooring rings
- Please refer to Specialist Contractor (Rothen Group) Risk Assessments and Method Statements for detailed breakdown of construction methodology.
2. For Landscaping details - see dwgs. FNF-BOSK-90-F3-00-DR-3000 (3), FNF-BOSK-90-F-00-DR-6000(3), FNF-BOSK-90-F-00-DR-2000(3) and FNF-BOSK-90-F-00-DR-6001(4).
3. For Drainage details - see dwgs. FNF-C-E-HYD-DR-01-0201 (C7), FNF-C-E-HYD-DR-01-0201 (C14) and FNF-SITE-HYD-DR-01-0201 (C1).
4. For Surface Water Drainage outfall details - see dwgs. DOUBLE HINGE VALVE OPTION 1 and DOUBLE HINGE VALVE OPTION 2
5. For Capping Beam details - see dwgs. CAPPING DETAIL OPTION 1
6. For Structural Engineer's details - see dwgs. FNF-NIR-ZZ-XX-DR-S-31000-C02 FNF-NIR-ZZ-XX-DR-S-31002-C03
7. For Barge details and position. - see dwgs. FNF-BOSK-90-XX-ZZ-SK-0020-P01

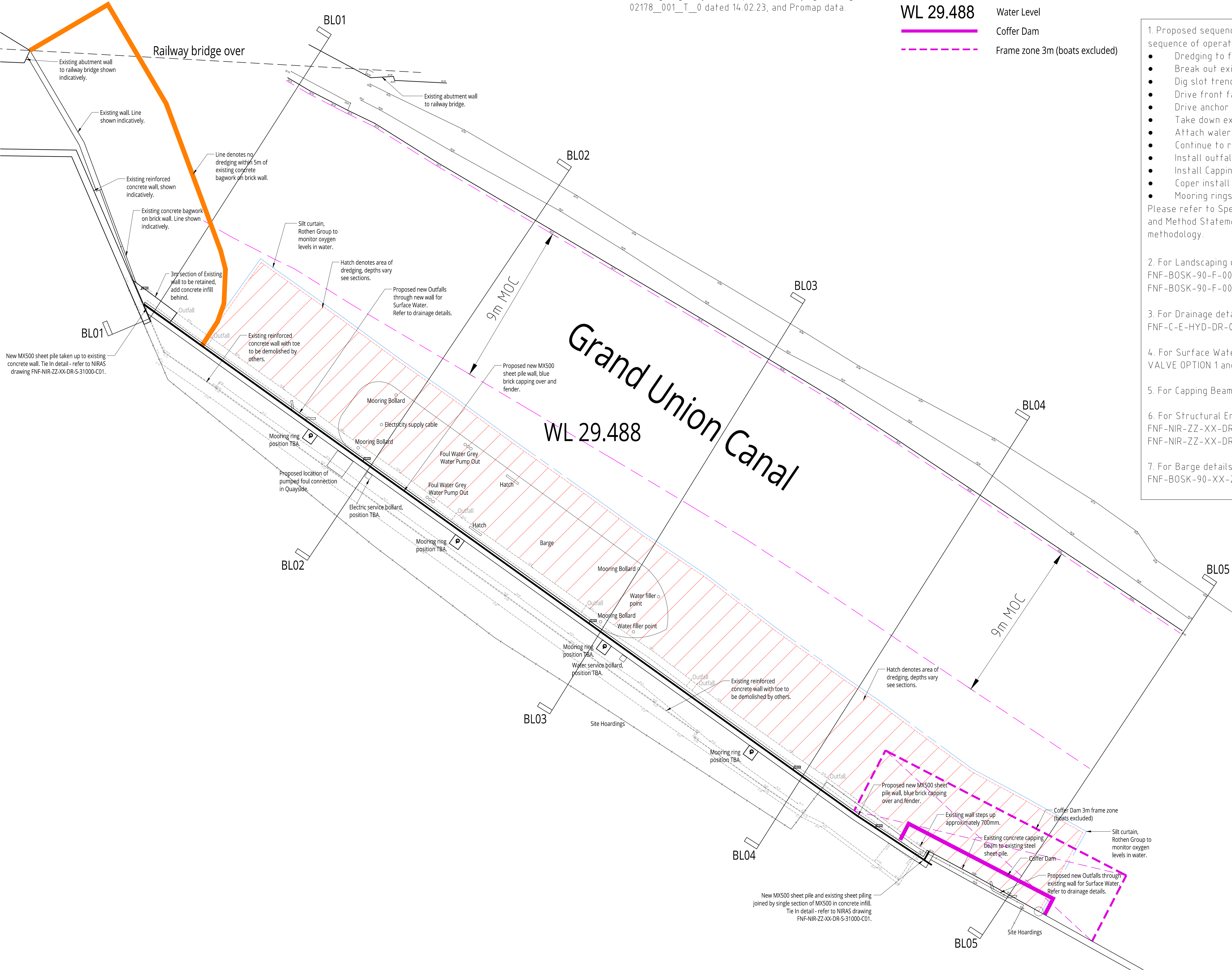

M	WORK BOATS REMOVED.	BWS	03.08.23
L	MINOR REVISION TO SUIT NIRAS DRAWING REFS.	BWS	02.08.23
K	MINOR REVISION TO SUIT NIRAS DRAWINGS	BWS	31.07.23
J	LEVELS REVISED TO SUIT NIRAS DRAWINGS. COFFER DAM TO OUTLET BY BARGE OMITTED.	BWS	27.07.23
H	MINOR REVISION TO NOTES.	BWS	31.05.23
G	MOORING RINGS AMENDED. COFFER DAMS AND FRAME ZONE SHOWN. WALL LAYOUT AMENDED TO SUIT NIRAS DRAWINGS. NOTES AMENDED.	BWS	31.05.23
F	WALL TIE IN ENDS AND NOTES AMENDED. ADDITIONAL INFORMATION ADDED FOR BARGE AND SERVICE BOLLARDS.	BWS	14.04.23
E	WALL POSITION AND NOTES AMENDED. SEQUENCE NOTES AND DRAWING REFERENCE INFORMATION ADDED.	BWS	31.03.23
D	MINOR REVISION TO NOTES.	EE	22.03.23
C	MINOR REVISION	EE	20.03.22
B	SCHEME AMENDED. DREDGING EXCLUSION ZONE SHOWN AND SWD OUTLETS ADDED. TIE IN DETAILS NOTED	EE	16.03.22
A	EQUIPMENT ADDED. SILT CURTAIN AND MOC SHOWN	EE	08.03.22
Rev	Description	Edited	Date
BLUETECH WATERFERONT SOLUTIONS LTD			
Georgian House, 63 - 73 Salford Warwick CV34 4TR			
Tel: 01926 353 555 Fax: 01926 353 559 Email: enquiries@bluetechwaterfrontsolutions.co.uk Web: www.bluetechwaterfrontsolutions.co.uk			
CLIENT -			
PROJECT WORKS TO EXISTING CANAL, FORMER NESTLE FACTORY, HAYES			
DRAWING GENERAL ARRANGEMENT PLAN			
SCALE 1:100 @A1	DRAWN BWS	DATE 07-03-22	DRG. NO. 2308-SP01
			REV M

All dimensions to be checked on site before work is commenced. Do not scale from this drawing. This drawing is copyright and must not be reproduced without consent.