

Contact:
Email: rabinkhadda@hotmail.co.uk,
Cell: 044 + 078 3293 8374
Web site: www.bluearchdesign.co.uk

Notes:
© 2023 Blue Architecture Limited.
All rights reserved.
All drawings are for the purpose of gaining
Planning approval only.
All written dimensions to be taken in
preferences to scaled dimensions.
The contractor is responsible for checking
and verifying measurements on site prior
to any work commencing.
All work is to be carried out to be the
requirements, and to the satisfaction
of the Local Authority.

Rev.	Description	By	Ckd	Date
01.	1.0 M set back from front elevation and side extension reduce to Single storey only	L-p	R.k	25/02/24

Client:
Mr. Gurkirat Singh.

Project:
Part single part Double storey side and Rear wraparound.

Location:
33 Longmead Road, Hayes,
Middlesex, UB3 2HB.

Status:
PLANNING

Title:
Existing and Proposed Block plans.

Drawn by:	Sr. Et.	Checked by:
L.p	---	R.k
Project no:	Sheet Size	Sheet no.
BAI-33LM	A3	
Date:	Scale:	
15/11/2023	1:500	

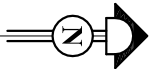
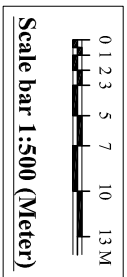

Note:
Similar application Approved Next Door
35 Longmead Rd, Hayes,
Ref:67788/AP/2012/865

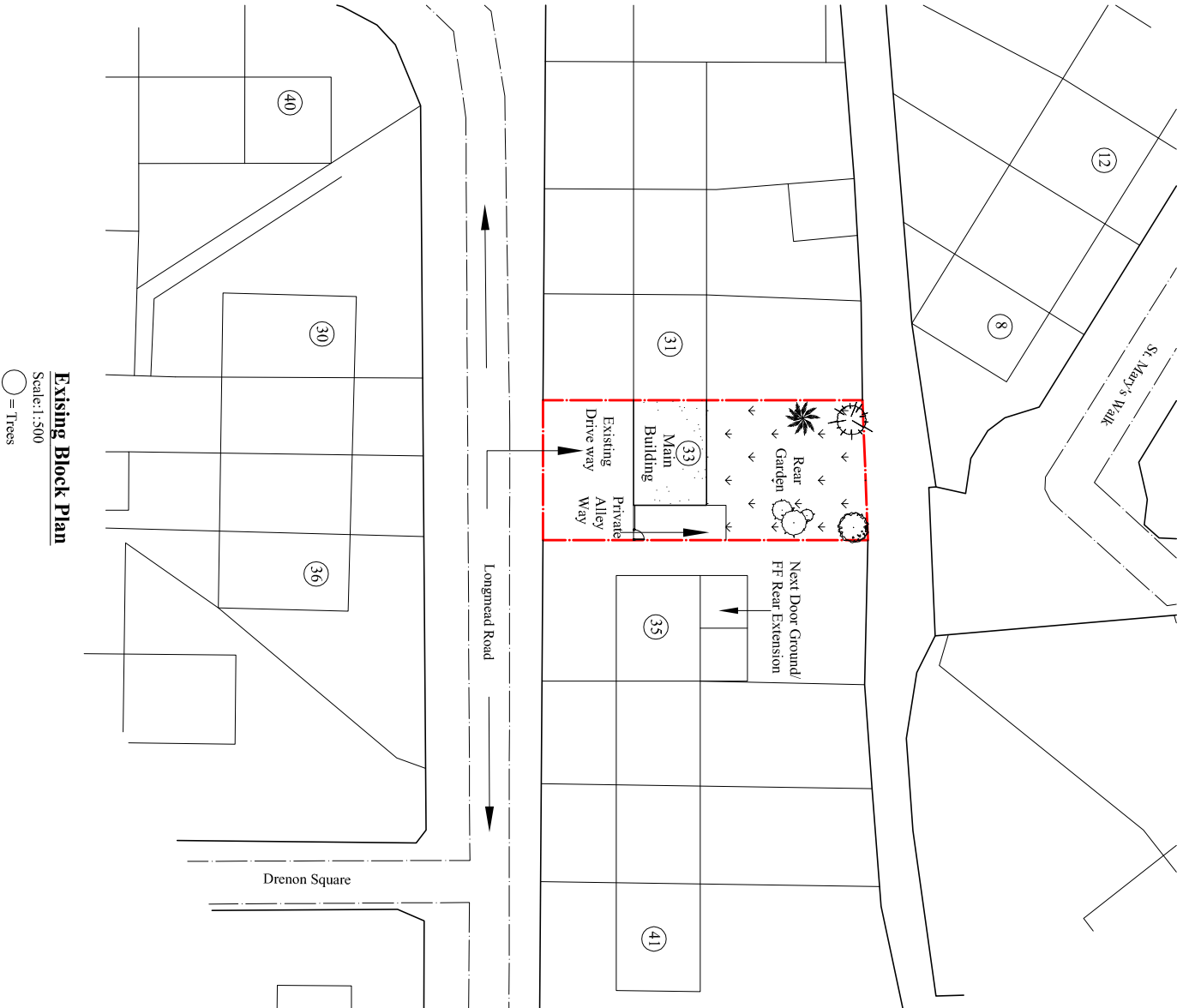

Existing Block Plan
Scale:1:500
○ = Trees

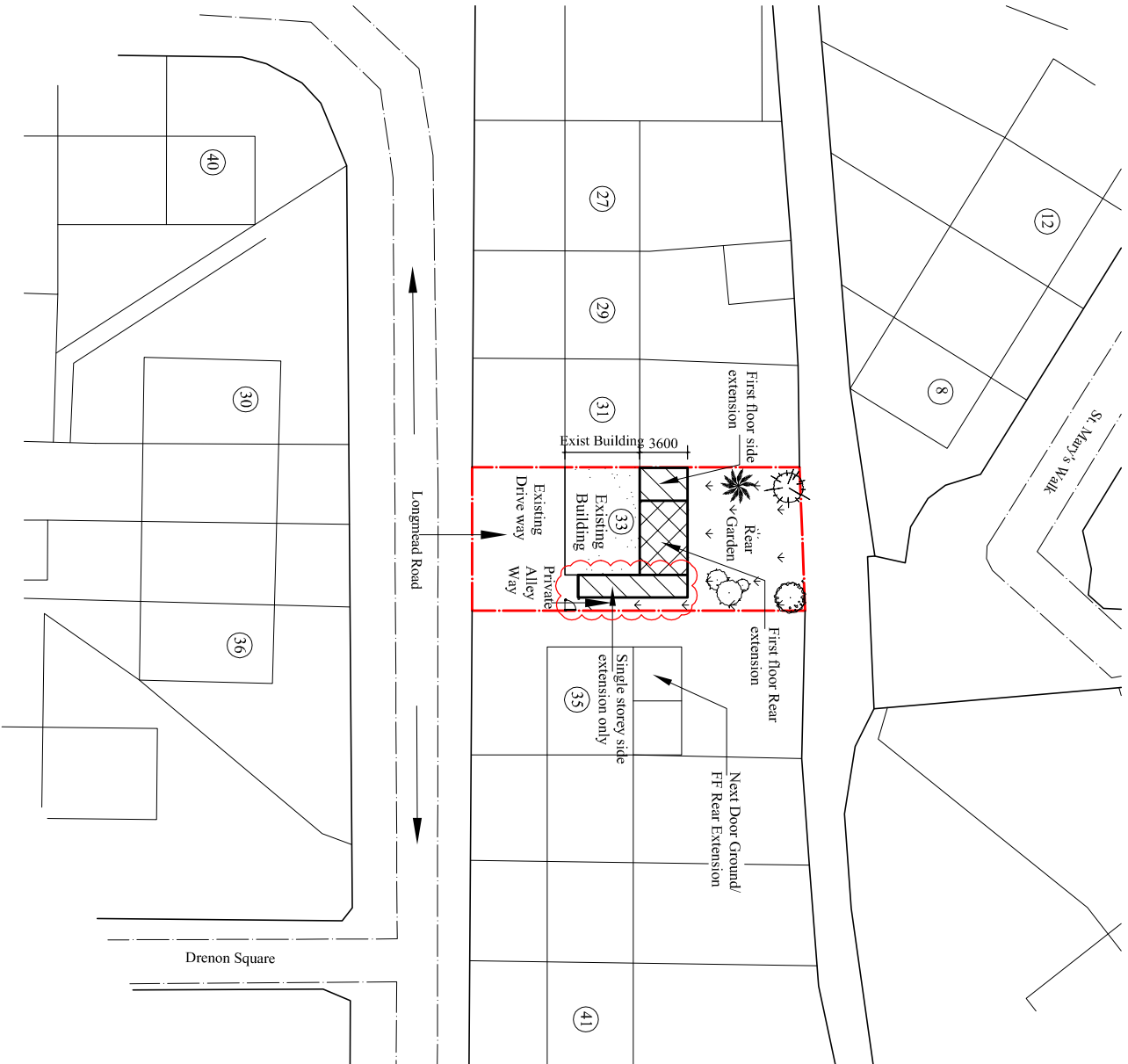

Proposed Block Plan
Scale:1:500
○ = Trees