

**Contact:**  
Email: [rabinkhadka@hotmail.co.uk](mailto:rabinkhadka@hotmail.co.uk),  
Cell: 044 + 078 3293 8374  
Web site: [www.bluearcdesign.co.uk](http://www.bluearcdesign.co.uk)

**Notes:**  
 © 2023 Blue Architecture Limited.  
 All rights reserved.  
 All drawings are for the purpose of gaining  
Planning approval only.  
 All written dimensions to be taken in  
 preference to scaled dimensions.  
 The contractor is responsible for checking  
 and verifying measurements on site prior  
 to any work commencing.  
 All work is to be carried out to be the  
 requirements, and to the satisfaction  
 of the Local Authority.

Rev.	Description	By	Ckd	Date
01.	1.0 M set back from front elevation and Rear extension 3.60 M	L.p	R.k	05/02/2017

Client:  
**Mr. Gurkirat Singh.**

**Project:**  
Part single part Double storey side and Rear wraparound.

**Location:**  
33 Longmead Road, Hayes,  
Middlesex, UB3 2HB.

**Status:**  
PLANNING

**Title:**  
Existing and Proposed Block plans.

Drawn by:	Str. Er.	Checked by:
-----------	----------	-------------

Date: \_\_\_\_\_ Scale: \_\_\_\_\_

15/11/2023	1:50
------------	------

07

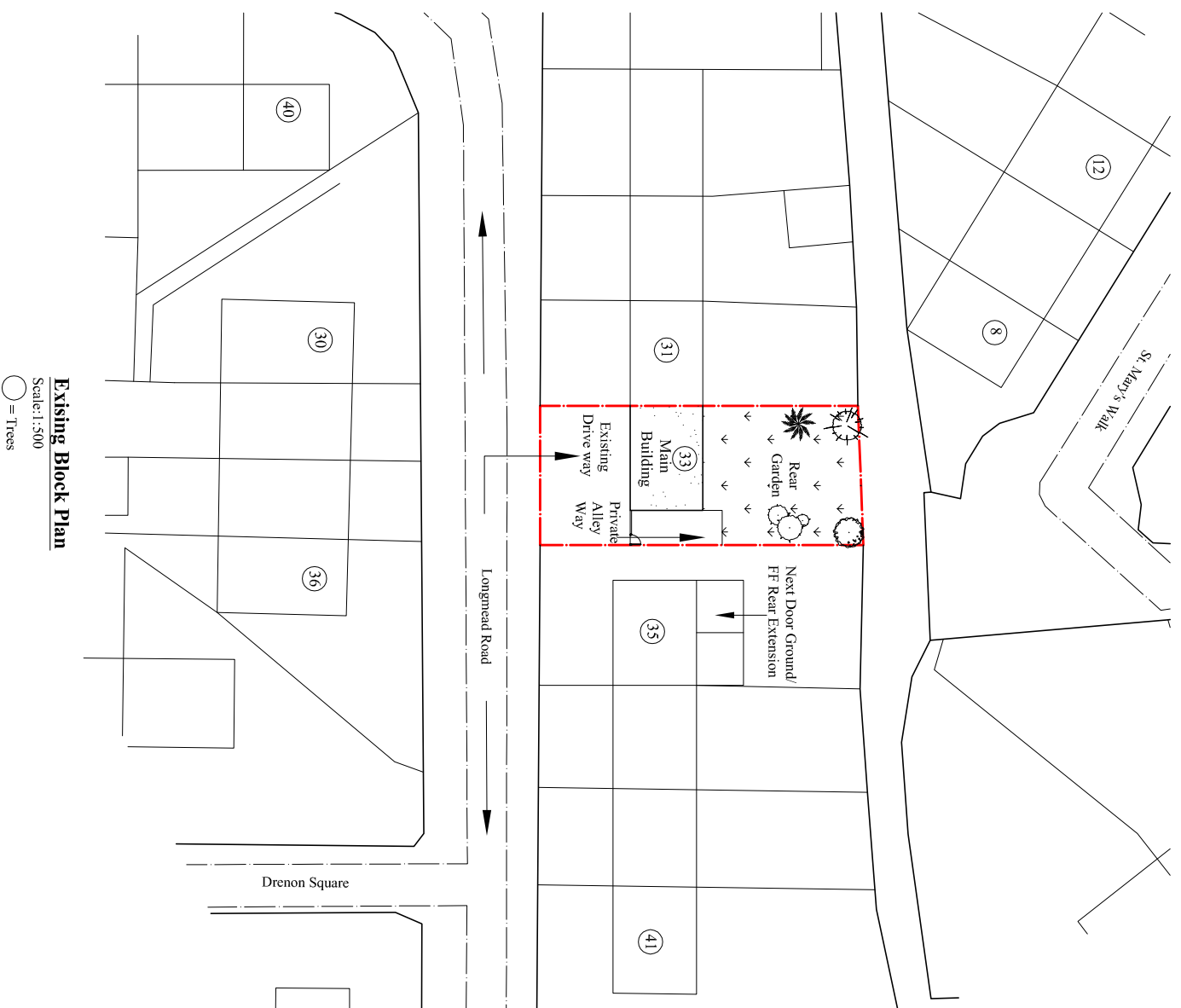
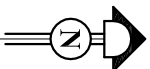
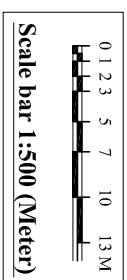

## Existing Block Plan

Scale:1:500

○ = Trees

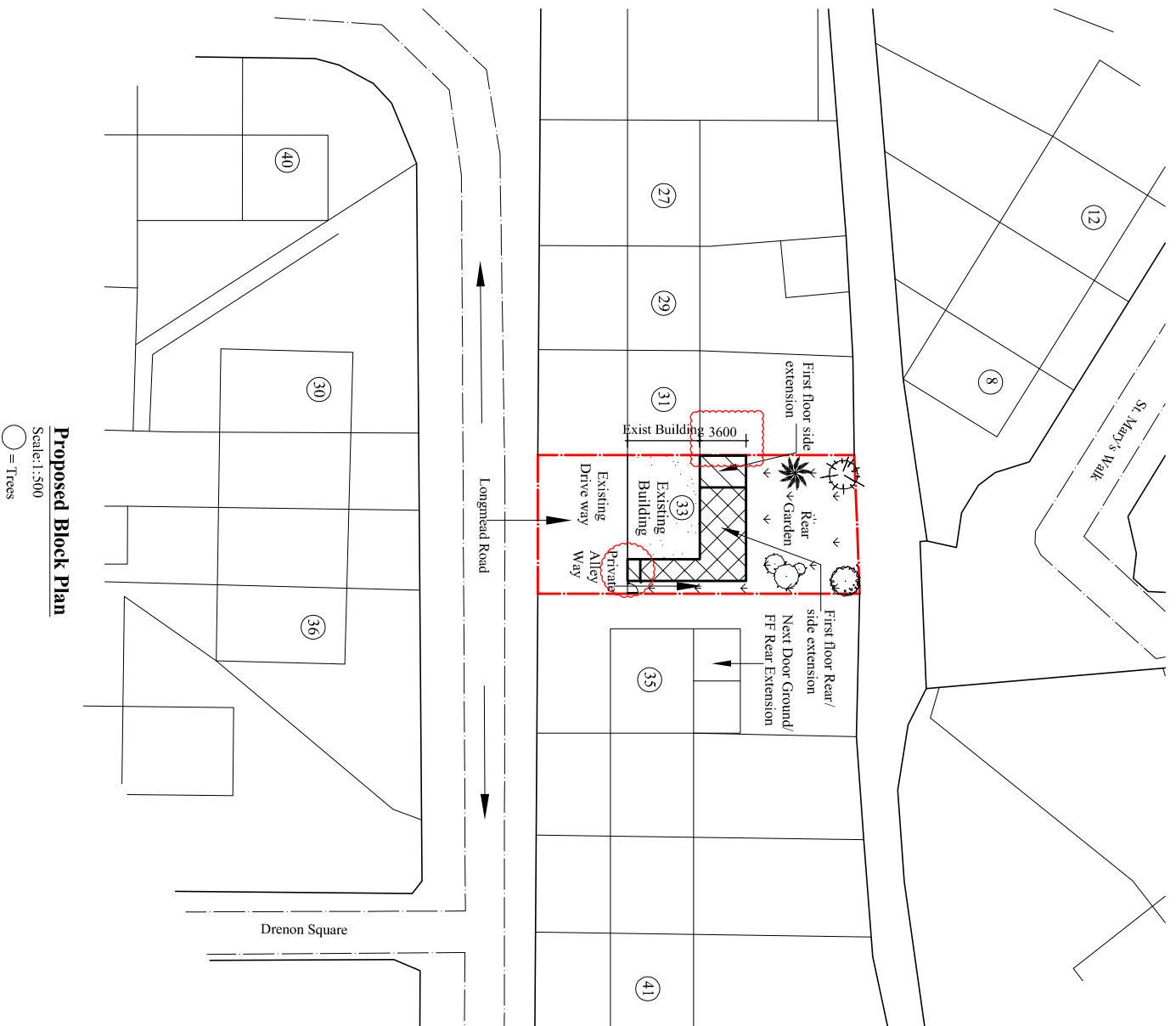

### Proposed Block Plan

Scale:1:500

 $\bigcirc = \text{Trees}$