

Notes:

1. Demolish existing storage space
2. Enlarge opening for new sliding door
3. Replace window
4. Strip out existing kitchen appliances, units, floor and wall finishes etc
5. Replace exterior door
6. Remove existing dome skylight

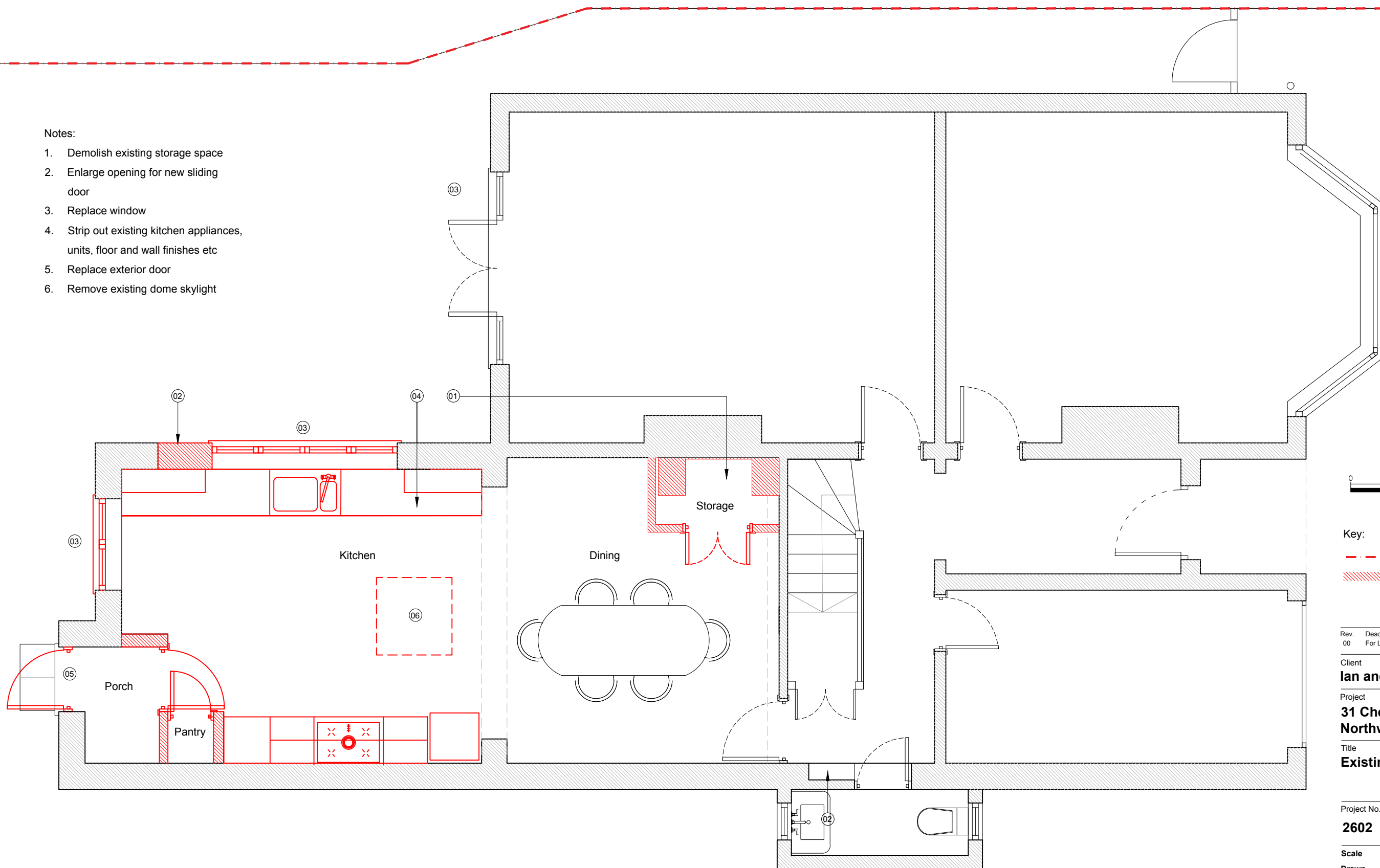

Key:

- - - Site boundary
- ▨ Demolition

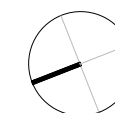

Rev.	Description	By	Date
00	For Lawful Development Certificate	MC	14.04.26

Client
Ian and Candy Crane

Project
**31 Chester Road,
Northwood HA6 1BG**

Title
Existing Ground Floor Plan

Project No.	Drawing No.	Rev.
2602	10.201	-

Scale	Drawn	Date
	DK	09.01.26

Do not scale from this drawing. The Contractor is to take and check all dimensions on site before work commences. Discrepancies must be reported to the Architect. Subcontractors must verify all dimensions on site before making a shop drawing or commencing manufacturing. This drawing is copyright. ©

© Copyright Coste + Beno Ltd
20 Leaf Close, Northwood
HA6 2YY
Phone. 0776 703 7572
info@costeandbeno.co.uk
www.costeandbeno.co.uk

Notes:

1. Remove existing pitched roof due to poor condition. Retain existing footprint of the extension and raise parapet walls.
2. Existing skylight dome removed and opening enlarge to allow for larger skylight

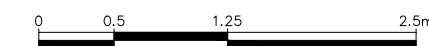
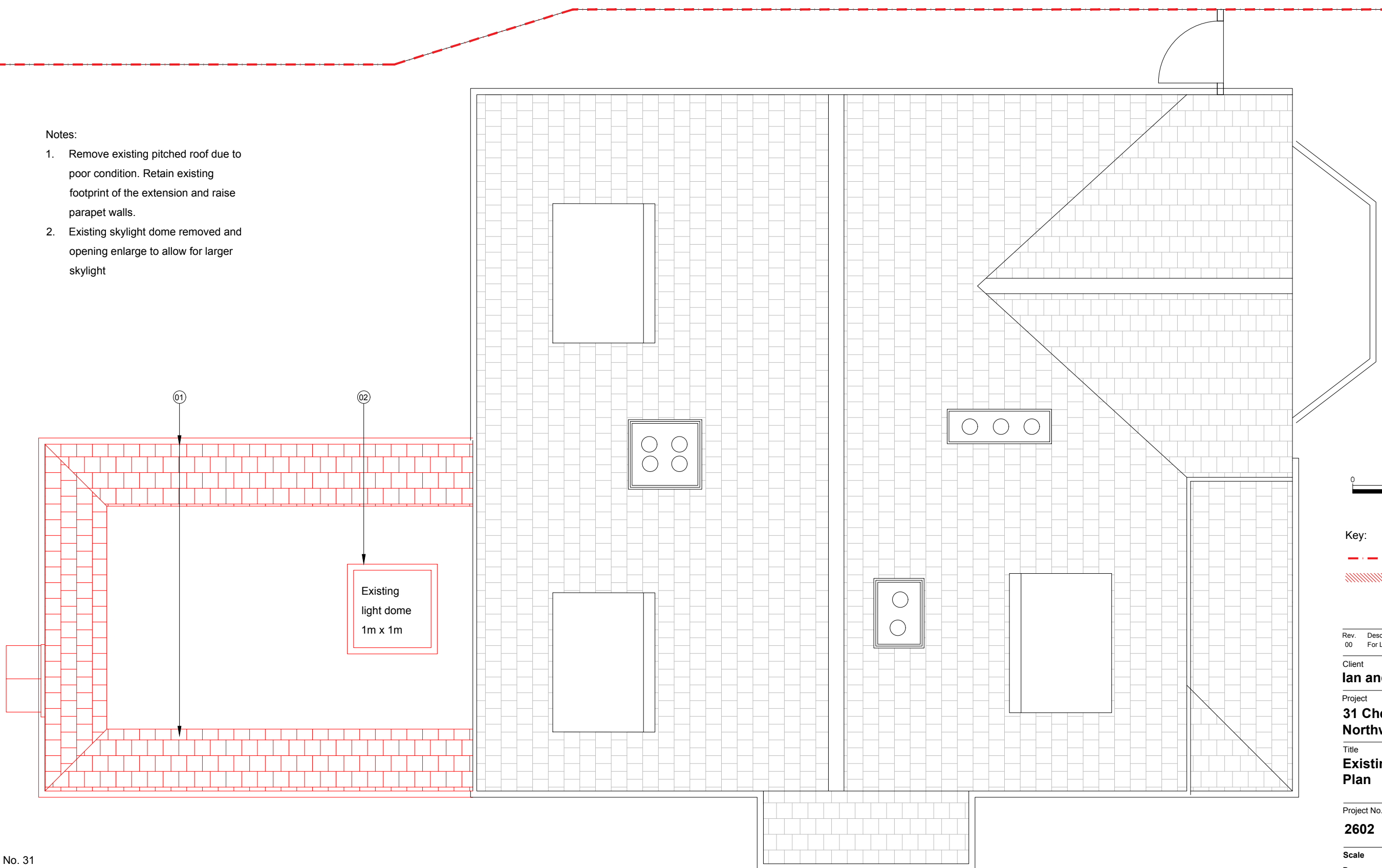

Key:

- - - Site boundary
- ▨ Demolition

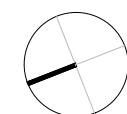

Rev.	Description.	By	Date
00	For Lawful Development Certificate	MC	14.04.26

Client
Ian and Candy Crane

Project
**31 Chester Road,
Northwood HA6 1BG**

Title
**Existing / Demolition Roof
Plan**

Project No.	Drawing No.	Rev.
2602	10.202	-

Scale	Drawn	Date
	DK	09.01.26

Do not scale from this drawing. The Contractor is to take and check all dimensions on site before work commences. Discrepancies must be reported to the Architect. Subcontractors must verify all dimensions on site before making a shop drawing or commencing manufacturing. This drawing is copyright. ©

© Copyright Coste + Beno Ltd
20 Leaf Close, Northwood
HA6 2YY
Phone. 0776 703 7572
info@costeandbeno.co.uk
www.costeandbeno.co.uk

No. 31

No. 29



Notes:

1. Strip back existing loose and damaged pebbledash and prepare surface to fit for new external wall insulation

Key:

- - - Site boundary
- ▨▨▨▨▨ Demolition

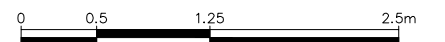

Rev.	Description	By	Date
00	For Lawful Development Certificate	MC	14.04.26

Client

Ian and Candy Crane

Project

**31 Chester Road,
Northwood HA6 1BG**

Title

Existing Front Elevation

Project No.	Drawing No.	Rev.
2602	10.271	-

Scale

Drawn	Date
DK	09.01.26

Do not scale from this drawing. The Contractor is to take and check all dimensions on site before work commences. Discrepancies must be reported to the Architect. Subcontractors must verify all dimensions on site before making a shop drawing or commencing manufacturing. This drawing is copyright. ©

© Copyright Coste + Beno Ltd
20 Leaf Close, Northwood
HA6 2YY
Phone. 0776 703 7572
info@costeandbeno.co.uk
www.costeandbeno.co.uk

01 Existing Front Elevation
10.271 Scale 1:50 @ A3



Notes:

1. Strip back existing loose and damaged pebbledash and prepare surface to fit for new external wall insulation
2. Pitched roof to be demolished
3. Exterior door to be removed
4. Window to be removed and opening to be enlarged

Key:

- - - Site boundary
- ▨ Demolition

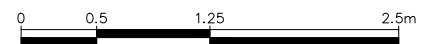

Rev.	Description	By	Date
00	For Lawful Development Certificate	MC	14.04.26

Client

Ian and Candy Crane

Project

**31 Chester Road,
Northwood HA6 1BG**

Title

Existing Rear Elevation

Project No.	Drawing No.	Rev.
2602	10.272	-

Scale

Drawn	Date
DK	09.01.26

Do not scale from this drawing. The Contractor is to take and check all dimensions on site before work commences. Discrepancies must be reported to the Architect. Subcontractors must verify all dimensions on site before making a shop drawing or commencing manufacturing. This drawing is copyright. ©

© Copyright Coste + Beno Ltd
20 Leaf Close, Northwood
HA6 2YY
Phone. 0776 703 7572
info@costeandbeno.co.uk
www.costeandbeno.co.uk

01

Existing Rear Elevation

10.272

Scale 1:50 @ A3



Notes:

1. Strip back existing pebbledash and prepare for new render.
2. Roof to be demolished
3. Window to be removed and enlarge opening for new door.

Key:

- Site boundary
- ▨ Demolition

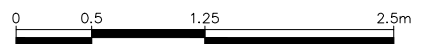

Rev.	Description.	By	Date
00	For Lawful Development Certificate	MC	14.04.26

Client

Ian and Candy Crane

Project

**31 Chester Road,
Northwood HA6 1BG**

Title

Existing West Elevation

Project No.	Drawing No.	Rev.
2602	10.274	-

Scale

Drawn	Date
DK	09.01.26

Do not scale from this drawing. The Contractor is to take and check all dimensions on site before work commences. Discrepancies must be reported to the Architect. Subcontractors must verify all dimensions on site before making a shop drawing or commencing manufacturing. This drawing is copyright. ©

© Copyright Coste + Beno Ltd
20 Leaf Close, Northwood
HA6 2YY
Phone. 0776 703 7572
info@costeandbeno.co.uk
www.costeandbeno.co.uk