



Wave cladding for the internal courtyard of Hayes Central.

Colour RAL 9010

Top cladding has 50mm fluted profile
Bottom cladding has 100mm flutes profile

Equitone Cladding to the Flat entrance Doors

Cladding Specification

Equitone [Pictura] fibre cement panels, approx. 8 –10mm thick, A2-s1,d0 fire classification.

Installed on aluminium carrier rails with concealed rivets.

Vertical and horizontal joints 10mm, open rainscreen design.

25–50mm ventilated cavity with breather membrane and fire barriers at all floor levels.

All fixings to existing structure fully reversible with no harm to listed fabric.

Wave Profiles

Upper cladding: 50mm deep fluted profile.

Lower cladding: 100mm deep fluted profile.

Vertical orientation.

Edge trims PPC to match primary colour to RAL9010.

Heights

Bottom cladding: installed from +1100mm FFL.

Upper cladding: from +1100mm FFL to soffit level (varies per floor).

Colours

Fluted cladding: RAL 9010.

Door accent colours: RAL 6025, RAL 2001, RAL 1006.

Durability

UV-stable, frost-resistant, and low-maintenance material as per manufacturer datasheet.

Fire

Rainscreen cladding to include tested horizontal fire barriers at each floor level in accordance with manufacturer details and BS 8414 / BR 135 guidance

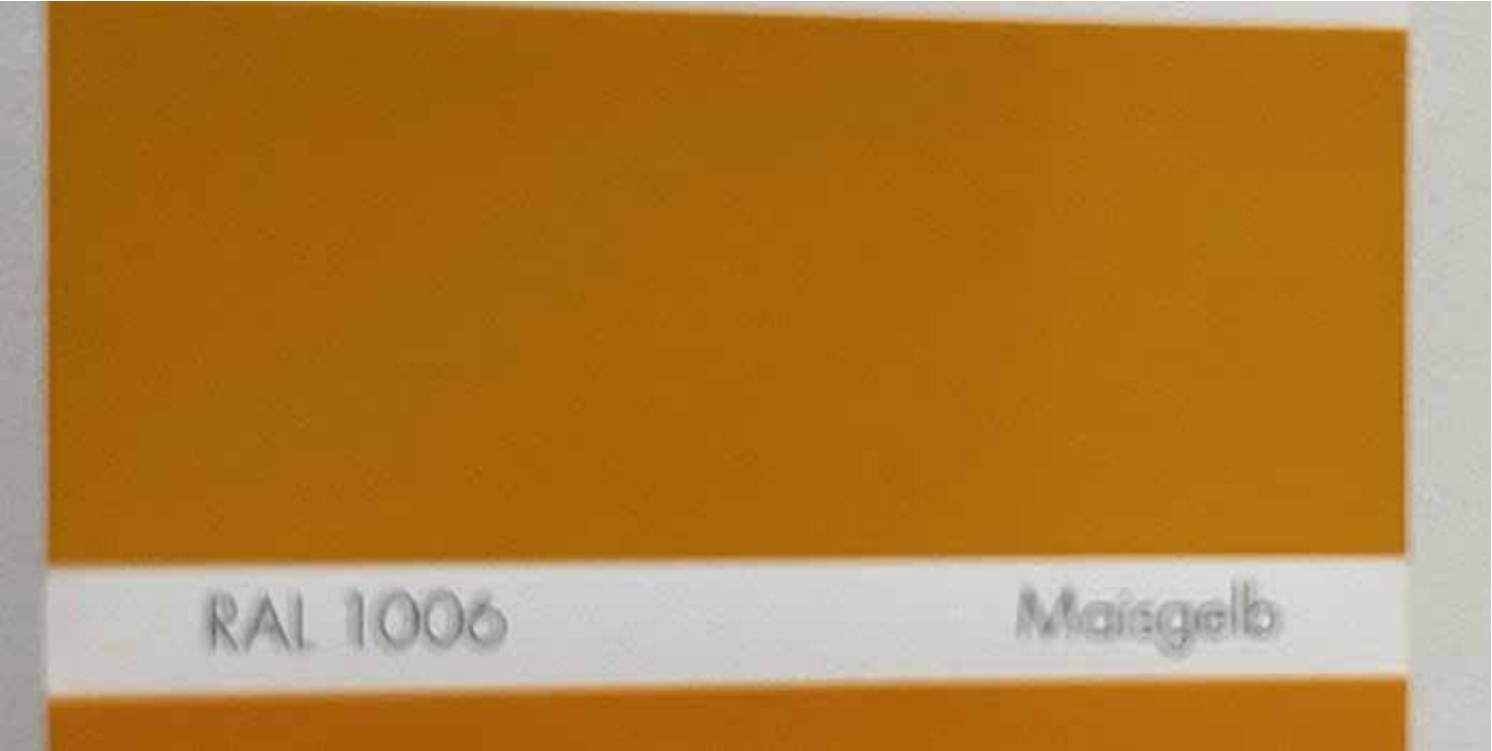
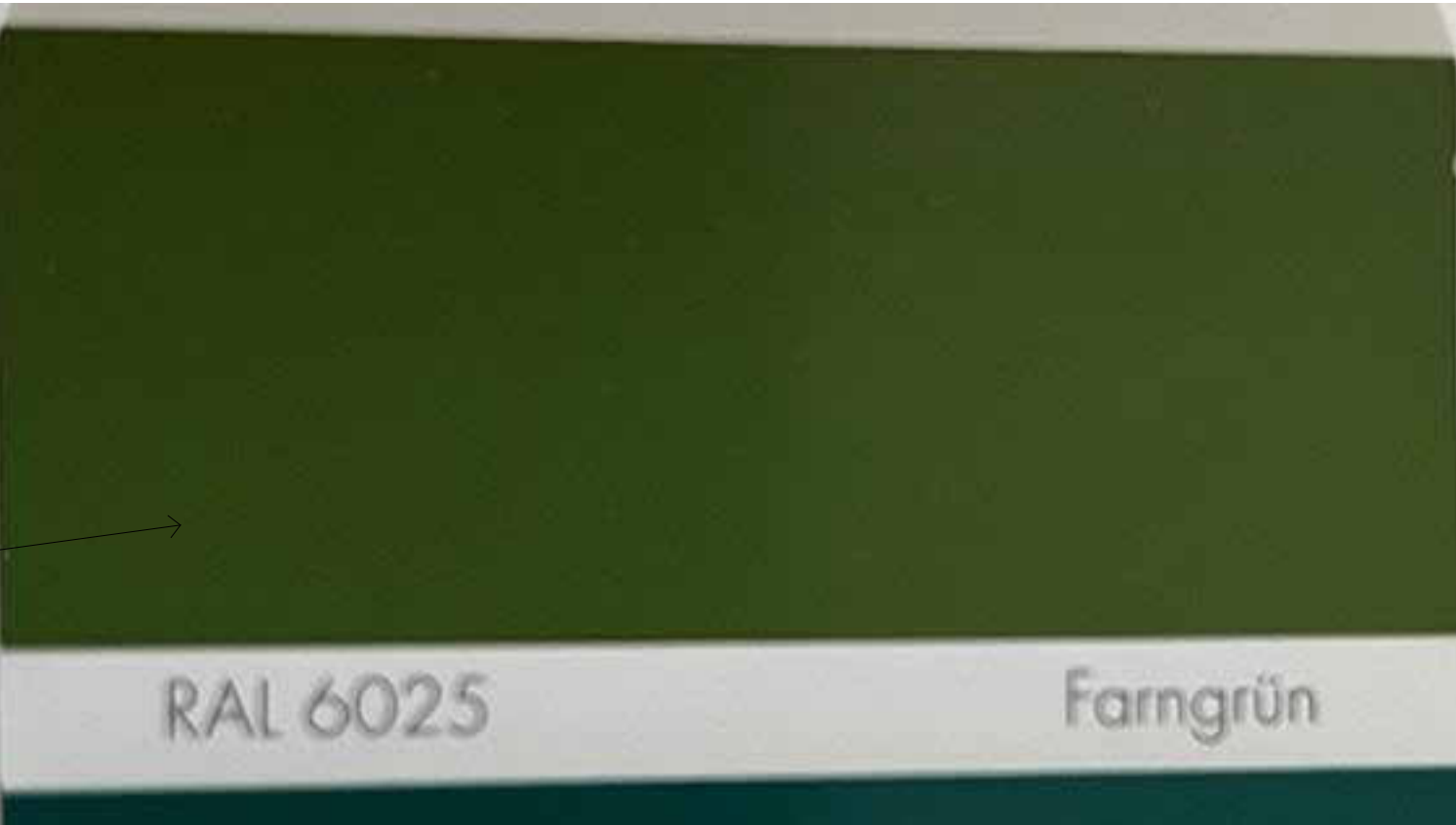

Notes:

do not scale:
detailed drawings and larger scale drawings take precedence. figured dimensions only are to be taken from this drawing.

dimensions:
All buildings and site dimensions, levels and sewer invert levels at connection points are to be checked and verified on site by the contractor before the commencement of works. All dimensions are to be checked prior to the placement of orders for materials or the fabrication of work and any discrepancy, omission or error is to be reported to the architect immediately for verification.

specification:
The contractor is to comply with current building legislation, British standard specifications, building regulations etc. whether or not specifically stated on this drawing. This drawing is to be checked against and read in conjunction with any structural or other relevant specialist and design documentation provided.

NOTE:

All drawings are subject to local authority approval, structural engineers details, energy specialist's criteria, framing manufacturer's, fenestration, cladding and other key specialists' details. Any tolerances and differential movement between elements is to be accommodated within the design

NOTE:

Final materials are to be fully in accordance with local authority approved materials schedule & colours.

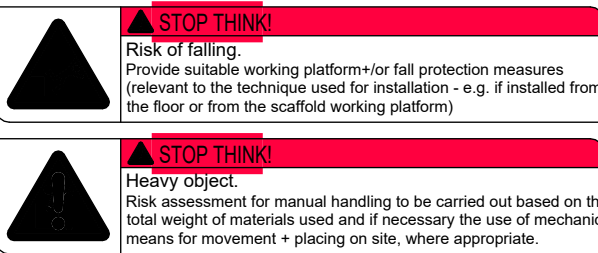

PRELIMINARY

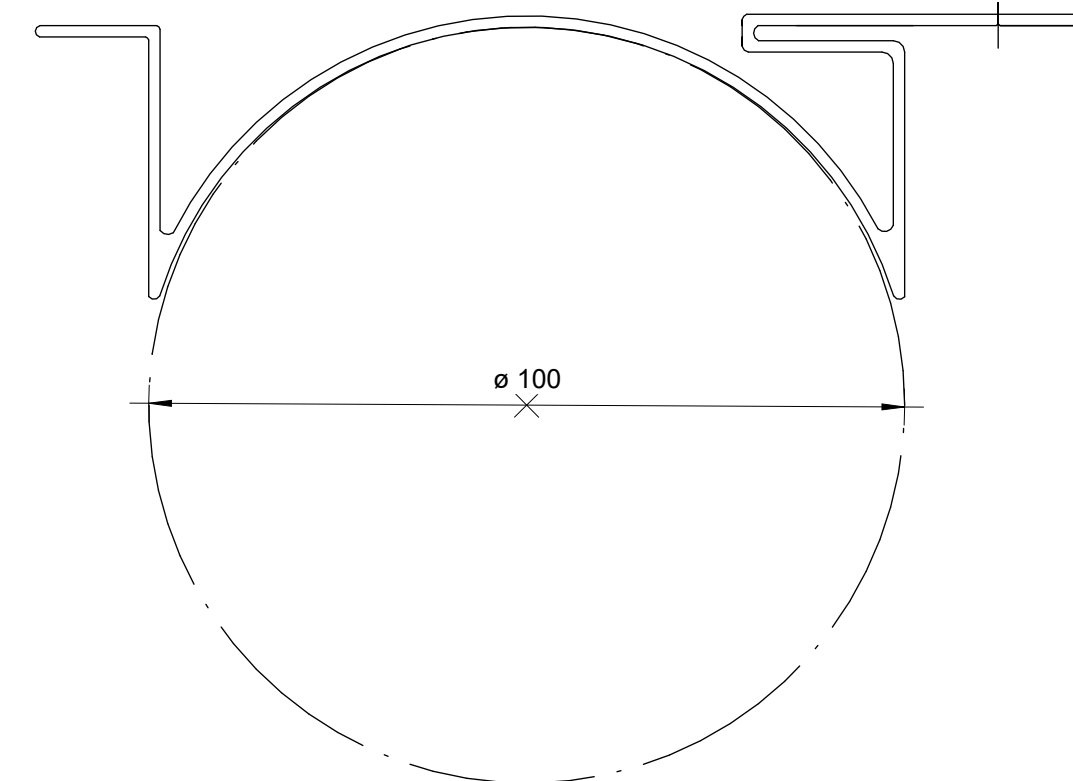
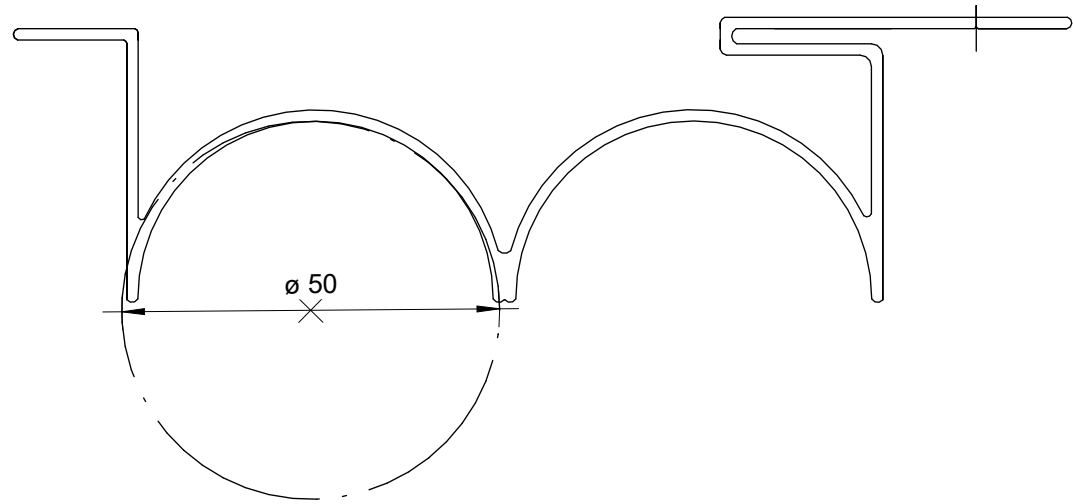

1 Wave Cladding Detail
1:1

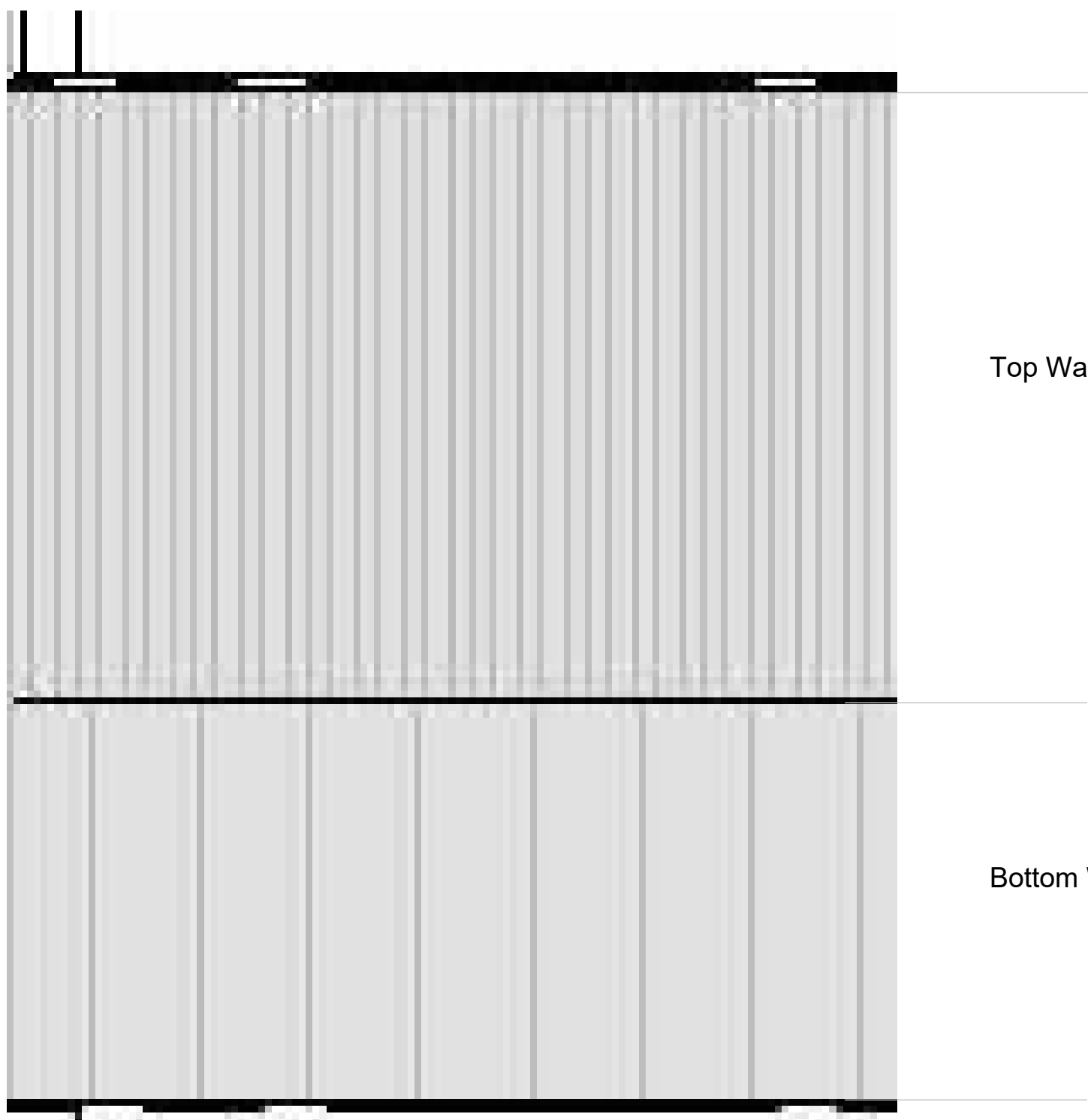

Top Wave profile 1100mm from ffl to Soffit (height varies on each floor)

Bottom Wave profile 1100mm from FFL

Rev	Description	Date	By
Client: Marson Properties			
Project: Hayes Park South, Hayes End Road, Hayes			
Description: Hayes Central - Cladding			
 architects Ltd			
head office: the old stone masons, 10 d'johns st, abergavenny, monmouthshire, np23 5rt tel: 01873 851 125 fax: 01873 851 127			
newport: first floor, 5 gold tops, newport, south Wales, NP20 4PG tel: 01633 245020			
Email: info@jdwarchitects.co.uk www.jdwarchitects.co.uk			
Drawn: Author Date: 10/07/25 Drawing No JW 1200.2	Scale: AS indicated @A1	Rev:	
1012		1012	

This drawing is copyright of the architect and may not be reproduced without license