

## Appendix C: Fire strategy drawings.

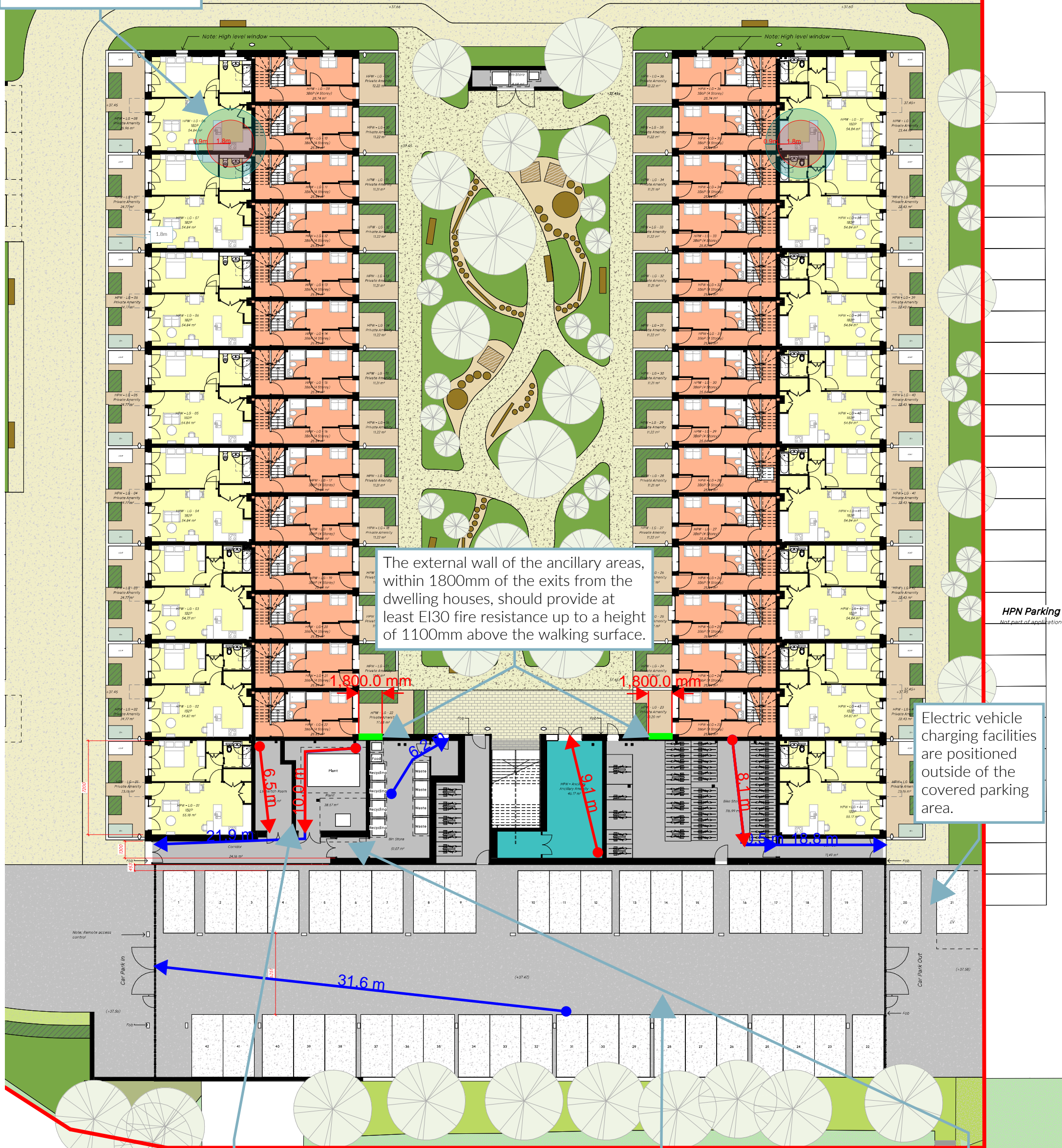

Travel distance exceeds 6m in the LV switch room (within the room and with unknown layouts) and 9m in the lower ground level plant room (within the room and with known layouts).

As layouts are developed and confirmed in the following stage of design, travel distance should not exceed 9m within these rooms. Progressing the design on this basis should be reasonable – subject to discussion and agreement with the approving authorities.

The covered car park shall be naturally ventilated through permanent openings. The ventilation should have an aggregate equivalent area of at least 5% of the floor area of the car park, with at least half of this area equally arranged between two opposing walls. This requirement is understood to be achieved for the covered car park.

Refuse store lobby shall be provided with at least  $0.2\text{m}^2$  (geometric free area) permanent natural ventilation (or equivalent mechanical).







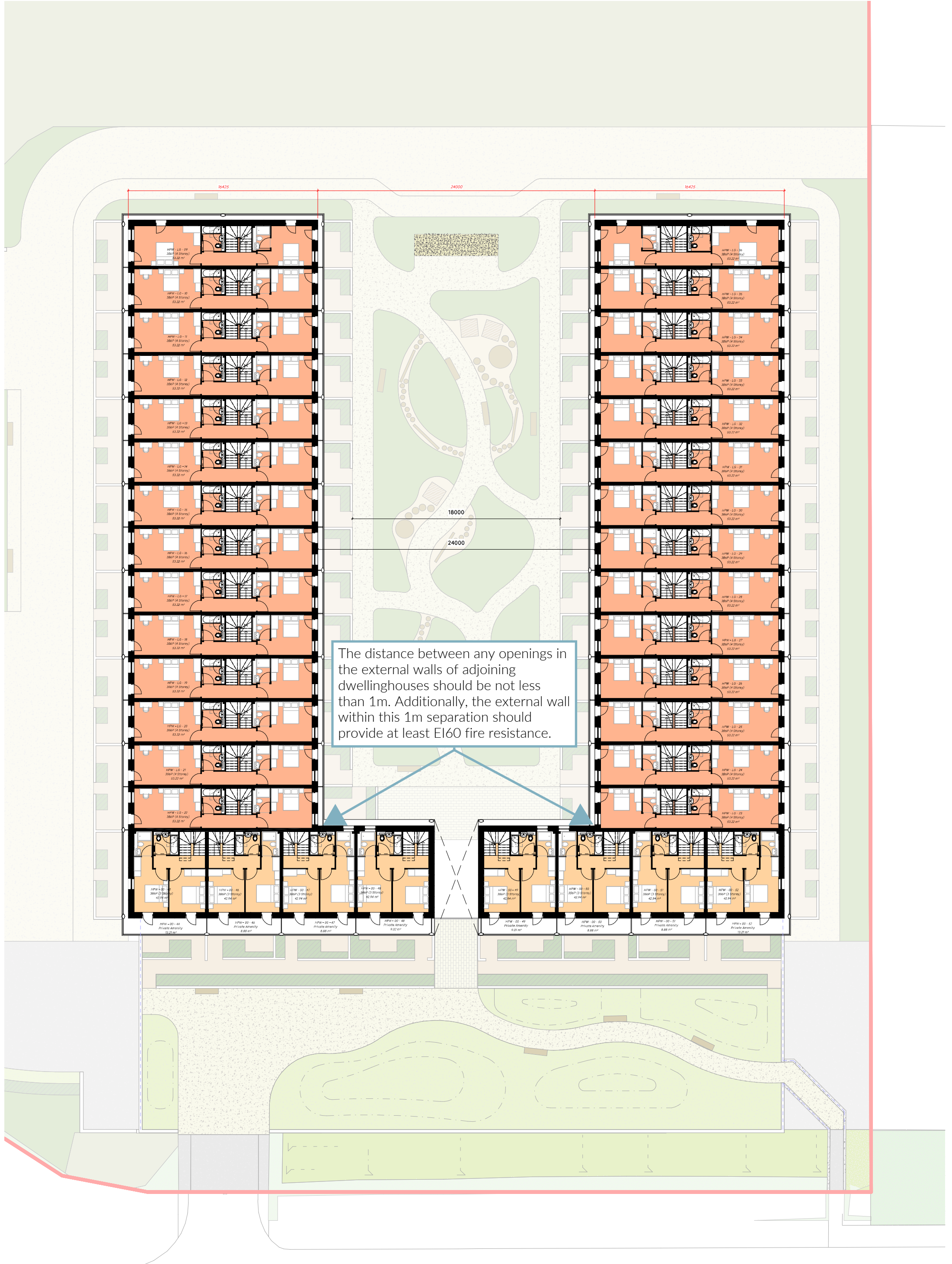

The distance between any openings in the external walls of adjoining dwellinghouses should be not less than 1m. Additionally, the external wall within this 1m separation should provide at least EI60 fire resistance.