

Fire Safety Statement

5m Single-Storey Rear Extension

Property Address:

45 Worcester Rd, Cowley, Uxbridge UB8 3TH

Local Authority:

London Borough of Hillingdon

Company:

All1house

Date:

08/11/2024

This fire safety statement addresses fire safety provisions for the proposed 5m single-storey rear extension at the above address. The following elements are designed to ensure compliance with local fire safety regulations and to facilitate safe escape routes and emergency service access.

1. Fire Station Proximity:

Hillingdon Fire Station is located approximately an 8-minute drive from the property, allowing for prompt emergency response if needed.

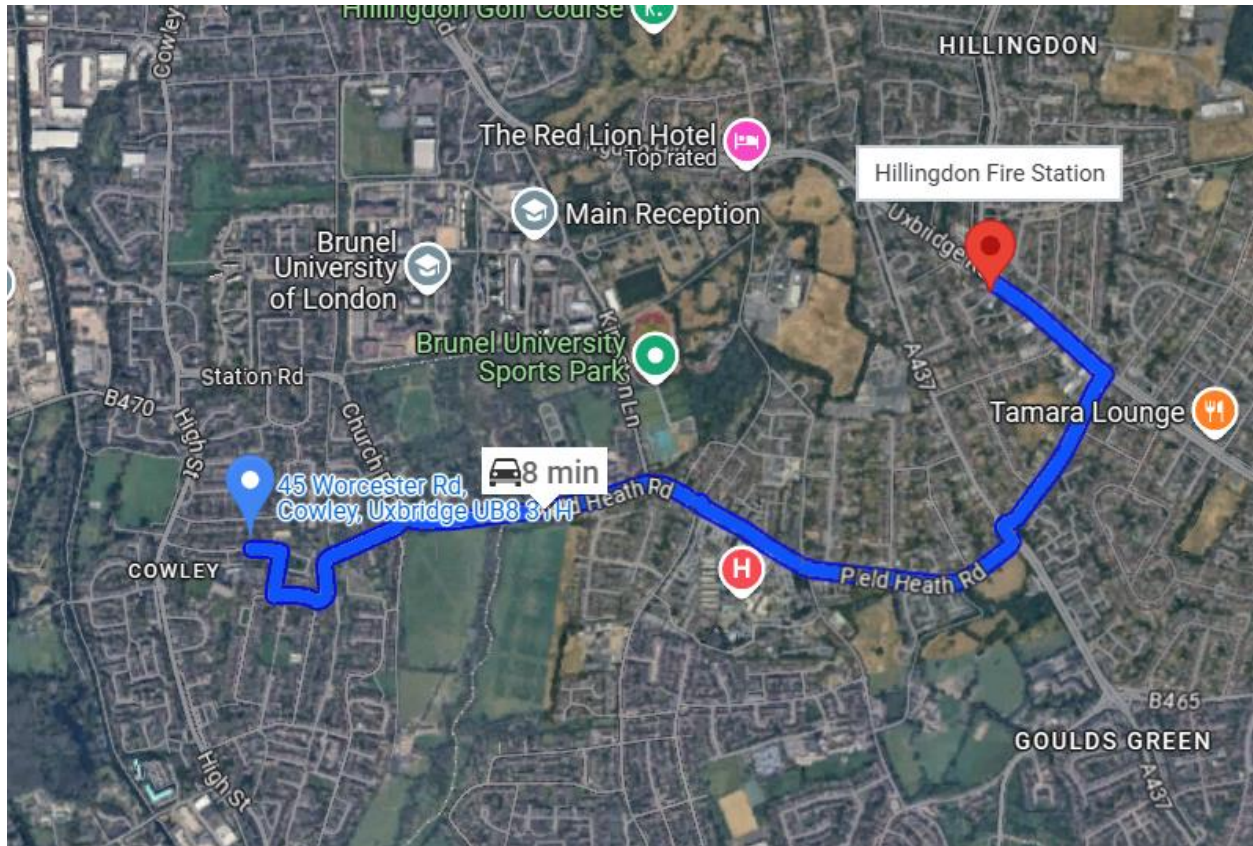

2. Escape Routes and Exits:

- Primary Escape Route: The primary escape route is a single front door, providing direct access to the front street. This exit allows for safe evacuation and clear egress from the property.
- Rear Access and Additional Exit: The extension includes a large bifold door at the rear, opening into the garden. This secondary exit enhances evacuation options in case of emergency.
- Corridor Connection: A side corridor connects the rear garden to the front of the property, creating an alternative route to the main exit at the front.

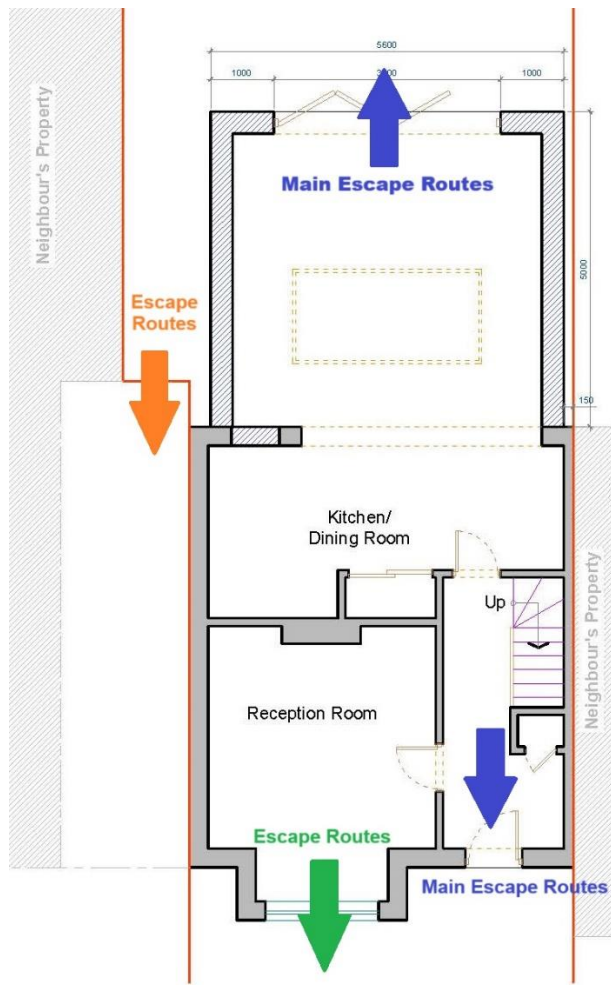

1 PROPOSED GROUND FLOOR PLAN

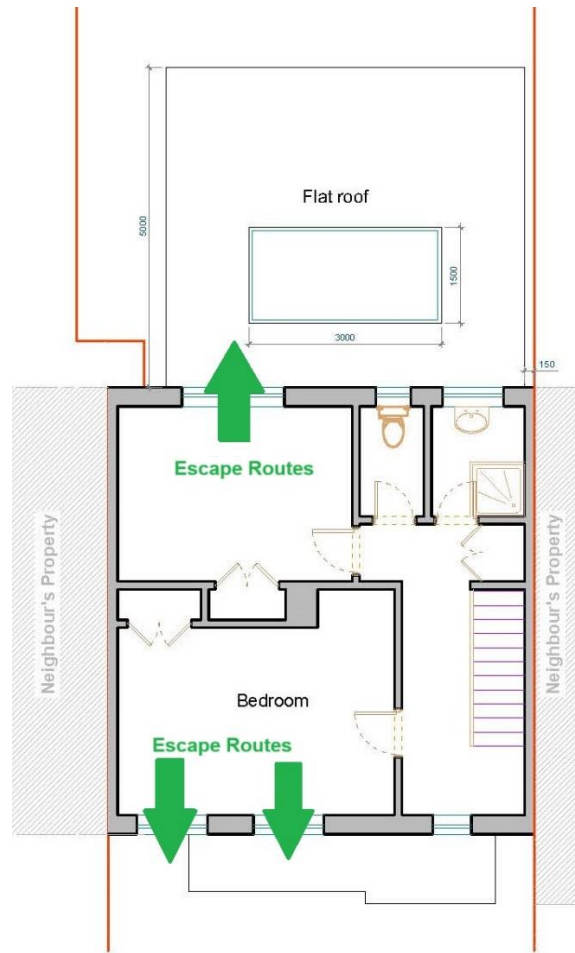

2 PROPOSED FIRST FLOOR PLAN

3. Passive Safety Features:

All rooms within the property are equipped with escape windows, providing a passive means of escape if required. These windows meet the recommended dimensions and placement for accessible emergency exits.

4. Emergency Services Access and Open Space:

There is ample open space at the front of the property, which ensures unhindered access for firefighting vehicles and equipment. The fire service has sufficient space to position their vehicles close to the front entrance for rapid response and intervention.



5. Construction and Fire Resistance:

The construction materials and design of the extension will comply with fire resistance standards as per Building Regulations Part B, ensuring that all materials used will help contain the spread of fire.

6. Internal Fire Detection and Alarms:

The property is equipped with smoke detectors and alarms to provide early warning in the event of a fire. These alarms are placed throughout the property, ensuring compliance with safety standards.

7. Compliance with Local Authority Requirements:

This fire statement has been prepared to align with the requirements outlined by the London Borough of Hillingdon's planning and fire safety guidelines for extensions and building works.

In summary, the design and layout of the proposed rear extension support safe egress options, facilitate easy access for emergency services, and meet fire safety standards to ensure the safety of occupants and responders alike.