

GHA Trees
5 South Drive
High Wycombe
Bucks
HP13 6JU



Glen Harding MICFor
MSc (Forestry), MArborA
t: 07884 056025
e: info@ghatrees.co.uk
www.ghatrees.co.uk

Mr D Patel
69 Copse Wood Way
Northwood
HA6 2TZ

21st October 2022

Dear Mr Patel,

RE: 69 Copse Wood Way, Northwood, HA6 2TZ

Further to my recent site visit, below I have outlined the pruning I propose in order to manage the growth of the trees in the front and rear garden of the above property, to maintain them in context with the soon to be built house. This work is proposed to manage the trees crowns without detracting from their landscape value.

Location plan:



Site plan:

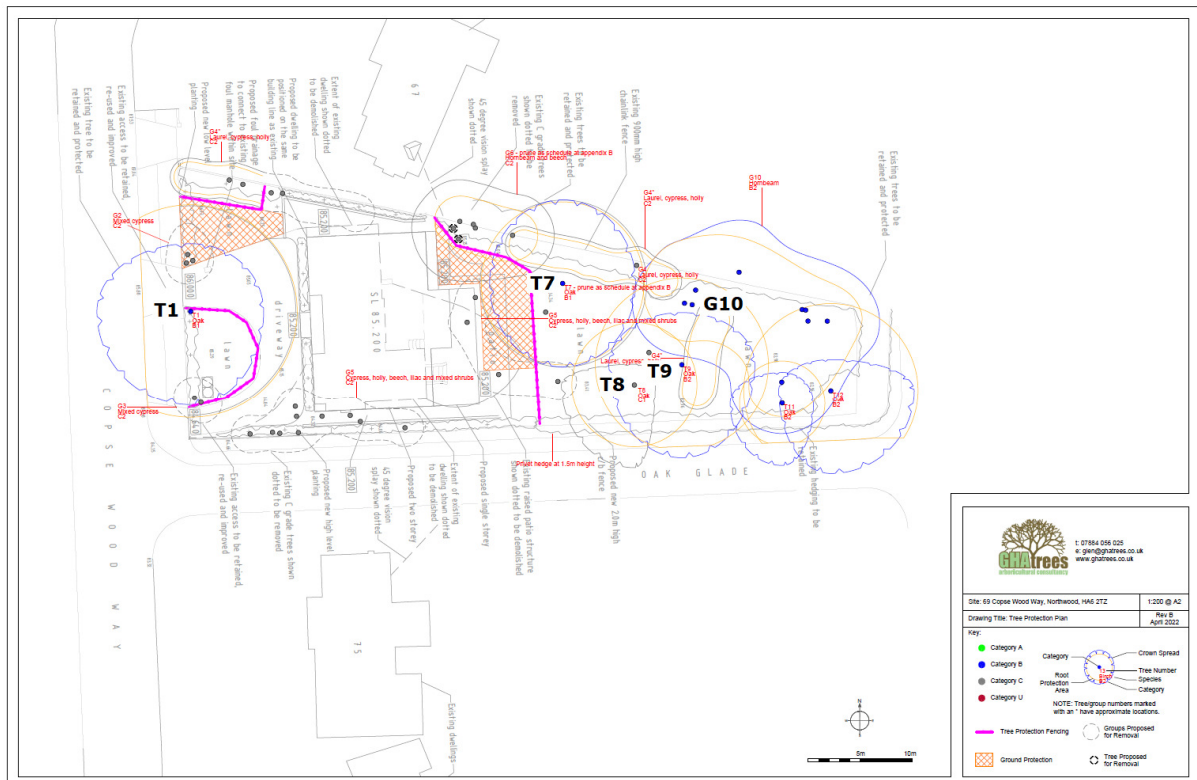

T1 Oak

Survey comments: No notable defects. Tree crown unbalanced. Heavy and low limbs on road side which are beginning to obstruct road.

Recommendation:

- Reduce eastern crown laterally from 7m to 6m
- Reduce southern crown laterally from 9m to 7m
- Reduce western crown laterally from 9m to 7m
- Crown lift to give a ground clearance of 6m over site and road. This must be done pruning only secondary limbs, and none greater in diameter than 100mm.

Photo: T1 overhangs Copse Wood Way



T7 Oak

Survey comments: No notable defects. Crown in close proximity to approved house outline and requires lateral pruning to manage growth. Works to this tree also noted as part of planning application report.

Recommendation:

- Reduce southern crown laterally from 6m to 4m
- Reduce western crown laterally from 7m to 4m
- Crown lift to give a ground clearance of 6m over site. This must be done pruning only secondary limbs, and none greater in diameter than 100mm.

Photo: T7



T8 Oak

Survey comments: Tree heavily suppressed and one sided due to presence of T9. T9 a much better tree and if T8 removed, T9 will fill gap and continue to grow as a quality specimen.

Recommendation:

- Fell to ground level.

Photo: T8 and T9 – note T8 (right hand tree) being suppressed by T9



T9 Oak

Survey comments: No notable defects. Dead wood noted in crown.

Recommendation:

- Remove deadwood (exempt from TPO)

G10 Hornbeam (only section shown on plan)

Survey comments: Basal decay at ground level due to past coppicing.

Recommendation:

- Reduce height from 20 to 10m.

Photo: decay at base of G10



I hope this is of assistance to you, however should you have any queries please do not hesitate to contact me.

Best regards

Handwritten signature of Glen Harding in blue ink.

Glen Harding MICFor, MSc (Forestry), MArborA
For and on behalf of GHA Trees

