

Window Elevation Details

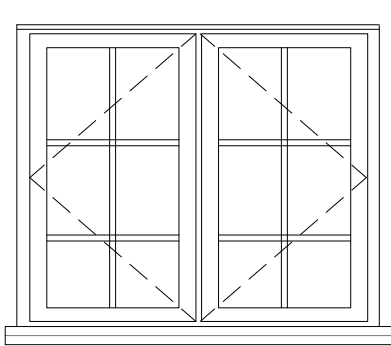

EW101 Elevation
1:25

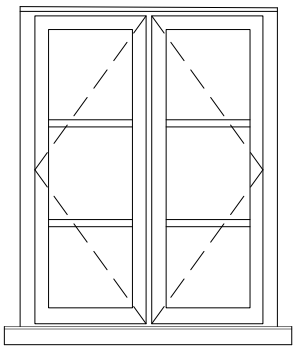

EW102 Elevation
1:25

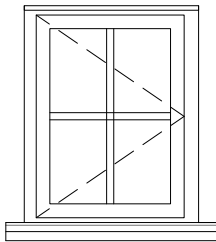

EW103 Elevation
1:25

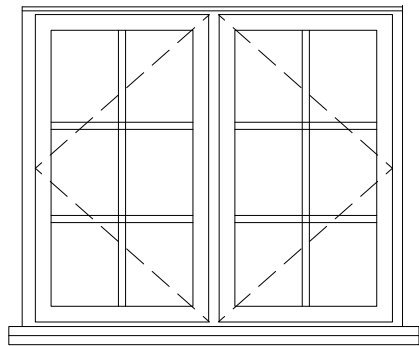

EW104 Elevation
1:25

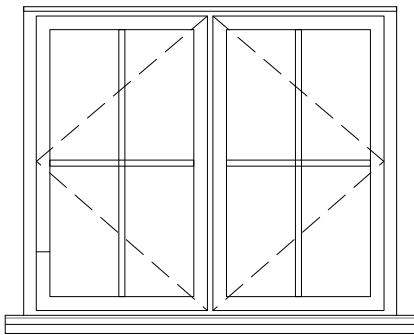

EW105 Elevation
1:25

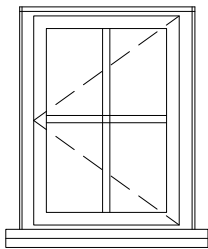

EW106 Elevation
1:25

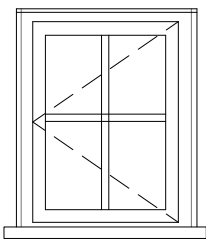

EW107 Elevation
1:25

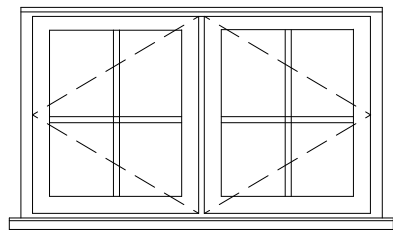

EW108 Elevation
1:25

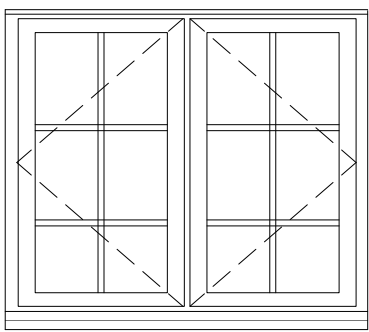

EW109 Elevation
1:25

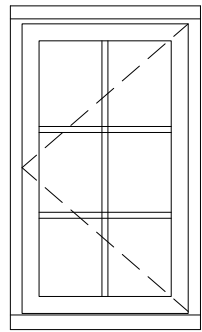

EW110 Elevation
1:25

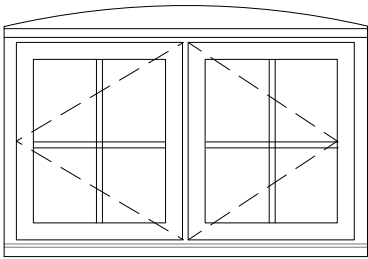

EW01 Elevation
1:25

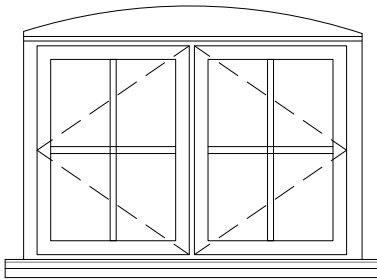

EW02 Elevation
1:25

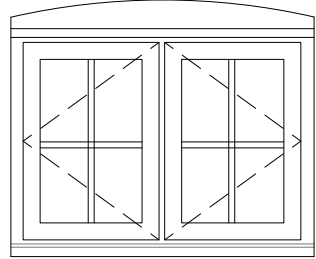

EW03 Elevation
1:25

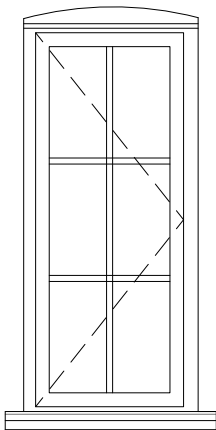

EW04 Elevation
1:25

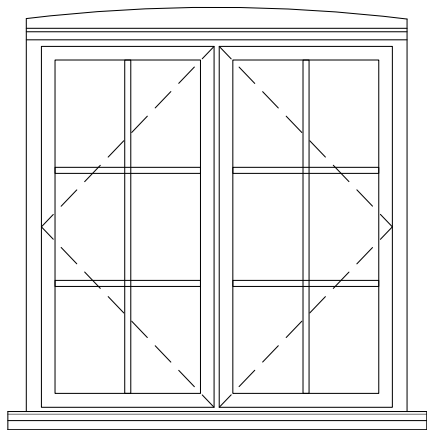

EW05 Elevation
1:25

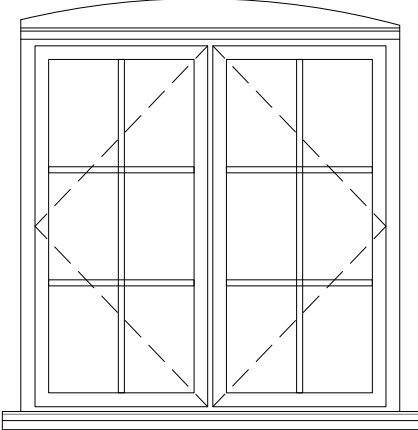

EW06 Elevation
1:25

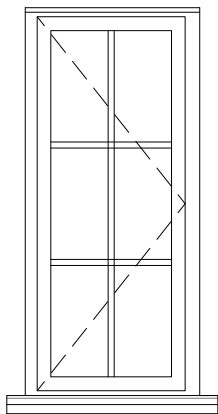

EW07 Elevation
1:25

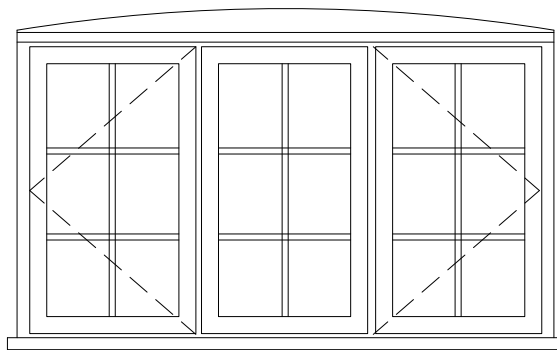

EW08 Elevation
1:25

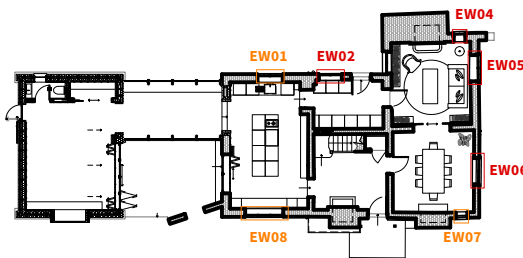

Ground Floor Location Diagram

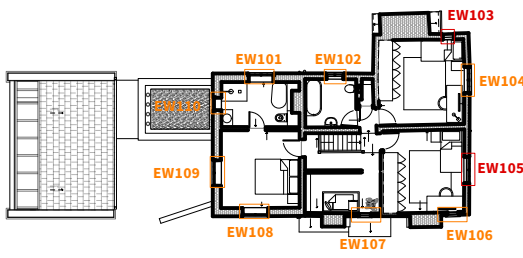

First Floor Location Diagram

EW0 - Window Refurbished
EW0 - Window Replaced (See 1:5 Details)

Hillingdon Council
Decision notice 11580/APP/2021/3314
Condition 6

Prior to installation of the new timber windows to the existing building, scaled detailed sections showing joinery, framing and glazing arrangement of the windows shall be submitted to and approved in writing by the Local Planning Authority. The drawings shall be no more than 1:10 in scale. Works shall be carried out in accordance with the approved details and maintained thereafter.

REASON: To preserve the special architectural and/or historic interest and setting of the listed building, in accordance to policy HE1 of Hillingdon's Local Plan: Part 1 (November 2012), policies DMHB 1 and 2 of the Hillingdon's Local Plan: Part 2 (January 2020), The London Plan (2021) and the Planning (Listed Buildings and Conservation Areas) Act 1990

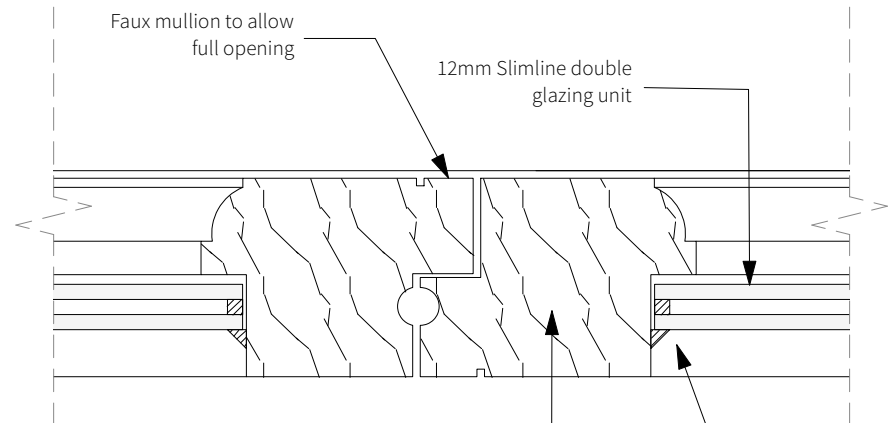

Replacement Window Mullion Plan
1:2

45mm x 50mm rebated, either opening or fixed light, frame with ovolo moulding and capillary groove in linseed putty

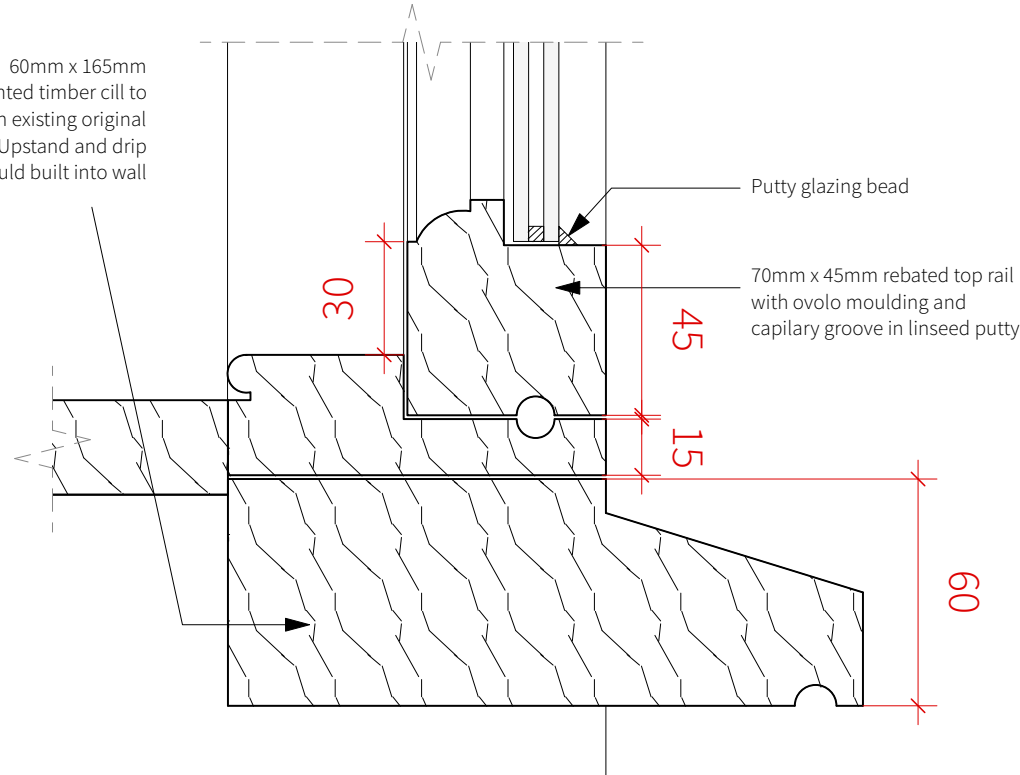
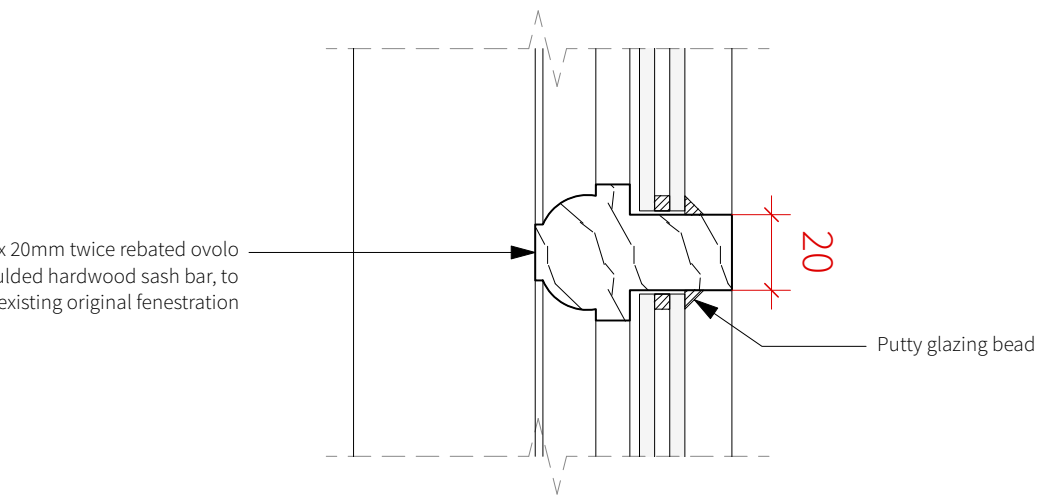
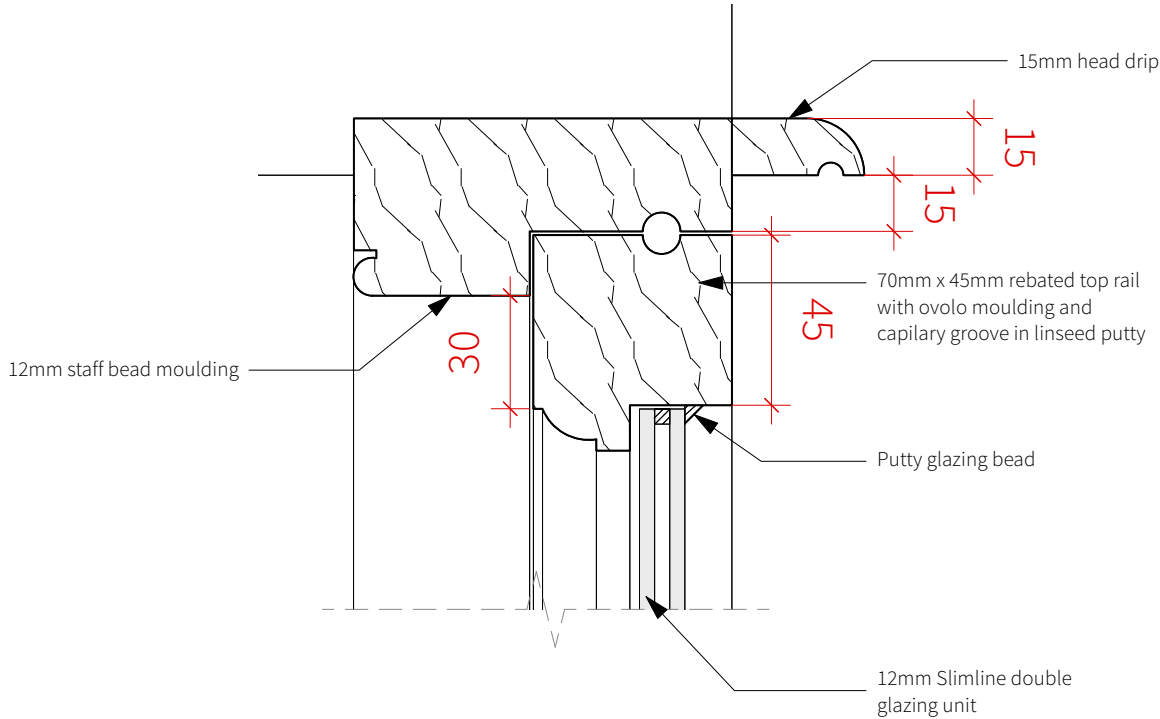

Window Detail Sections
1:2

Planning_Drawings.

Client: Mr & Mrs Thevan

Project: 188_Jackets Lane

Scale: Various @ A2

Date: 06/06/2023

721_Conditions_Window details

Unit 2, Foundry Mews / Barnes / London / SW13 9AZ