

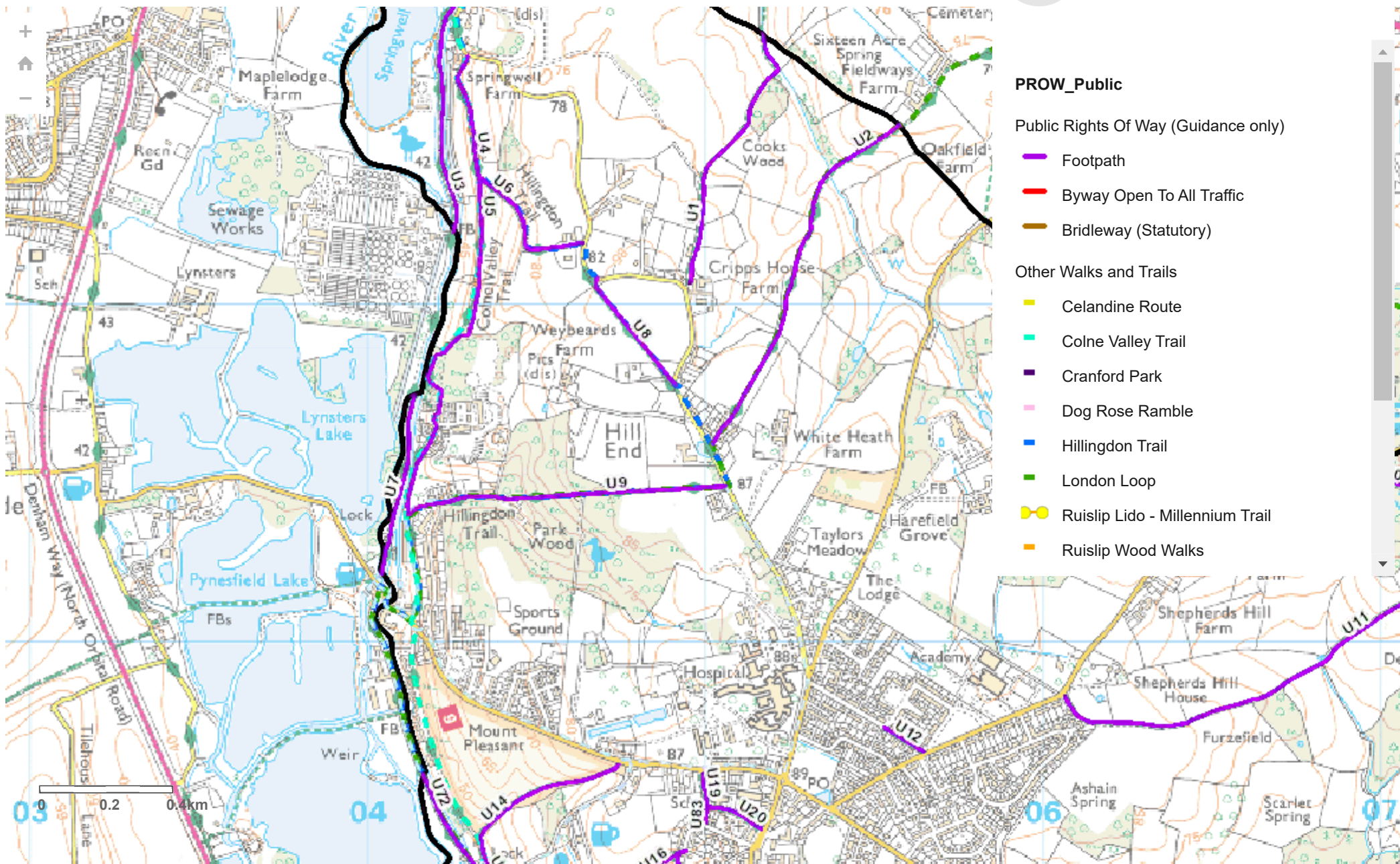

Public Rights Of Way



APPENDIX 5

Cycle Isochrone

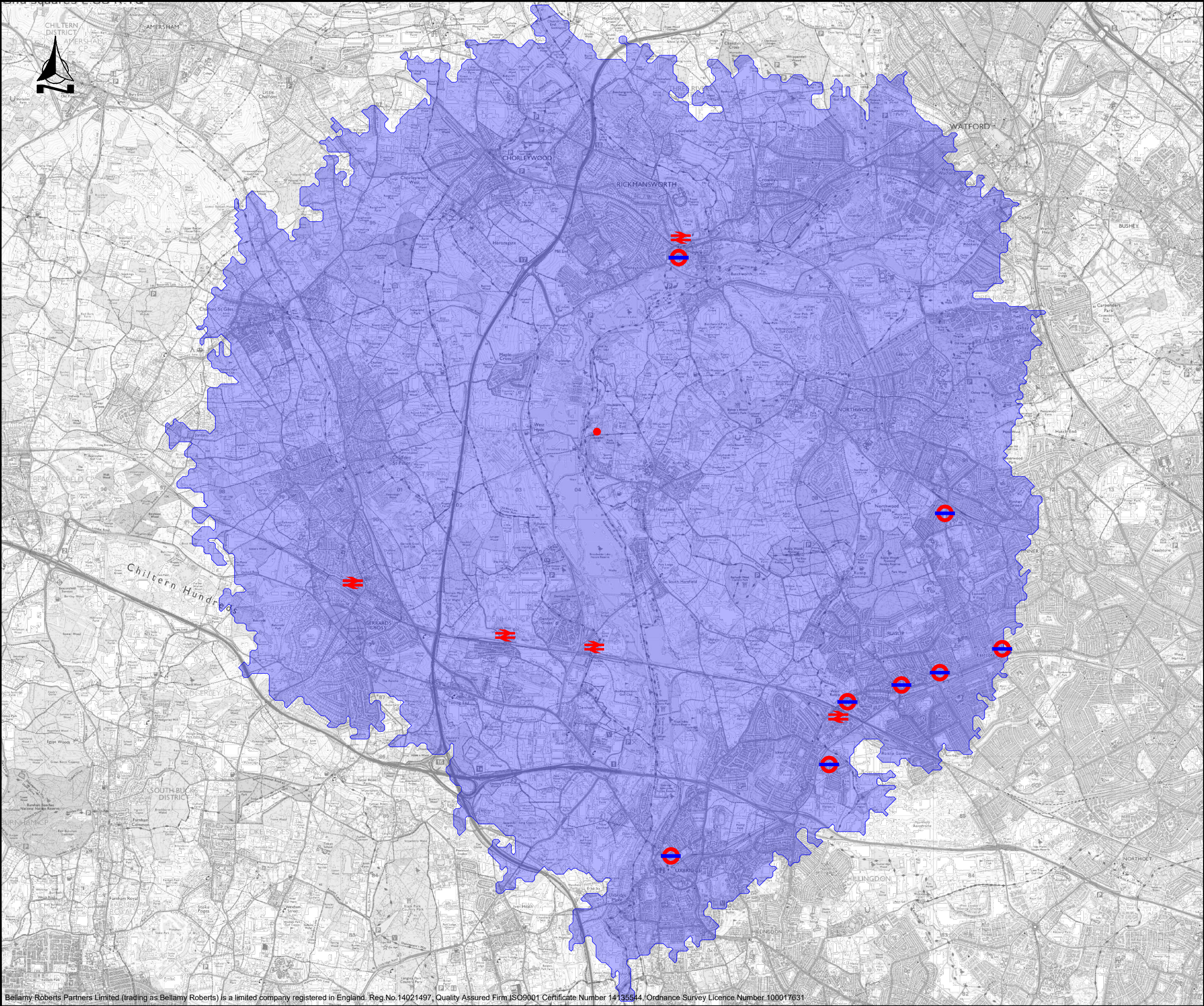

Notes

Cycle Isochrones

8km

Site Location

Train Station

Underground Station

Bellamy Roberts
Clover House
Western Lane
Odiham
Hampshire, RG29 1TU
Tel: 01256 703355
Email: info@bellamyroberts.co.uk

CLIENT
Ms Nye, Mr Rashkov & Mrs Merdinyan

PROJECT
Chandighra, Summerhouse Lane, Harefield

TITLE
Cycle Isochrone

DRAWN BY MB	DESIGN BY -	CHK BY IR
DATE 28/03/23	DRAWING No. 5893 / 303	
SCALE NTS @ A3	REV No.	

APPENDIX 6

Bus Route Plan

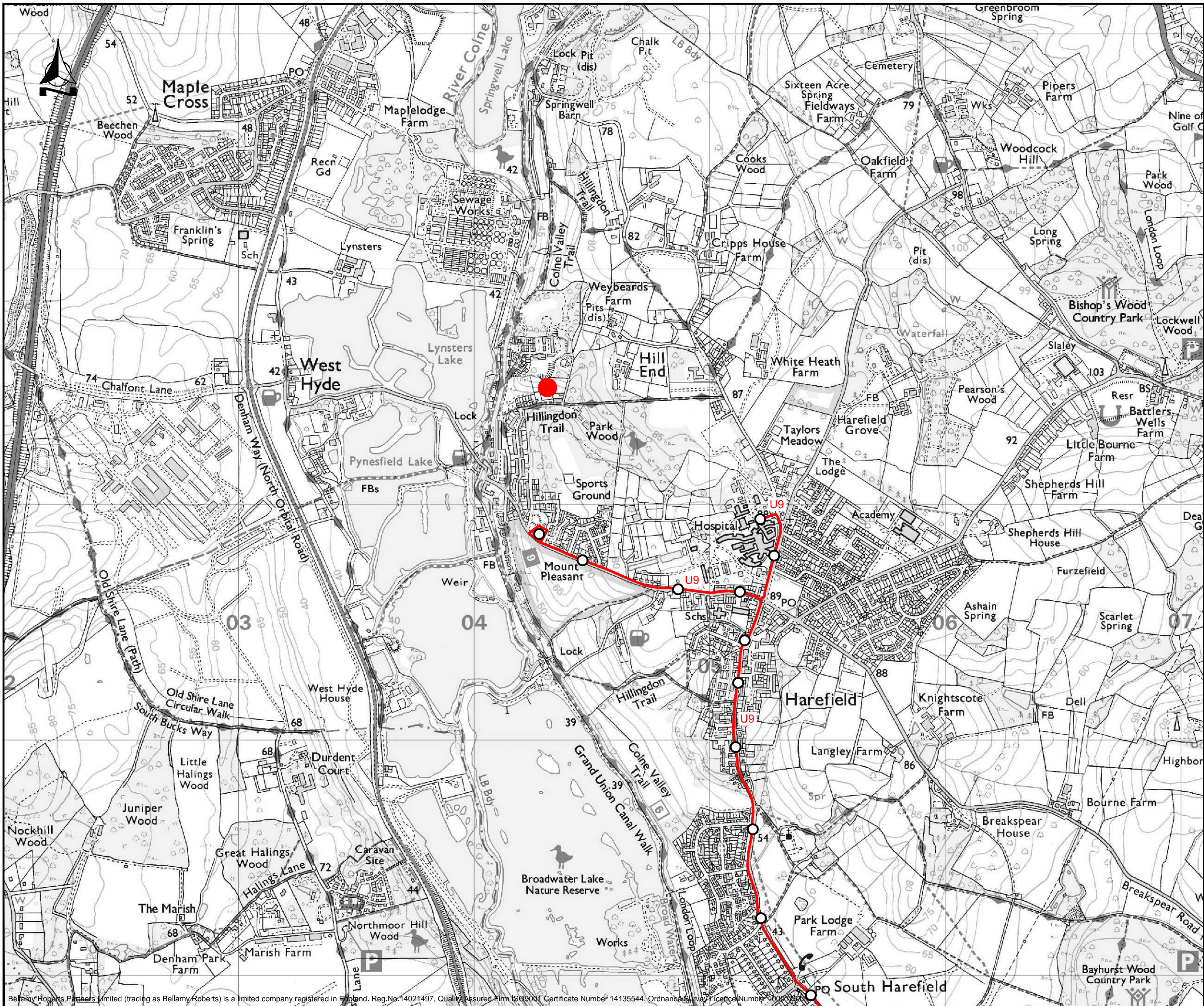

Notes

- Site
- Bus Stop
- Bus Route U9



Bellamy Roberts
Clover House
Western Lane
Odiham
Hampshire, RG29 1TU
Tel: 01256 703355
Email: info@bellamyroberts.co.uk

CLIENT
Ms Nye, Mr Rashkov & Mrs Merdinyan
PROJECT
Chandighra, Summerhouse Lane, Harefield
TITLE
Bus Routes

DRAWN BY MB	DESIGN BY -	CHK BY IR
DATE 28/03/23	DRAWING No. 5893 / 304	REV No. -
SCALE NTS @ A3		

APPENDIX 7

Proposed Site Layout Plan

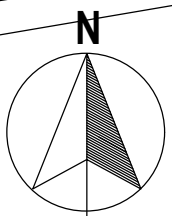
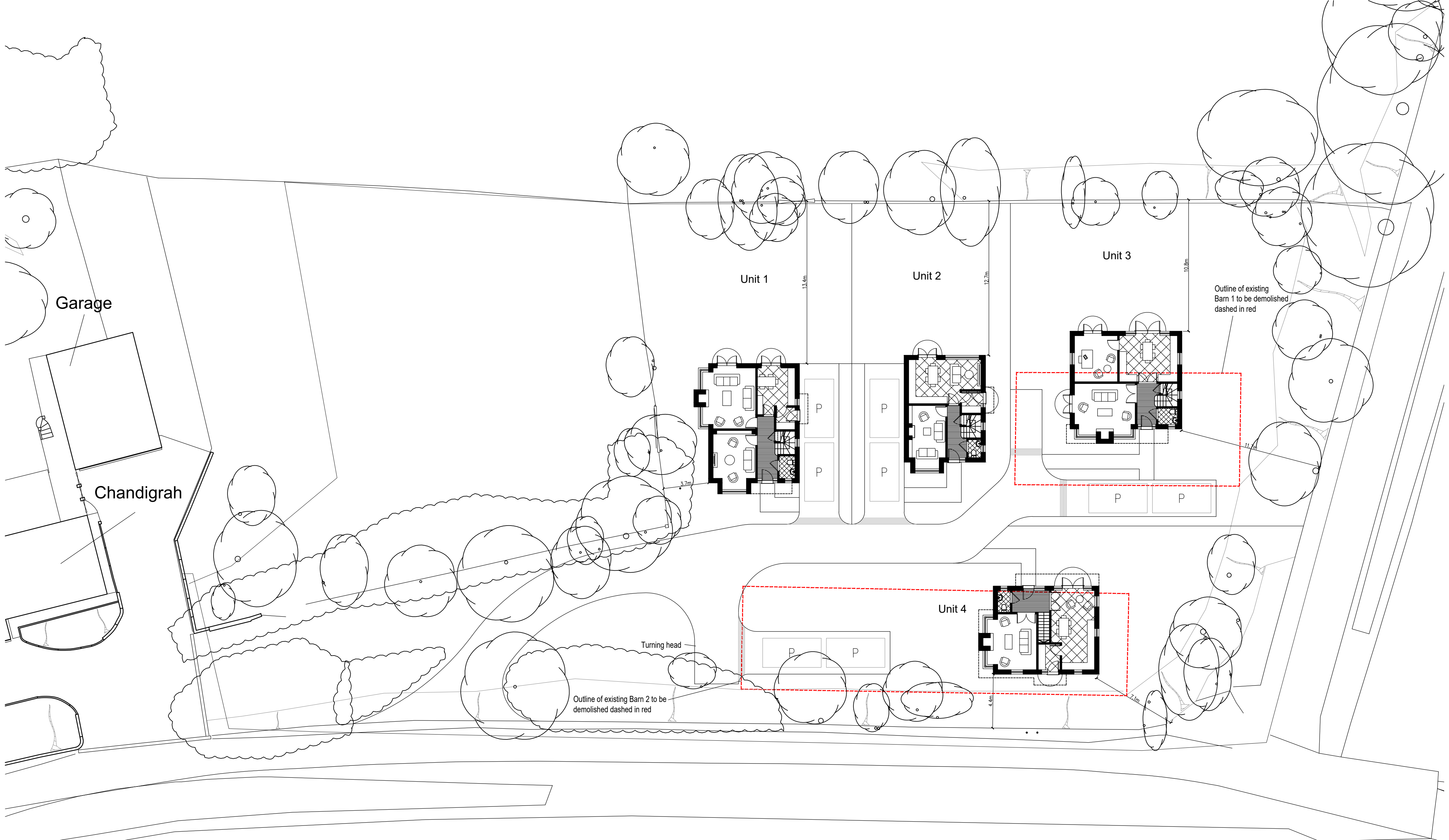

Proposed Site Plan
Initial Application - Option 1
Scale 1:200

MICHAEL CONOLEY ASSOCIATES CHARTERED ARCHITECTS		
PROJECT: Chandigrah, Summerhouse Lane, Harefield, UB9 6HS	SCALE: 1:200	DATE: 08.23
DRAWING TITLE: Proposed Site Plan Initial Application - Option 1		PAPER SIZE: A2
DRAWING NUMBER: 1682/SP-05		

APPENDIX 8

Swept Path Analysis

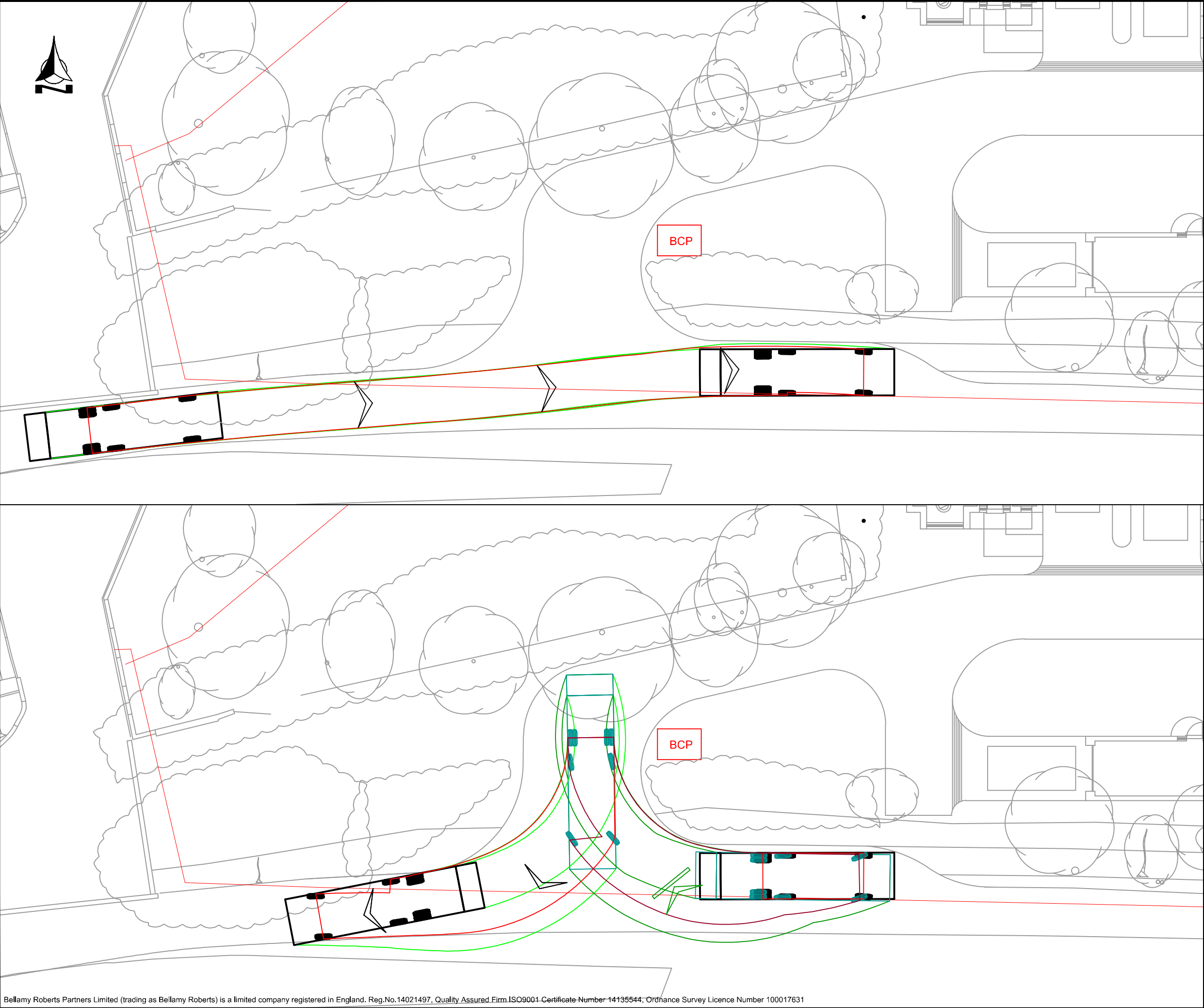

Notes

Phoenix 2-23W (with Elite 2 6x2MS chassis)
Overall Length 10.595m
Overall Width 2.530m
Overall Body Height 3.205m
Min Body Ground Clearance 0.410m
Track Width 2.500m
Lock to lock time 4.00s
Kerb to Kerb Turning Radius 10.150m

B	Site and tracking updated	MB	15/08/23	IR
A	New site, tracking and access updated	MB	10/08/23	IR
REVISION	AMENDMENT	DRN	DATE	CHK

Bellamy Roberts
Clover House
Western Lane
Odiham
Hampshire, RG29 1TU
Tel: 01256 703355
Email: info@bellamyroberts.co.uk

CLIENT	Ms Nye, Mr Rashkov & Mrs Merdinyan
PROJECT	Chandighrah, Summerhouse Lane, Harefield
TITLE	Refuse Track

DRAWN BY	MB	DESIGN BY	-	CHK BY	MT
DATE	25/05/23	DRAWING No.	5893 / 201	REV No.	B
SCALE	1:200 @ A3				

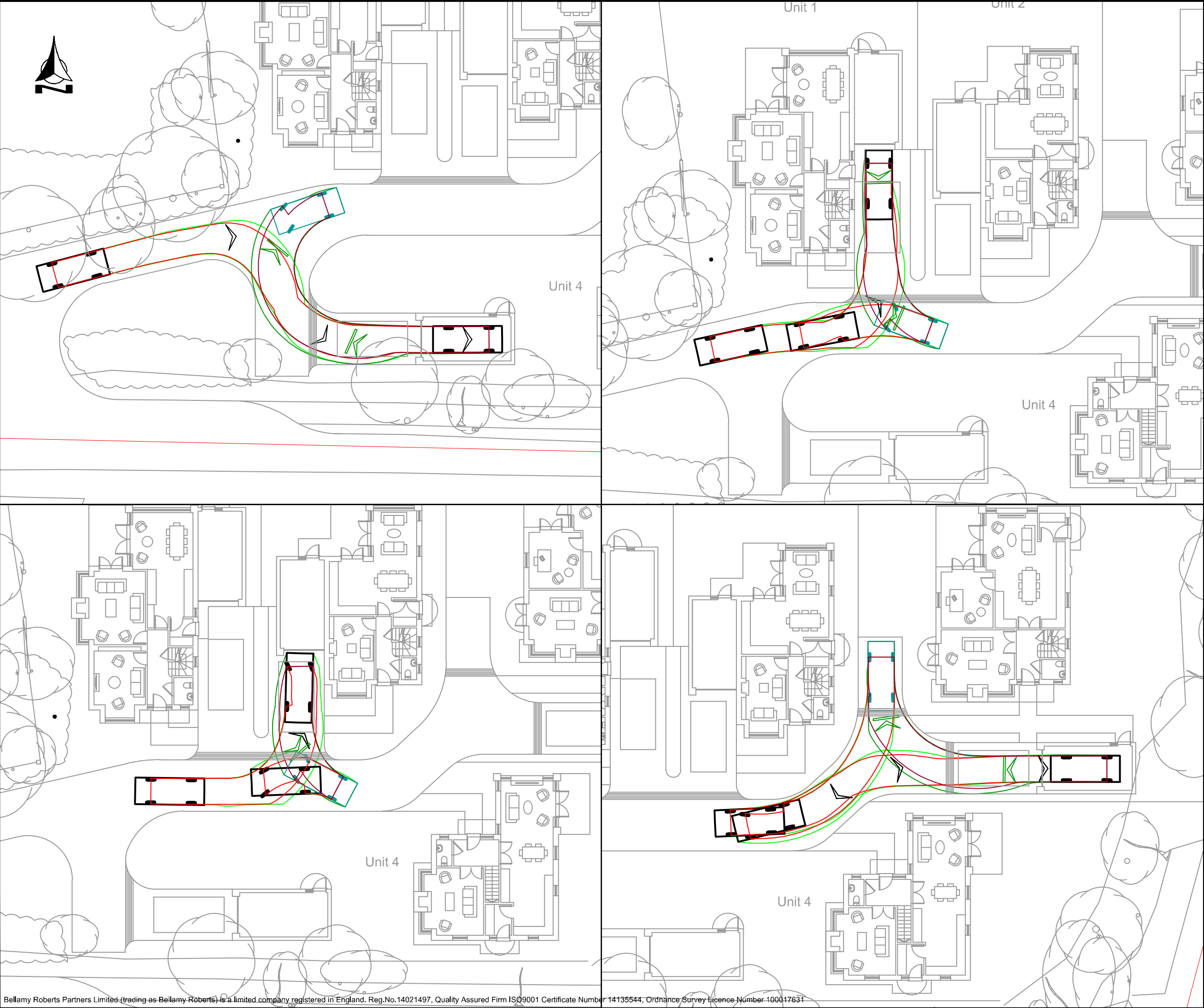

Notes

4.71

0.883 2.755

Estate Car (2006)

Overall Length 4.710m

Overall Width 1.804m

Overall Body Height 1.442m

Min Body Ground Clearance 0.207m

Max Track Width 1.756m

Lock to lock time 4.005

Kerb to Kerb Turning Radius 5.950m

B	Site and tracking updated	MB	15/08/23	IR
A	Site and tracking updated	MB	10/08/23	IR
REVISION	AMENDMENT	DRN	DATE	CHK

Bellamy Roberts

Clover House

Western Lane

Odiham

Hampshire, RG29 1TU

Tel: 01256 703355

Email: info@bellamyroberts.co.uk

CLIENT

Ms Nye, Mr Rashkov & Mrs Merdinyan

PROJECT

Chandighrah, Summerhouse Lane, Harefield

TITLE

Car Driveway Track

DRAWN BY	MB	DESIGN BY	-	CHK BY	MT
DATE	25/05/23	DRAWING No.	5893 / 202		REV No.
SCALE	1:250 @ A3				B

APPENDIX 9

TRICS Printout

Calculation Reference: AUDIT-200601-230601-0634

TRIP RATE CALCULATION SELECTION PARAMETERS:

Land Use : 03 - RESIDENTIAL
Category : A - HOUSES PRIVATELY OWNED
TOTAL VEHICLES

Selected regions and areas:

02	SOUTH EAST	
	BO BEDFORD	1 days
	HF HERTFORDSHIRE	1 days
	KC KENT	1 days
	MW MEDWAY	1 days
03	SOUTH WEST	
	DC DORSET	1 days
04	EAST ANGLIA	
	NF NORFOLK	2 days
	SF SUFFOLK	1 days
06	WEST MIDLANDS	
	ST STAFFORDSHIRE	1 days
10	WALES	
	VG VALE OF GLAMORGAN	1 days

This section displays the number of survey days per TRICS® sub-region in the selected set

Primary Filtering selection:

This data displays the chosen trip rate parameter and its selected range. Only sites that fall within the parameter range are included in the trip rate calculation.

Parameter: No of Dwellings
Actual Range: 8 to 30 (units:)
Range Selected by User: 6 to 30 (units:)

Parking Spaces Range: All Surveys Included

Parking Spaces per Dwelling Range: All Surveys Included

Bedrooms per Dwelling Range: All Surveys Included

Percentage of dwellings privately owned: All Surveys Included

Public Transport Provision:

Selection by: Include all surveys

Date Range: 01/01/15 to 09/11/22

This data displays the range of survey dates selected. Only surveys that were conducted within this date range are included in the trip rate calculation.

Selected survey days:

Monday	2 days
Tuesday	1 days
Wednesday	6 days
Thursday	1 days

This data displays the number of selected surveys by day of the week.

Selected survey types:

Manual count	9 days
Directional ATC Count	1 days

This data displays the number of manual classified surveys and the number of unclassified ATC surveys, the total adding up to the overall number of surveys in the selected set. Manual surveys are undertaken using staff, whilst ATC surveys are undertaken using machines.

Selected Locations:

Edge of Town	10
--------------	----

This data displays the number of surveys per main location category within the selected set. The main location categories consist of Free Standing, Edge of Town, Suburban Area, Neighbourhood Centre, Edge of Town Centre, Town Centre and Not Known.

Selected Location Sub Categories:

Residential Zone	10
------------------	----

This data displays the number of surveys per location sub-category within the selected set. The location sub-categories consist of Commercial Zone, Industrial Zone, Development Zone, Residential Zone, Retail Zone, Built-Up Zone, Village, Out of Town, High Street and No Sub Category.

Inclusion of Servicing Vehicles Counts:

Servicing vehicles Included	1 days - Selected
Servicing vehicles Excluded	9 days - Selected

Secondary Filtering selection:

Use Class:

C3	10 days
----	---------

This data displays the number of surveys per Use Class classification within the selected set. The Use Classes Order (England) 2020 has been used for this purpose, which can be found within the Library module of TRICS®.

Population within 500m Range:

All Surveys Included

Population within 1 mile:

1,001 to 5,000	1 days
5,001 to 10,000	1 days
10,001 to 15,000	5 days
15,001 to 20,000	1 days
20,001 to 25,000	2 days

This data displays the number of selected surveys within stated 1-mile radii of population.

Population within 5 miles:

5,001 to 25,000	1 days
25,001 to 50,000	3 days
50,001 to 75,000	1 days
75,001 to 100,000	1 days
125,001 to 250,000	4 days

This data displays the number of selected surveys within stated 5-mile radii of population.

Car ownership within 5 miles:

0.6 to 1.0	3 days
1.1 to 1.5	7 days

This data displays the number of selected surveys within stated ranges of average cars owned per residential dwelling, within a radius of 5-miles of selected survey sites.

Travel Plan:

Yes	4 days
No	6 days

This data displays the number of surveys within the selected set that were undertaken at sites with Travel Plans in place, and the number of surveys that were undertaken at sites without Travel Plans.

PTAL Rating:

No PTAL Present	10 days
-----------------	---------

This data displays the number of selected surveys with PTAL Ratings.

Covid-19 Restrictions	Yes	At least one survey within the selected data set was undertaken at a time of Covid-19 restrictions
-----------------------	-----	--

LIST OF SITES relevant to selection parameters

1	BO-03-A-01 CARNOUSTIE DRIVE BEDFORD GREAT DENHAM Edge of Town Residential Zone Total No of Dwellings: <i>Survey date: THURSDAY</i>	DETACHED HOUSES 30 15/10/20	BEDFORD	<i>Survey Type: MANUAL</i>
2	DC-03-A-10 ADDISON CLOSE GILLINGHAM Edge of Town Residential Zone Total No of Dwellings: <i>Survey date: WEDNESDAY</i>	MIXED HOUSES 26 09/11/22	DORSET	<i>Survey Type: MANUAL</i>
3	HF-03-A-04 HOLMSIDE RISE WATFORD SOUTH OXHEY Edge of Town Residential Zone Total No of Dwellings: <i>Survey date: TUESDAY</i>	TERRACED HOUSES 8 08/06/21	HERTFORDSHIRE	<i>Survey Type: MANUAL</i>
4	KC-03-A-09 WESTERN LINK FAVERSHAM DAVINGTON Edge of Town Residential Zone Total No of Dwellings: <i>Survey date: WEDNESDAY</i>	MIXED HOUSES & FLATS 14 09/06/21	KENT	<i>Survey Type: MANUAL</i>
5	MW-03-A-02 OTTERHAM QUAY LANE RAINHAM Edge of Town Residential Zone Total No of Dwellings: <i>Survey date: MONDAY</i>	MIXED HOUSES 19 06/06/22	MEDWAY	<i>Survey Type: MANUAL</i>
6	NF-03-A-03 HALING WAY THETFORD Edge of Town Residential Zone Total No of Dwellings: <i>Survey date: WEDNESDAY</i>	DETACHED HOUSES 10 16/09/15	NORFOLK	<i>Survey Type: MANUAL</i>
7	NF-03-A-10 HUNSTANTON ROAD HUNSTANTON Edge of Town Residential Zone Total No of Dwellings: <i>Survey date: WEDNESDAY</i>	MIXED HOUSES & FLATS 17 12/09/18	NORFOLK	<i>Survey Type: DIRECTIONAL ATC COUNT</i>
8	SF-03-A-05 VALE LANE BURY ST EDMUNDS Edge of Town Residential Zone Total No of Dwellings: <i>Survey date: WEDNESDAY</i>	DETACHED HOUSES 18 09/09/15	SUFFOLK	<i>Survey Type: MANUAL</i>
9	ST-03-A-08 SILKMORE CRESCENT STAFFORD MEADOWCROFT PARK Edge of Town Residential Zone Total No of Dwellings: <i>Survey date: WEDNESDAY</i>	DETACHED HOUSES 26 22/11/17	STAFFORDSHIRE	<i>Survey Type: MANUAL</i>

LIST OF SITES relevant to selection parameters (Cont.)

10	VG-03-A-01	SEMI -DETACHED & TERRACED	VALE OF GLAMORGAN
	ARTHUR STREET		
	BARRY		
	Edge of Town		
	Residential Zone		
	Total No of Dwellings:	12	
	Survey date: MONDAY	08/05/17	Survey Type: MANUAL

This section provides a list of all survey sites and days in the selected set. For each individual survey site, it displays a unique site reference code and site address; the selected trip rate calculation parameter and its value, the day of the week and date of each survey, and whether the survey was a manual classified count or an ATC count.

TRIP RATE for Land Use 03 - RESIDENTIAL/A - HOUSES PRIVATELY OWNED
 TOTAL VEHICLES
 Calculation factor: 1 DWELLS
 BOLD print indicates peak (busiest) period

Time Range	ARRIVALS			DEPARTURES			TOTALS		
	No. Days	Ave. DWELLS	Trip Rate	No. Days	Ave. DWELLS	Trip Rate	No. Days	Ave. DWELLS	Trip Rate
00:00 - 01:00									
01:00 - 02:00									
02:00 - 03:00									
03:00 - 04:00									
04:00 - 05:00									
05:00 - 06:00									
06:00 - 07:00									
07:00 - 08:00	10	18	0.067	10	18	0.239	10	18	0.306
08:00 - 09:00	10	18	0.200	10	18	0.394	10	18	0.594
09:00 - 10:00	10	18	0.100	10	18	0.228	10	18	0.328
10:00 - 11:00	10	18	0.150	10	18	0.161	10	18	0.311
11:00 - 12:00	10	18	0.200	10	18	0.183	10	18	0.383
12:00 - 13:00	10	18	0.250	10	18	0.228	10	18	0.478
13:00 - 14:00	10	18	0.183	10	18	0.211	10	18	0.394
14:00 - 15:00	10	18	0.144	10	18	0.189	10	18	0.333
15:00 - 16:00	10	18	0.267	10	18	0.183	10	18	0.450
16:00 - 17:00	10	18	0.244	10	18	0.111	10	18	0.355
17:00 - 18:00	10	18	0.361	10	18	0.206	10	18	0.567
18:00 - 19:00	10	18	0.261	10	18	0.139	10	18	0.400
19:00 - 20:00									
20:00 - 21:00									
21:00 - 22:00									
22:00 - 23:00									
23:00 - 24:00									
Total Rates:			2.427			2.472			4.899

This section displays the trip rate results based on the selected set of surveys and the selected count type (shown just above the table). It is split by three main columns, representing arrivals trips, departures trips, and total trips (arrivals plus departures). Within each of these main columns are three sub-columns. These display the number of survey days where count data is included (per time period), the average value of the selected trip rate calculation parameter (per time period), and the trip rate result (per time period). Total trip rates (the sum of the column) are also displayed at the foot of the table.

To obtain a trip rate, the average (mean) trip rate parameter value (TRP) is first calculated for all selected survey days that have count data available for the stated time period. The average (mean) number of arrivals, departures or totals (whichever applies) is also calculated (COUNT) for all selected survey days that have count data available for the stated time period. Then, the average count is divided by the average trip rate parameter value, and multiplied by the stated calculation factor (shown just above the table and abbreviated here as FACT). So, the method is: $COUNT/TRP*FACT$. Trip rates are then rounded to 3 decimal places.

The survey data, graphs and all associated supporting information, contained within the TRICS Database are published by TRICS Consortium Limited ("the Company") and the Company claims copyright and database rights in this published work. The Company authorises those who possess a current TRICS licence to access the TRICS Database and copy the data contained within the TRICS Database for the licence holders' use only. Any resulting copy must retain all copyrights and other proprietary notices, and any disclaimer contained thereon.

The Company accepts no responsibility for loss which may arise from reliance on data contained in the TRICS Database. [No warranty of any kind, express or implied, is made as to the data contained in the TRICS Database.]

Parameter summary

Trip rate parameter range selected: 8 - 30 (units:)
 Survey date range: 01/01/15 - 09/11/22
 Number of weekdays (Monday-Friday): 10
 Number of Saturdays: 0
 Number of Sundays: 0
 Surveys automatically removed from selection: 0
 Surveys manually removed from selection: 0

This section displays a quick summary of some of the data filtering selections made by the TRICS® user. The trip rate calculation parameter range of all selected surveys is displayed first, followed by the range of minimum and maximum survey dates selected by the user. Then, the total number of selected weekdays and weekend days in the selected set of surveys are shown. Finally, the number of survey days that have been manually removed from the selected set outside of the standard filtering procedure are displayed.



Clover House
Western Lane
Odiham
Hampshire
RG29 1TU
Tel: 01256 703355



Reg No 14021497. Registered Office: Clover House, Western Lane, Odiham, Hampshire RG29 1TU

Director:
IT Roberts MCIHT
Associate Director:
MJ Twinberrow BEng MCIHT
Consultant:
GD Bellamy BSc CEng MICE

Bellamy Roberts Partners Ltd.
(trading as Bellamy Roberts) is a
Limited Company registered in
England.