

PROPOSED SITE LAYOUT PLAN
Scale 1:200 @ A1

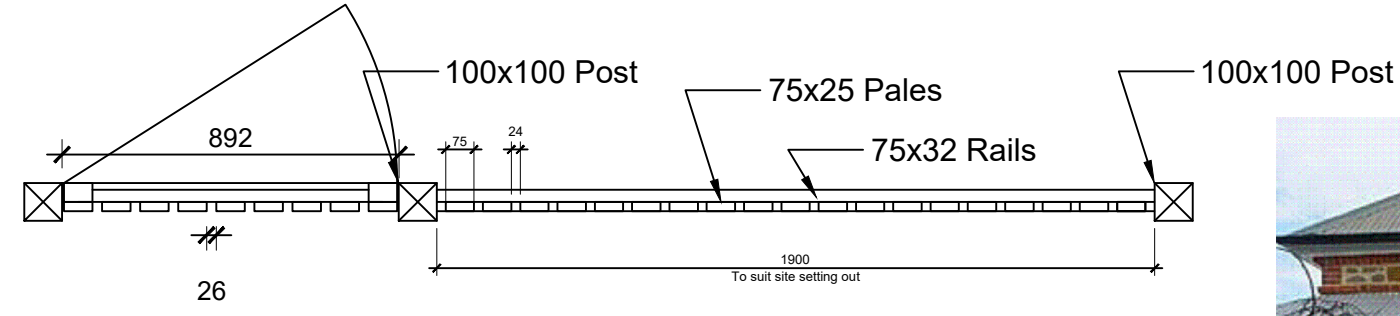
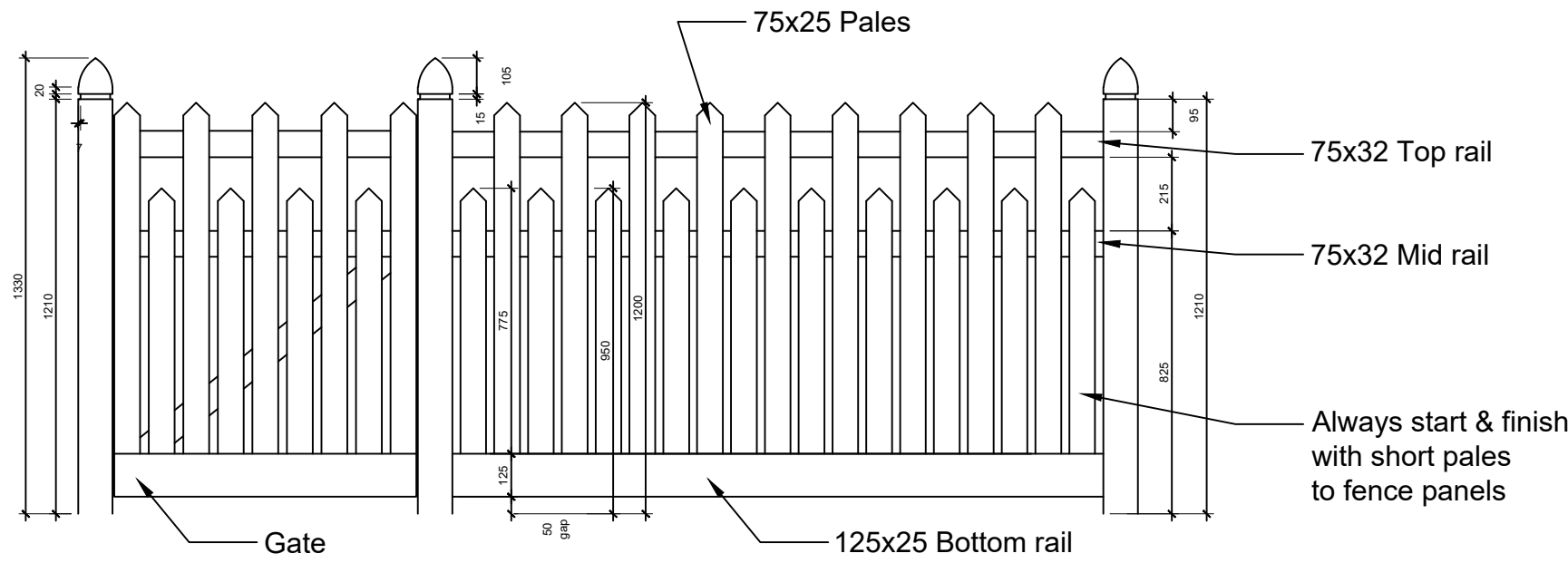

NEW PICKET FENCE

New picket fencing (design as above) to be constructed as shown, with 100 x100mm posts secured with softwood tapered cross braces running top and bottom. Finish to be painted White.

- Symbol indicates line of new picket fence
- Symbol indicates line of picket existing fence

PICKET FENCE REFERENCE



Lamp Post lantern
H = 2500mm, W = 700mm,
Max wattage 2no 60W/E27

- Symbol indicates lamp posts on plan
9no new

EXISTING ILLUMINATION.

All existing building and site illumination to be retained and supplemented with new as above.



FESTOON LIGHTING

(R65 rated connectable festoon harness)
3m lead included with every set
50cm spacing
Connect multiple sets together up to 100m.
Maximum of 5w LED per bulb

- Symbol indicates line of festoon lighting

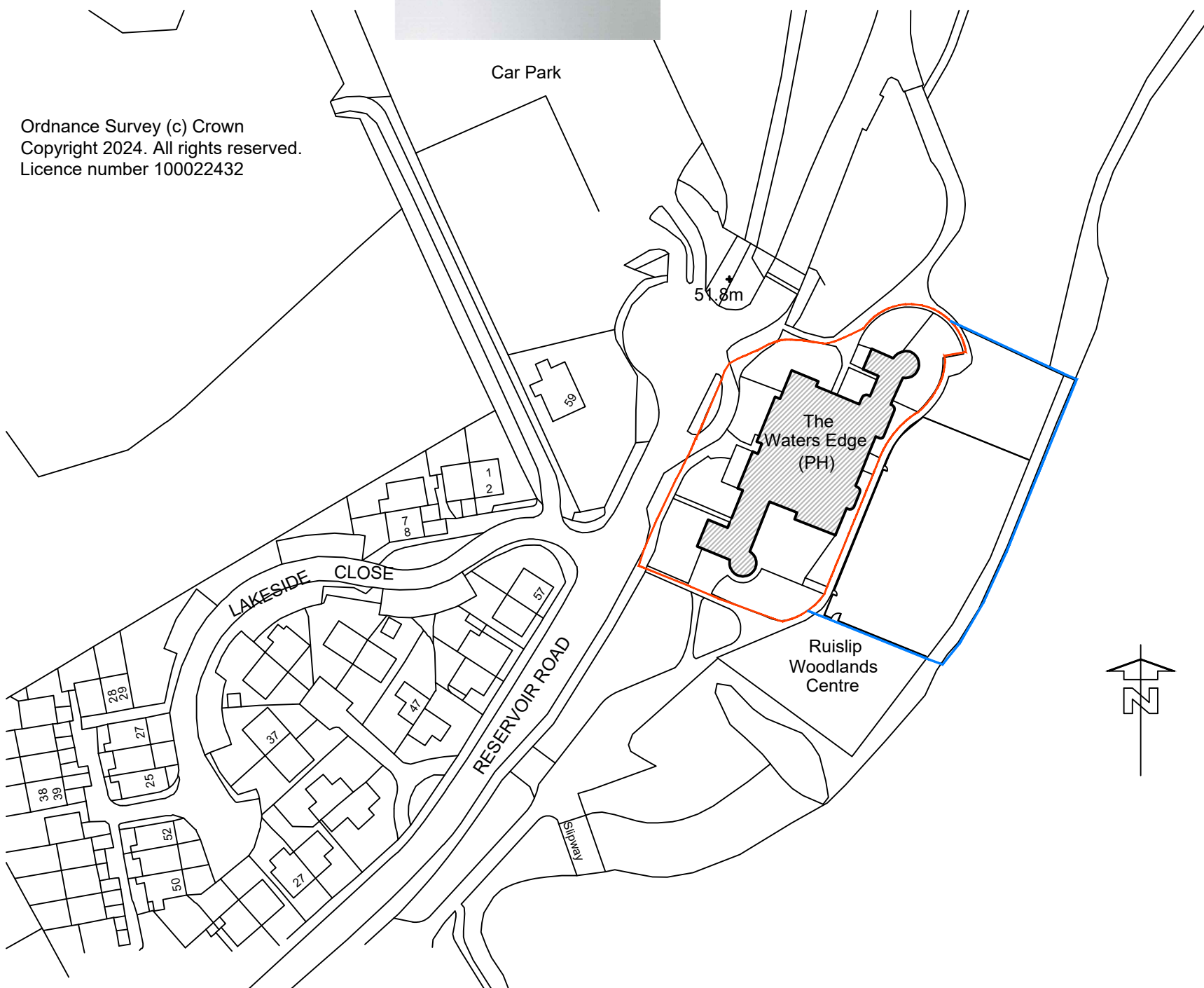

SITE LOCATION PLAN
Scale 1:1250 @ A1



B	Amendments made following Planners comments	SJC	15.08.24
A	Existing path retained,	GT	12.06.24
PEMBROOK design & project management <small>Sworders Court Yard, 19D North Street, Bishops Stortford, Herts. CM23 2LD Tel: 01279 433888, Fax: 01279 433889, E-Mail: pembrook@pembrook.co.uk Website: www.pembrook.co.uk</small>			
Client		Mitchells & Butlers	
Project		The Waters Edge Reservoir Road Ruislip HA4 7TY	
Drawing Title		Proposed site plans and site location plan	
Drawing No		3404-126	
Scale		1:500 & 1:200 & 1:1250 @ A1	
Date		24.04.23	
Drawn By		SC/GT	
Revision		B	