

EXISTING PLAN

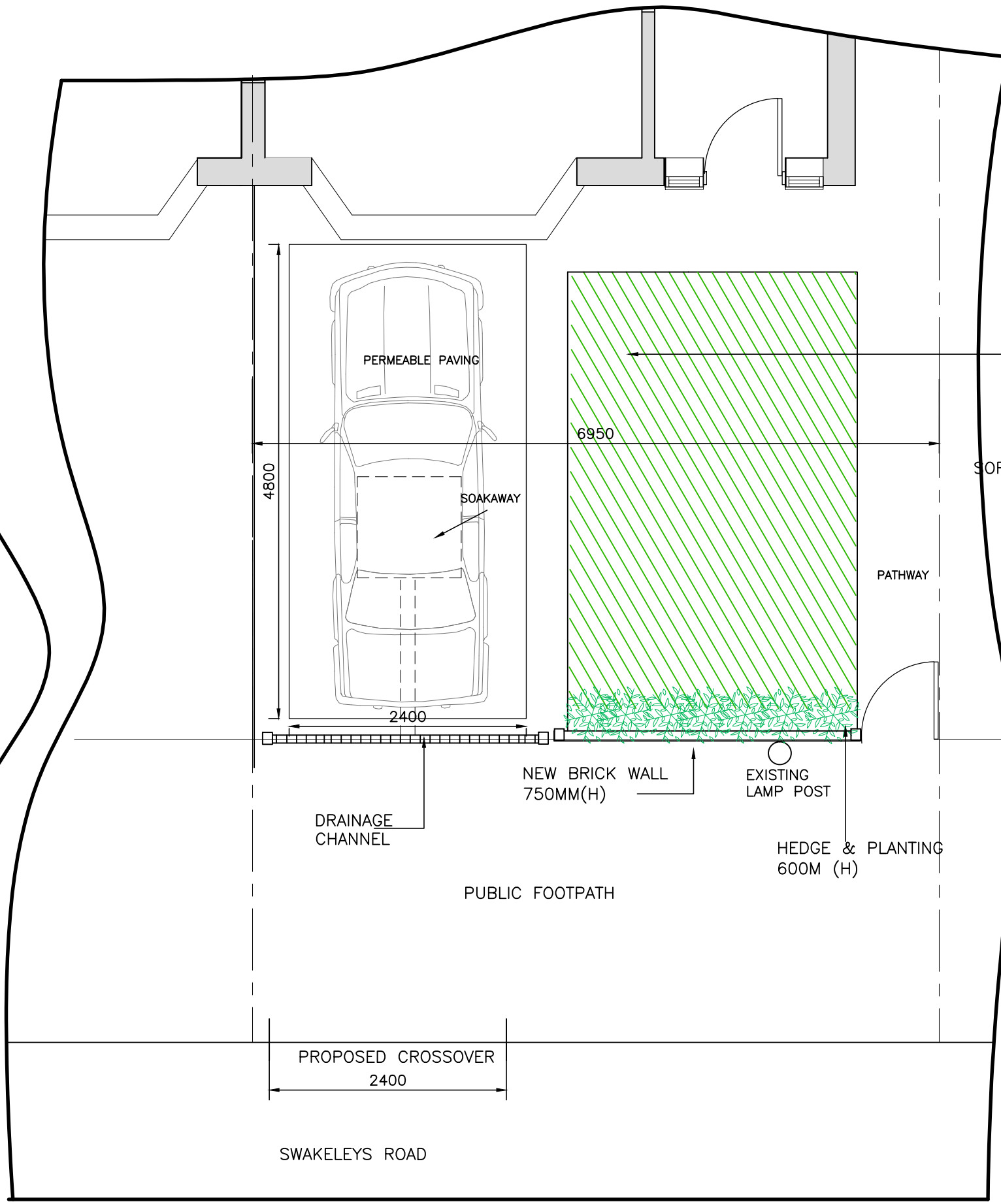

PROPOSED PLAN

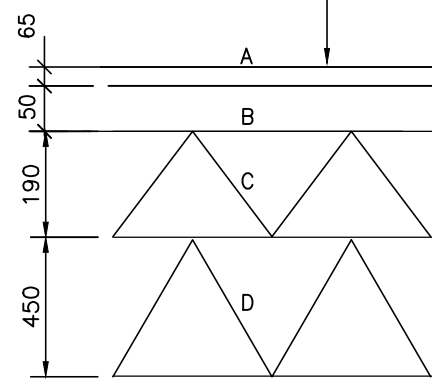

ANNUALLY – ESTABLISH A SEASONAL MAINTENANCE SCHEDULE THAT INCLUDES THE FOLLOWING:
• SWEEP ENTIRE PERMEABLE PAVING SURFACE WITH APPROPRIATE PREVENTATIVE SWEEPING DEVICES.
• REPLENISH JOINT AGGREGATE MATERIAL TO "LIP" OF PAVER

- A – 200x100x85 PERMEABLE BLOCK PAVIOURS
- B – 50mm COMPACTED THICKNESS SHARP SAND
- C – SUB-BASE – 190mm TYPE 1 DOT COMPACTED TO DOT SPECIFICATION FOR ROADS & BRIDGES ON WELL COMPACTED NATURAL OR GRANULAR SUB-GRADE
- D – SUB-BASE – 450mm TYPE 2 GRANULAR MATERIAL

CONSTRUCTION BUILD UP

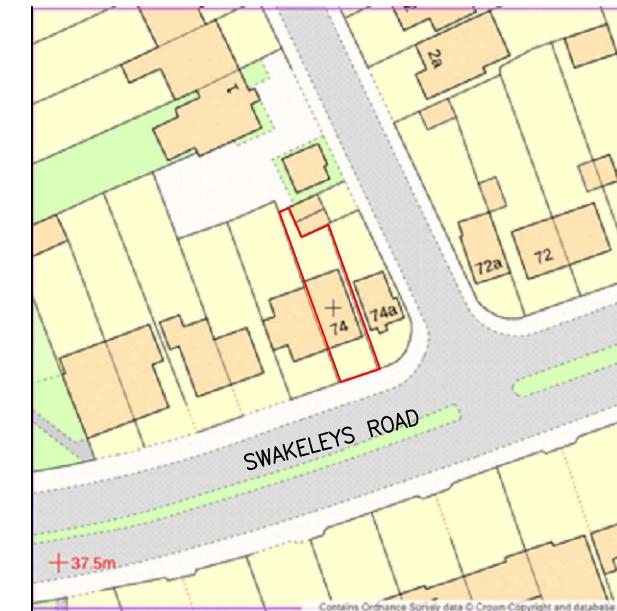
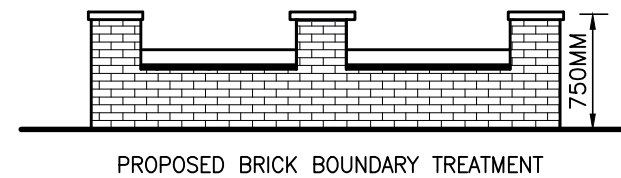
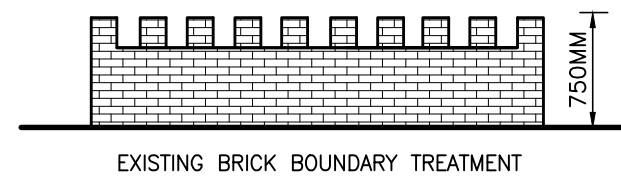

SITE LOCATION PLAN
1:1250

Rev	Description	Date
 <div>KDA Designs Ltd. Architectural & Structural Services T:020 8000 9433 M:0779 420253 kevin@kdadesigns.co.uk <small>This drawing is property of Mr Kevin D'Austin. The information is contains is copyright and is not to be copied or used without prior permission.</small></div>		
Project PROPOSED CROSSOVER 74 SWAKELEYS ROAD UXBRIDGE UB10		
Drawing CROSSOVER APPLICATION		
Drawn	KDA	Checked
Scale	1:50@A2	Date DEC 2025
Stage	Drg. No. 74SR/P01	Rev