



Copyright of this drawing is the property of Urban Edge Architecture Limited. It must not be reproduced or amended nor used in the execution of any works whether in conjunction with the proposed works for which it is prepared or otherwise without the express consent in writing of Urban Edge Architecture Limited.

Urban Edge Architecture Limited
One Scotgate Mews, Scotgate,
Stamford, Lincolnshire, PE9 2FX.

Tel. ++44 (0)1780 755 665
Fax. ++44 (0)1780 755 360

THIS DRAWING IS FOR PLANNING COMMENT ONLY AND IS **NOT TO BE USED FOR TENDER OR CONSTRUCTION**

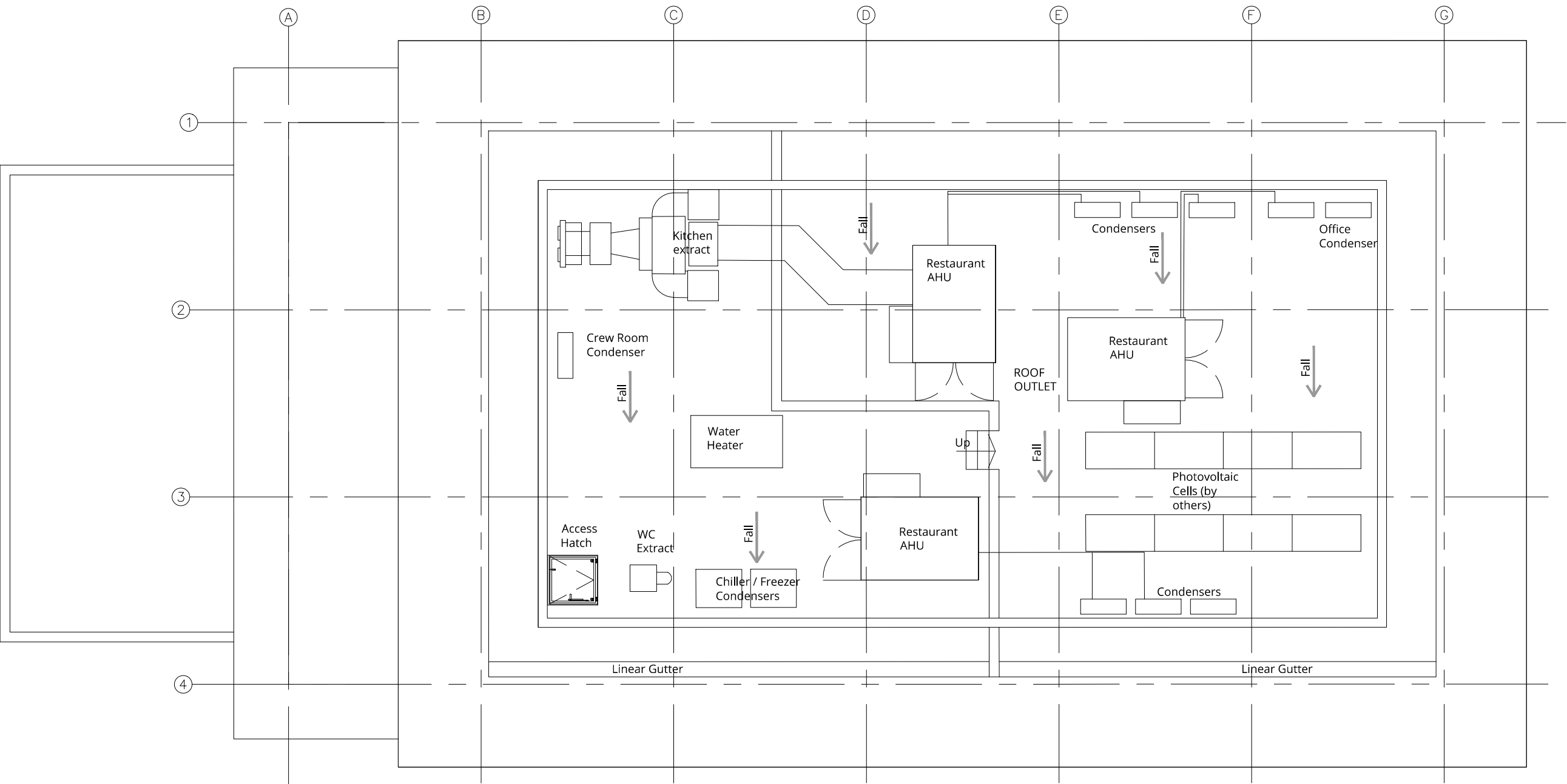

D00	ISSUED FORMALLY	18.05.2018
A01	PLAN ALTERATION	19.02.2018

Revision	Description	Date
----------	-------------	------



Client	SCOTTISH WIDOWS PROPERTY AUTHORISED CONTRACTUAL SCHEME 1
--------	---

Project	SOUTH RUISLIP DRIVE THRU
---------	-------------------------------------

Drawing	ROOF AS PROPOSED
---------	-----------------------------

Scale	1:100@ A3	Drawn	SS
Date	FEB 2018		

Project No.	Drawing No.	Revision
1829	URB DT[08] 20 01	D00

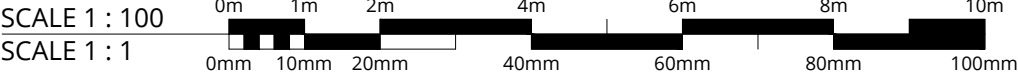

PLANNING