

Notes.

Drawing to be read in conjunction with designer risk register

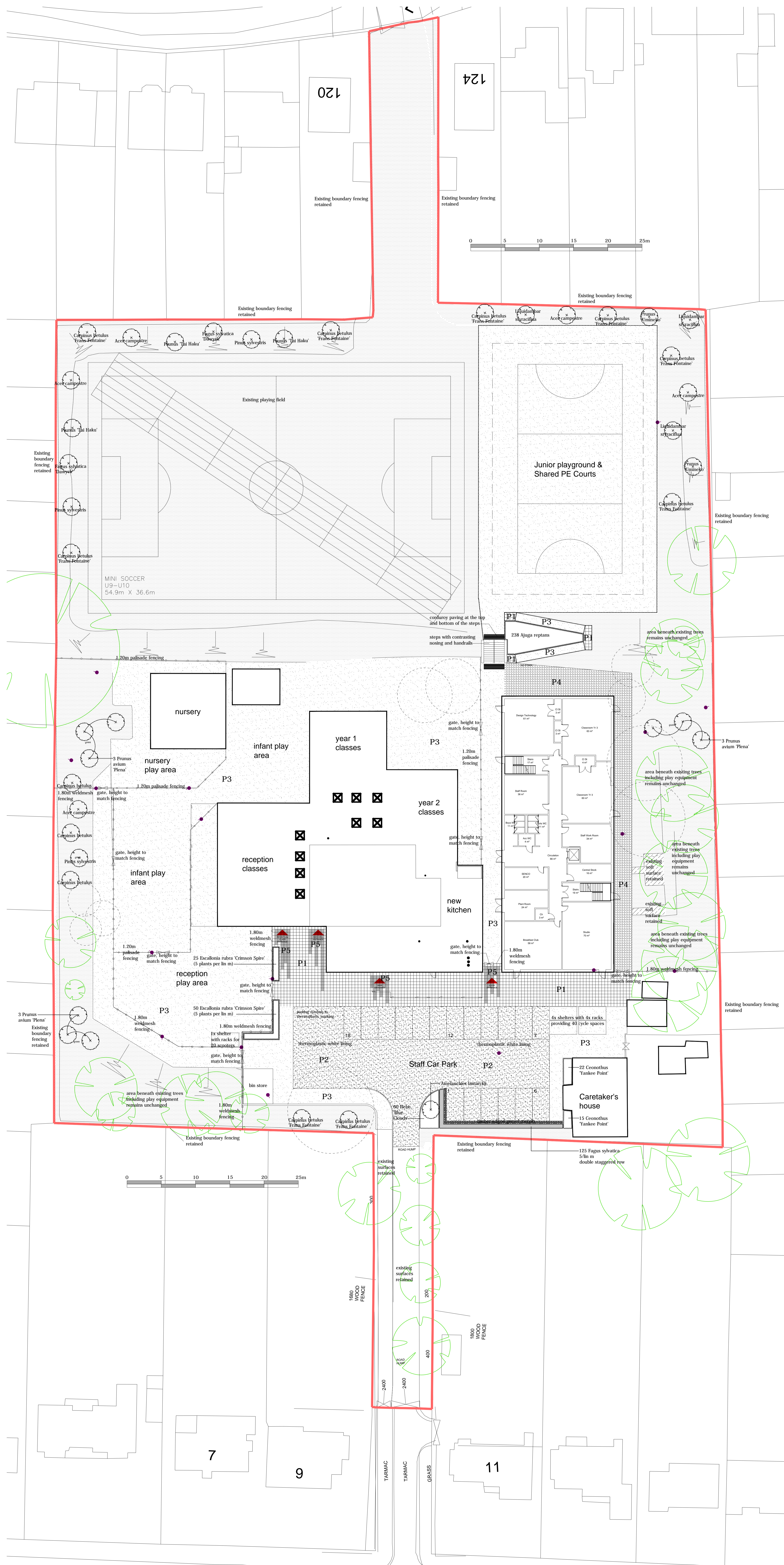

Hard Landscape Legend		Soft Landscape Legend	
<b>P1</b>	Paving: Concrete slab paving Colour: Natural. Size: 450x450mm		Existing tree -
<b>P2</b>	Surfacing - remediation of existing vehicular tarmac/asphalt surface where needed as part of the preparation of the surface for re-marking		Proposed tree - refer to planting schedule
<b>P3</b>	Surfacing - Pedestrian tarmac/asphalt Engineers specification		Planting - Shrubs Refer to plant schedule
<b>P4</b>	Surfacing - Reinforced grass surface Plastic cellular structure, with topsoil infill, grass seeded		Grass - Lawn Refer to plant schedule
<b>P5</b>	Paving: Concrete slab paving Colour: Charcoal. Size: 450x450mm		Planting - Hedge Refer to plant schedule
	Edging Concrete pin kerb 914 x 150 x 50mm		
	Edging Timber edging 150 x 25mm, pressure impregnated softwood with timber stakes at 1.5m centres		
	Fencing 1.80m height weldmesh fencing		
	Fencing 1.2m height timber palisade fence		

- Notes:
- 1 Drainage: Refer to Engineers drawings and specification
  - 2 Highway / Civils works: Refer to Engineers drawings and specification
  - 3 Sub bases and foundations: Refer to Engineers drawings and specification
  - 4 Lighting: Refer to M&E Engineers drawings and specification
  - 5 Refer to Project Health and Safety File for locations and details of existing services
  - 6 Road marking whiteline: Refer to Engineers drawings and specification

Plant schedule Species	Size & Spec.	Spacing	No.
<b>Trees</b>			
Acer campestre	Standard 8-10 2.5-3m Ht, feathered	as shown	5
Azalea indica 'Lanarakii'	Standard 8-10 2.5-3m Ht, feathered	as shown	1
Carpinus betulus	Standard 8-10 2.5-3m Ht, feathered	as shown	3
Carpinus Frax Fontaine'	Standard 8-10 2.5-3m Ht, feathered	as shown	9
Fagus sylvatica 'Dawyck'	Standard 8-10 2.5-3m Ht, feathered	as shown	2
Liquidambar styraciflua	Standard 8-10 2.5-3m Ht, feathered	as shown	3
Pinus sylvestris	2.2-2.5m Ht, feathered	as shown	3
Prunus avium 'Piena'	Standard 8-10 2.5-3m Ht, feathered	as shown	9
Prunus 'Tai Haku'	Standard 8-10 2.5-3m Ht, feathered	as shown	3
Prunus 'Umbrako'	Standard 8-10 2.5-3m Ht, feathered	as shown	2
<b>Native Hedge</b>			
Fagus sylvatica	60-80cm bareroot	5/lin m	125
<b>Ornamental Hedge</b>			
Escallonia rubra		5/lin m	75
'Crimson Spike'	60-80cm C10		
<b>Ornamental shrubs &amp; groundcover</b>			
Ajuga reptans	10-20cm C2	bushy	7/m2
Ceanothus 'Yankee Point'	20-30cm C3	bushy	5/m2
Hebe 'Blue Clouds'	30-40cm C3	bushy	5/m2
			37
			60
<b>Lawn - Hard wearing grass seed</b>			
	50% certified dwarf perennial ryegrass		
	40% certified slender creeping red fescue		
	10% certified common bentgrass		
	or similar approved		

Notes:

**Landscape Implementation Guidelines.**  
The approved hard and soft landscaping scheme for the whole site shall be carried out prior to occupation of the building or during the first planting season following the full completion of building works, whichever is sooner.

All planting and landscape operations shall comply with the requirements specified in BS 3936 (1992) Nursery Stock Part One, BS 4428 (1989) Code of Practice for General Landscape Operations (excluding hard surfaces) and BS8545 Trees from nursery to independence in the landscape.

Any plant species shown on the approved landscape scheme which within a period of 5 years from the completion of the development dies, is removed or in the opinion of the LPA becomes seriously damaged or diseased shall be replaced in the same place in the next planting season with identical species unless the LPA gives written consent to any variation.

**Proposed Tree Planting**  
Stock size proposed is as shown.  
Tree support shall be two softwood stakes @ 7.5cm diameter @ 230cm length and should be driven into the ground to knee-height with ties and horizontal cross support.  
Tree pit size to conform to BS8545 Trees from nursery to independence in the landscape.

**Proposed Shrub and Hedgerow Planting**  
Hedgerow planting to be planted as shown in the plant schedule, to be planted in the first available planting season following the occupation of the building or the completion of the development (whichever is sooner), in a minimum 450mm depth of clean topsoil, with a minimum of 90mm approved bark mulch applied.

**Proposed Seeding**  
Seeding to be carried out in the first available seeding season following the occupation of the building or the completion of the development (whichever is sooner), in a minimum 150mm depth of clean topsoil.

- Additional Notes:
- Existing trees and vegetation to be retained are to be protected during construction to BS 5837:2012
  - Any necessary tree works to be carried out by an approved tree surgeon to BS 3998.
  - Trees, hedges and shrubs shown to be retained on the approved plan shall not be damaged, uprooted, felled, topped or topped without the prior written consent of the local planning authority.
  - If any retained tree, hedge or shrub is removed or severely damaged during construction work, or is found to be seriously diseased or dying, another tree, hedge or shrub shall be planted at the same place and shall be of a size and species to be agreed in writing by the Local Planning Authority and shall be planted in the first planting season following the completion of the development or the occupation of the buildings, whichever is the earlier.

Revisions:		
P2	Tree species amended, additional trees added to southern, west and northern boundaries	ISSUED FOR PLANNING Jan 17
P1	ISSUED FOR PLANNING	Nov 16

Landscape Architect

**ijla**

M: 07906 477473 W: www.ijla.co.uk E: ian@ijla.co.uk

Contractors are not to scale from this drawing. All dimensions are to be checked on site. Any discrepancies, omissions and/or omissions between this drawing and information given elsewhere are to be reported to this office for clarification before proceeding.

STATUS: **PLANNING**

Project Title: **Warrender School, Hillingdon**

Drawing Title: **Landscape Plan**

Scale: 1:200@A0  
Date: Nov 16  
Drawing Number: M289-200  
Revision: P2

Scale: Drawn: team

1 - CPFL\ncs\016111\Warrender Primary School - PL07 Rev A  
2 -  
3 -  
4 -

OLD HATCH MANOR