

PLANT SCHEDULES

TOTAL TREES	SIZE (girth)	FORM	SUPPORT	TREEPIT
11	30-35	Clear Stem	Triple	1.5x1.5x0.9m deep
11	4.0-4.5m ht	Multistem	Oblique	1.5x1.5x0.9m deep
6	25-30	Clear Stem	Triple	1.5x1.5x0.9m deep
9	16-18	Feathered	Oblique	1.0x1.0x0.75m deep
9	25-30	Clear Stem	Triple	1.5x1.5x0.9m deep
21	4.0-4.5m ht	Multistem	Oblique	1.5x1.5x0.9m deep
8	18-20	Clear Stem	Triple	1.2x1.2x0.9m deep
3	20-25	Clear Stem	Triple	1.5x1.5x0.9m deep
3	16-18	Clear Stem	Single	1.0x1.0x0.75m deep
3	16-18	Clear Stem	Single	1.0x1.0x0.75m deep
1	40-50	Clear Stem	Triple	1.5x1.5x0.9m deep
4	20-25	Clear Stem	Triple	1.2x1.2x0.9m deep
3	20-25	Clear Stem	Triple	1.2x1.2x0.9m deep
3	35-40	Clear Stem	Triple	1.5x1.5x0.9m deep
3	3.50-4.0m ht	Feathered	Oblique	1.2x1.2x0.9m deep
13	18-20	Clear Stem	Triple	1.2x1.2x0.9m deep
2	16-18	Feathered	Oblique	1.0x1.0x0.75m deep
3	14-16	Feathered	Oblique	1.0x1.0x0.75m deep
5	14-16	Feathered	Oblique	1.0x1.0x0.75m deep
15	20-25	Clear Stem	Triple	1.2x1.2x0.9m deep
11	25-30	Clear Stem	Triple	1.5x1.5x0.9m deep
TOTAL SHRUBS				
43	80-100	10.0	Minimum 5 basal breaks	
40	40-60	10.0		
85	30-40	3.0		
39	30-40	3.0		
136	30-40	3.0		
10	40-60	5.0		
96	40-60	5.0		
42	30-40	3.0		
42	30-40	3.0		
22	80-100	10.0	Minimum 3 basal breaks	
90	60-80	5.0	Minimum 3 basal breaks	
105	60-80	3.0	Minimum 3 basal breaks	
62	60-80	10.0	Bushy	
35	40-60	5.0		
672	30-40	3.0		
75	60-80	5.0		
105	60-80	10.0		
110	40-60	3.0	Hedge plants	
310	30-40	3.0		
118	30-40	3.0		
70	40-60	5.0		
550	60-80	rootballed	Hedge plants	
937	125-150	rootballed	Hedge plants	
107	80-100	10.0	Clump: 40-50cm overall spread	
160	80-100	2.0	Herbaceous	
44	30-40	3.0		
98	30-40	3.0		
433	30-40	3.0		
20	30-40	3.0		
110	40-60	2.0	Minimum 3 basal breaks	
684	40-60	3.0	Minimum 3 basal breaks	
302	40-60	3.0	Minimum 3 basal breaks	
74	60-80	10.0		
1623	30-40	3.0		
152	30-40	3.0		
20	60-80	5.0	Fully furnished with laterals	
3	80-100	10.0	Fully furnished with laterals	
205	40-60	2.0	Fully furnished with laterals	
24	60-80	10.0	Bushy	
95	40-60	5.0		
42	40-60	5.0		
29	-	2.0	Herbaceous	
298	30-40	3.0		
45	30-40	3.0		
70	30-40	3.0		
68	60-80	10.0	Clump: 40-50cm overall spread	
216	30-40	3.0		
80	40-60	5.0	Clump: 30-40cm overall spread	
60	60-80	5.0		
43	40-60	5.0		
104	30-40	3.0		
14	60-80	10.0	Triple Crown	
52	60-80	10.0	Hedge plants/ Self supporting without canes	
67	40-60	5.0		
85	30-40	3.0		
208	30-40	3.0		
147	30-40	3.0		
41	80-100	15.0	Minimum 5 basal breaks	
260	80-100	10.0	Hedge plants	
48	40-60	3.0	Hedge plants	
12	60-80	5.0		
324	-	2.0		
184	-	2.0		
40	-	2.0		
65	30-40	3.0		
33	60-80	5.0		
95	30-40	3.0		
62	60-80	3.0		
212	30-40	3.0		
62	30-40	3.0		
40	30-40	3.0		
84	30-40	3.0		
30	60-80	5.0	Clump: 40-50cm overall spread	
446	30-40	3.0		
41	60-80	5.0		
65	60-80	5.0		
55	60-80	5.0		
70	30-40	3.0		
86	60-80	15.0	Minimum 3 basal breaks	
60	40-60	5.0		
30	40-60	5.0		
78	40-60	3.0	Minimum 3 basal breaks	
120	40-60	3.0		
115	40-60	3.0	Minimum 3 basal breaks	
19	60-80	10.0		
TOTAL TRANSPLANTS				
405	60-80	1+1	All transplants fully furnished with laterals	
375	40-60	1+1		
355	60-80	1+1		
5	40-60	1+1		
390	60-80	1+1		
100	60-80	1+0		
265	60-80	1+1		
155	40-60	1+0		
156	60-80	0/1		
5	60-80	0/1		
40	60-80	1+1		
110	40-60	1+1		
TOTAL BULBS				
480	To be planted in September following project completion			

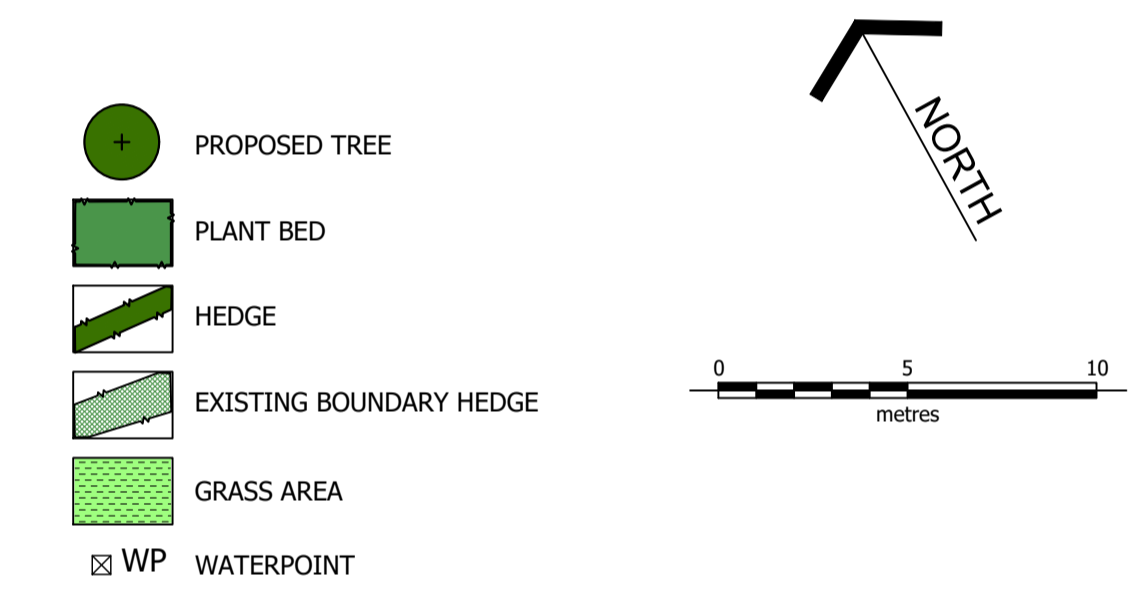

Refer to Drawing: 642.49.02 for the Outline Specification

SEGR0 258 BATH ROAD
 SEGR0 PROPERTIES LTD SLOUGH SL1 4DX
 Tel: 01753 537171

NESTLE HAYES
 PLANTING LAYOUT
 Sheet 3 of 6

Scale 1:200 @ A1 Date JULY 2017
 Drawing 642.39.03 Revision

TALA TERRY ANDERSON LANDSCAPE ARCHITECTS
 54 Kenilworth Avenue, Wimbledon, London SW19 7LW Tel: 020-8947 6859
 info@terryanderson.co.uk