

Type	Count	Type	Count	Type	Count
CANAL STREET	18	POOLING	40	SANDBOX YARD	6
MILK STREET	12	POOLING	40	SANDBOX YARD	6
MILK STREET	71	POOLING	476	VIVEASH YARD	30
MILK STREET	45	POOLING	119	VIVEASH YARD	30
MILK STREET	12	POOLING	3	VIVEASH YARD	30
MILK STREET	35	SANDBOX WALK	128		
MILK STREET	28	SANDBOX WALK	4		
MILK STREET	18	SANDBOX WALK	0		

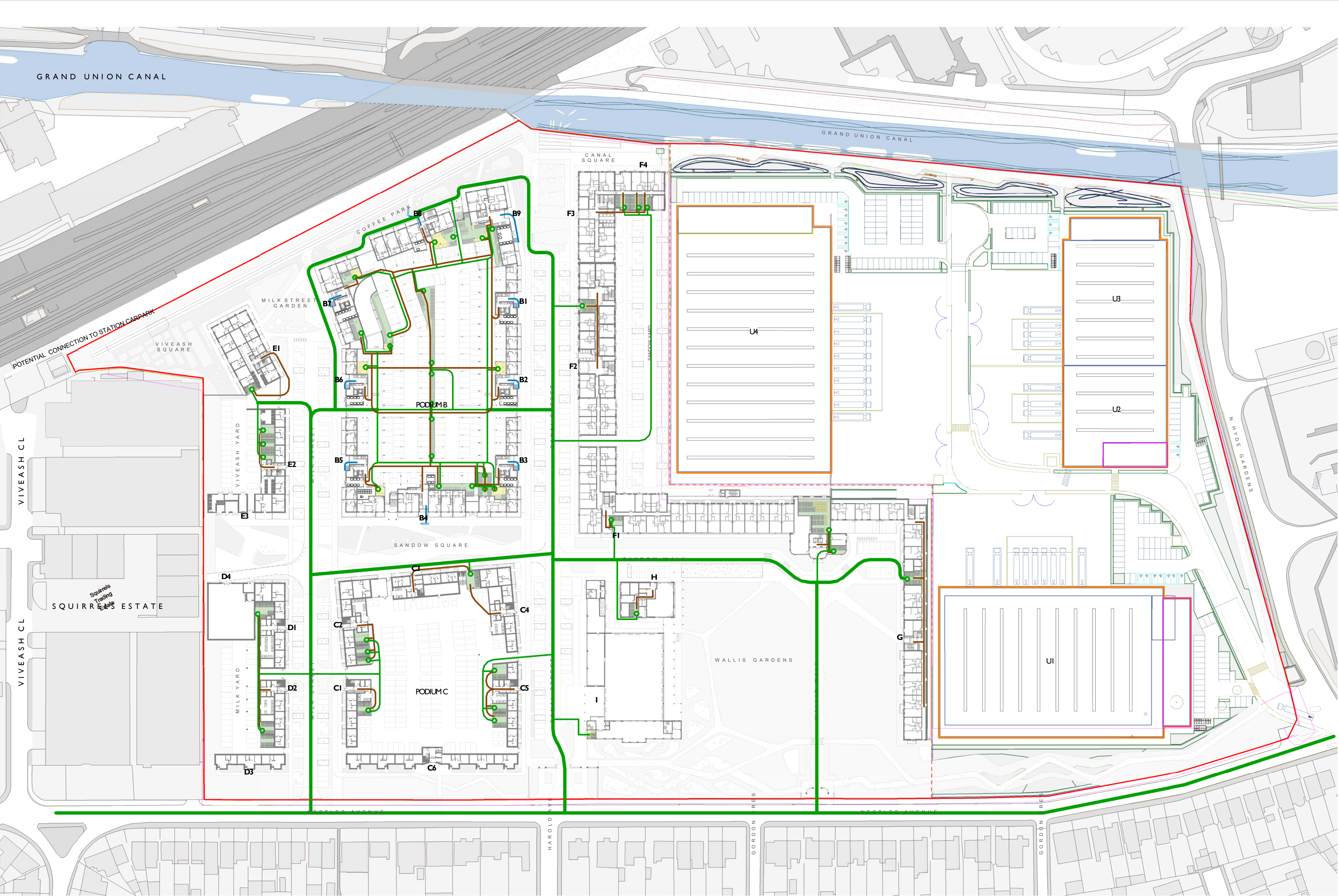

CAR PARKING LAYOUT: DAY ONE - GROUND FLOOR PLAN

CYCLES PARKING LAYOUT - GROUND FLOOR PLAN

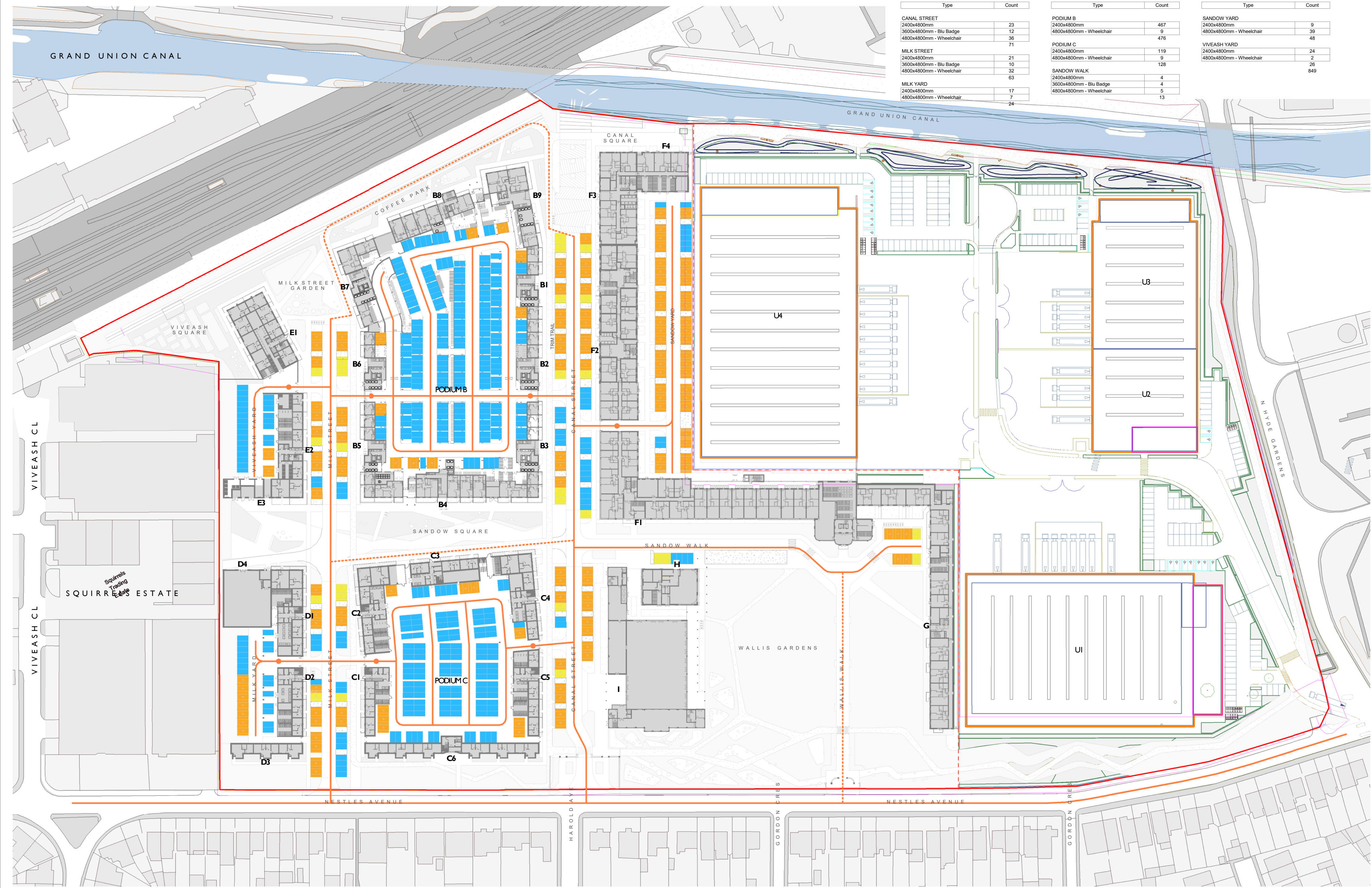

Type	Count	Type	Count	Type	Count
CANAL STREET	29	POOLING	40	SANDBOX YARD	6
MILK STREET	36	POOLING	476	SANDBOX YARD	6
MILK STREET	71	POOLING	119	VIVEASH YARD	30
MILK STREET	23	POOLING	3	VIVEASH YARD	30
MILK STREET	12	SANDBOX WALK	128		
MILK STREET	35	SANDBOX WALK	4		
MILK STREET	18	SANDBOX WALK	0		

CAR PARKING LAYOUT: FUTURE EXPANSION - GROUND FLOOR PLAN

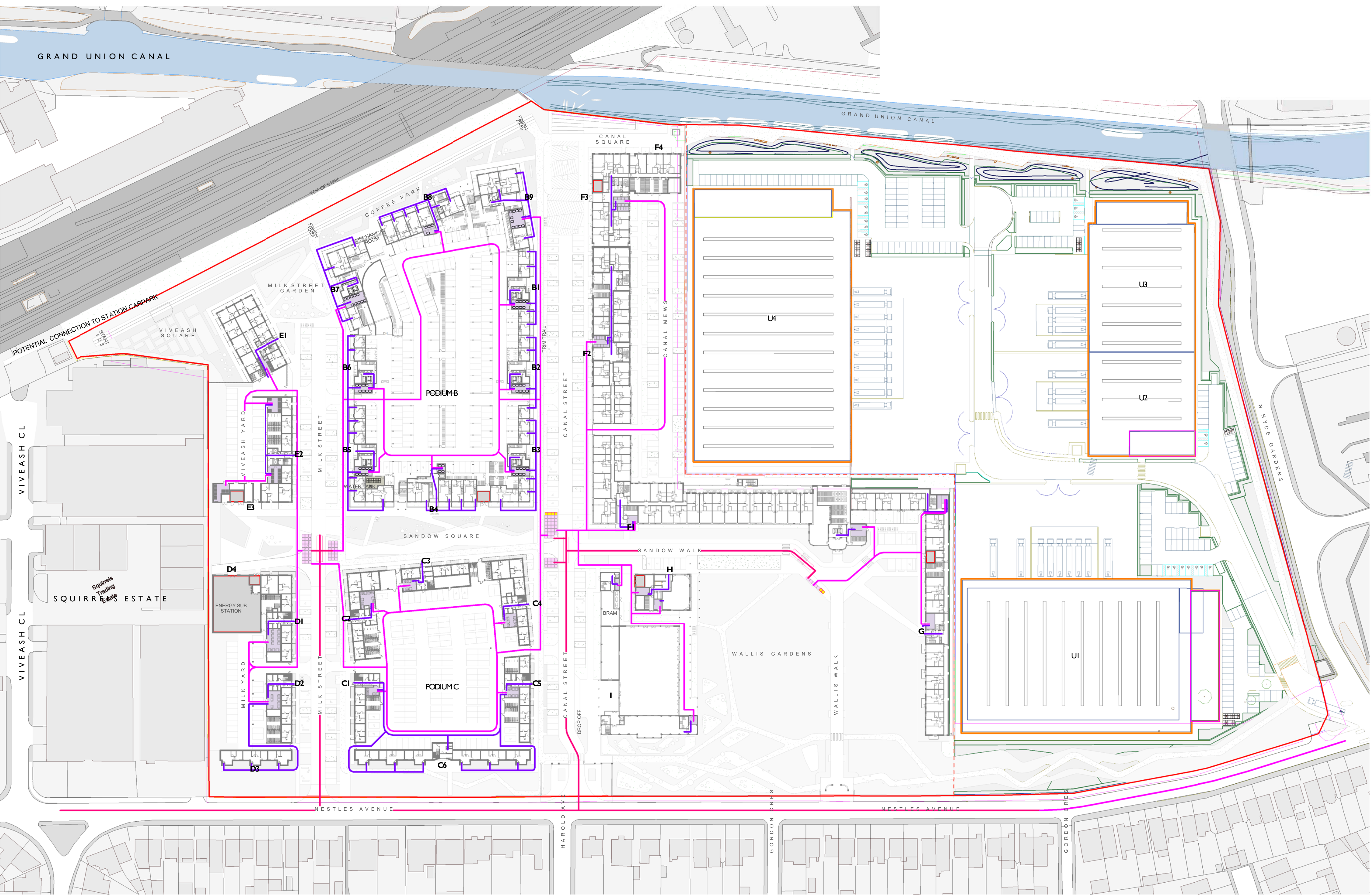

WASTE AND SERVICES LAYOUT - GROUND FLOOR PLAN

**BARRATT LONDON**

**SEGRO**

<b>CAR PARKING LAYOUT</b>	<b>BIKE STORAGE LAYOUT</b>	<b>WASTE STORAGE LAYOUT</b>	<b>OTHER SERVICES</b>
<ul style="list-style-type: none"> <li>STANDARD PARKING</li> <li>ACCESSIBLE PARKING (MAG)</li> <li>CYCLE ROUTES</li> <li>RESIDENT ROUTE TO BIN STORAGE</li> <li>WASTE COLLECTION ROUTES</li> <li>TEMPORARY SERVICES ROUTE</li> <li>VEHICLE ENTRANCE (EAST)</li> </ul>	<ul style="list-style-type: none"> <li>STANDARD CYCLE PARKING ZONE</li> <li>ACCESSIBLE MAG CYCLE PARKING</li> <li>RESIDENT ROUTE TO BIN STORAGE</li> <li>WASTE COLLECTION ROUTES</li> <li>WATER TANK</li> </ul>	<ul style="list-style-type: none"> <li>BIN STORAGE ZONES</li> <li>RESIDENT ROUTE TO BIN STORAGE</li> <li>WASTE COLLECTION TRUCKS</li> <li>REFUSE COLLECTION TRUCKS ROUTES</li> </ul>	<ul style="list-style-type: none"> <li>BIKESHOP</li> <li>ENERGY SUB-STATION</li> <li>MEDIA/CANAL ROOM</li> </ul>

DATE

REV

DESCRIPTION

CHG

**MAKOWER ARCHITECTS**

**FORMER NESTLE FACTORY, HAYES**

**MASTERPLAN - Cycles & Car Parking, Waste and Services**

24-26 Great Suffolk Street  
Bankside, London SE1 1UE

SCALE 1:500 @ A0

**MP 721**

ISSUE **P2**