

TYPICAL SECTION THROUGH PODIUM  
SCALE 1:50

ALUMASC GREEN ROOF WITH BLUROOF INSERT

NOTES:

1. HYDROTECH 6125 WATERPROOFING SYSTEM INCORPORATING FLEXFLASH F POLYESTER REINFORCEMENT.
2. FLEXFLASH UN CURED NEOPRENE RUBBER REINFORCEMENT.
3. BLUROOF PROTECTION SHEET.
4. ALUMASC BLUROOF ALUMINIUM CHAMBER.
5. ALUMASC EXTRUDED POLYSTYRENE THERMAL INSULATION, THICKNESS DETERMINED TO MEET THE U-VALUE AND DEW POINT OF THE STRUCTURE.
6. HARMER AV OUTLET WITH HARMER BLUROOF INSERT, INCORPORATING A CLAMPING RING AND DOMICAL GRATE.
7. BLUROOF VOID FORMER.
8. ALUMASC BLACKDOWN Z5 DRAINAGE LAYER.
9. ALUMASC BLACKDOWN FILTER SHEET, LOOSE LAID OVER THE DRAINAGE LAYER WITH 150MM UNSEALED LAPS.
10. ALUMASC BLACKDOWN SEDUM SUBSTRATE / SEDUM SPECIES.
11. VEGETATION BARRIER FORMED FROM LARGE ROUNDED PEBBLES 16MM - 32MM GRADE, BY OTHERS.
12. HARMER MODULOCK ACCESS COVER WITH ACCESS CHAMBER EXTENSION PIECES.

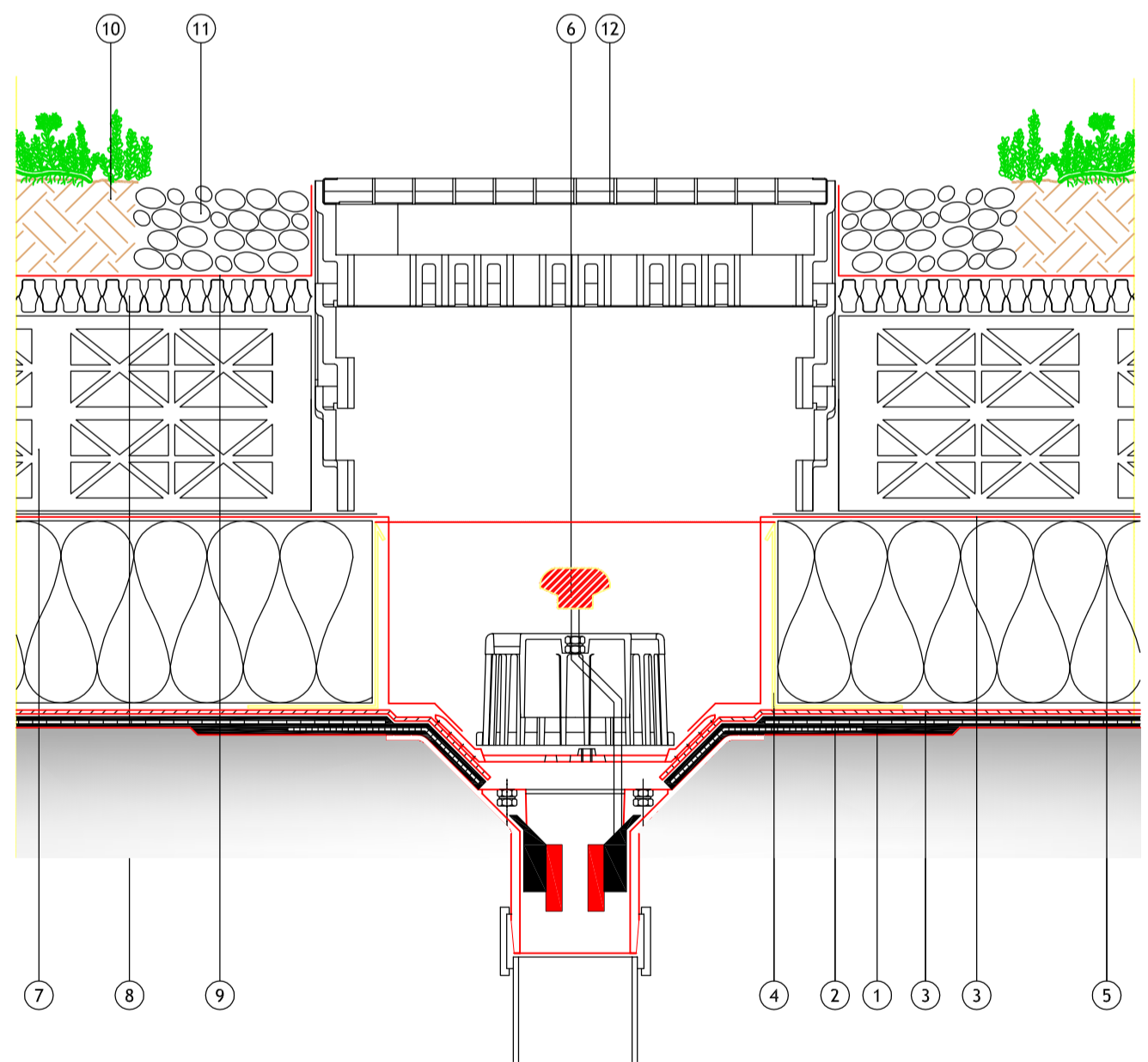

ALUMASC GREEN ROOF WITH BLUROOF INSERT  
NOT TO SCALE

| P1   | 8.08.17 | PRELIMINARY | AB      | JH         |
|--|---------|-------------|---------|------------|
| Rev  | Date    | Description | By      | Ckd        |
| Architect :  |         |             |         |            |
| <b>MAKOWER ARCHITECTS</b>  |         |             |         |            |
| Hydrock Consultants Ltd<br>Hydro Valley Innovation Centre<br>Central Boulevard<br>Salford<br>M9 9SA<br>T +44 (0)121 5060040<br>www.hydrock.com |         |             |         |            |
| Client :   |         |             |         |            |
| <b>BARRATT — LONDON —</b>  |         |             |         |            |
| Project Title:   |         |             |         |            |
| FORMER NESTLÉ SITE<br>HAYES  |         |             |         |            |
| Drawing Title:   |         |             |         |            |
| SECTIONS   |         |             |         |            |
| Drawing Status:  |         |             |         |            |
| <b>PRELIMINARY ISSUE</b>   |         |             |         |            |
| Hydrock Job No:  |         |             |         |            |
| <b>C151867</b>   |         |             |         |            |
| Drawn  | Checked | Scale @ A1  | Date    | Issue Date |
| AB   | JH      | AS SHOWN    | 8.08.17 | 8.08.17    |
| Drawing Number:  |         |             |         | Revision:  |
| <b>C151867/C/109</b>   |         |             |         | <b>P1</b>  |